

Contents

The Quick Guide is not intended as a substitute for your *Owner's Manual*. We strongly encourage you to review the *Owner's Manual* and supplementary manuals so you will have a better understanding of your vehicle's capabilities and limitations.

Audio System	
Audio control screen.....	66
Side Display (vehicles with a navigation system).....	66
Remote control (steering wheel switches).....	66
Basic operation.....	67
Radio.....	67
DVD player/CD player.....	68
Operating an iPod.....	69
Rear seat audio controls.....	69
Automatic Transmission.....	20
BSM (Blind Spot Monitor).....	41
Cruise Control.....	35
Door Locks.....	87
Driving Mode Select Switch.....	44
Driving Position Memory.....	15
Dynamic Radar Cruise Control.....	37
Eco Driving Indicator.....	28
Engine (Ignition) Switch.....	17
Floor mat installation.....	9
Front Air Conditioning System	
Side Display (vehicles with a navigation system).....	71
Using the automatic mode.....	72
Adjusting the temperature.....	72
Using the S-FLOW mode.....	72
Front Seats.....	14
Fuel Tank Cap.....	91
Garage Door Opener.....	80
Hands-free System For Cellular Phone	
Bluetooth® phone pairing.....	59
Phonebook transfer.....	60
Registering a speed dial.....	61
Calling by name.....	62
Calling by speed dial.....	63
Calling using SMS/MMS message.....	64
Receiving a call.....	65
Steering switches.....	65

Headlights	29
Head-up Display.....	27
Intuitive Parking Assist	40
Keys.....	10
Lexus Enform with Safety Connect.....	84
Lexus Night View	46
LKA (Lane-Keeping Assist).....	42
Moon Roof.....	90
Multi-information Display	25
Navigation System	
Register home	53
Destination input - Search by address	54
Destination input - Search points of interest by name.....	56
Destination input - Search points of interest by category.....	57
Destination input - Search points of interest by telephone number	58
Parking Brake.....	24
Portable Audio Device Ports.....	80
Power Windows.....	89
Rear Air Conditioning System	
Front controller	73
Remote Touch.....	49
Safety Connect	82
Seat Heaters/Seat Ventilators.....	74
Smart Access System with Push-button Start.....	11
Theft Deterrent System	13
Tire Pressure Warning System	48
Trunk	92
Turn Signal Lever	23
Voice Command System	
Basic operation	76
Command list	77
Windshield Wipers and Washer	31
XM Services.....	86

Overview

Instrument Panel

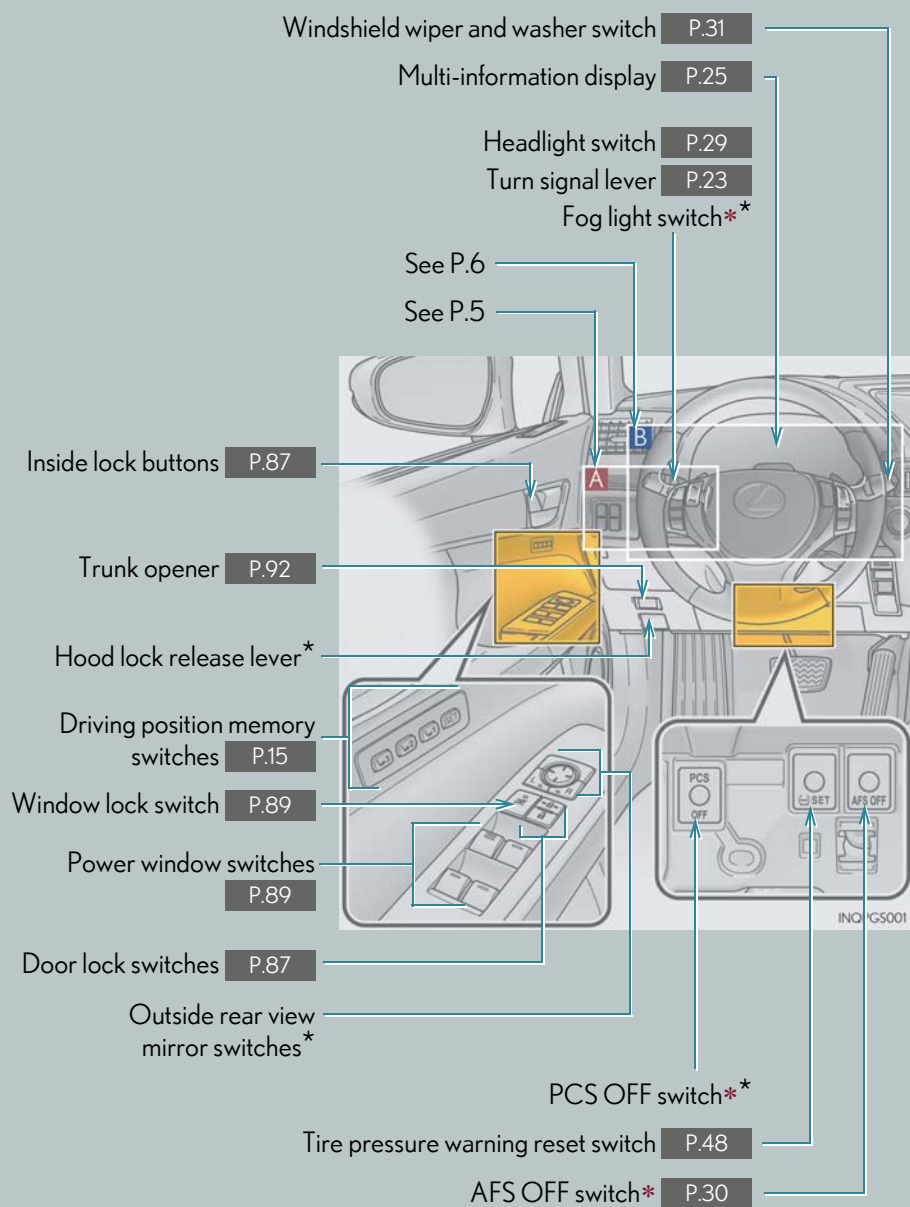

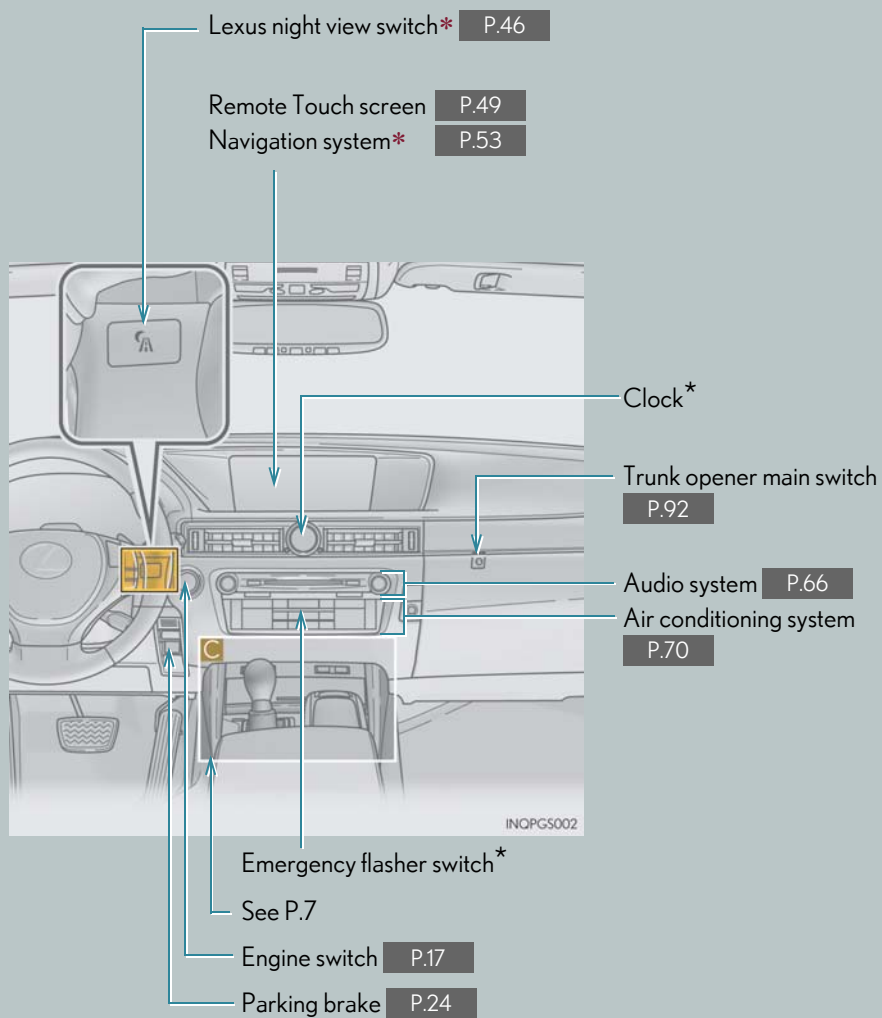

*: If equipped
*: Refer to "Owner's Manual".

Overview

Instrument Panel

A

Odometer/trip meter and trip meter reset button*

Instrument panel light control switches*

Headlight cleaner switch**

VSC OFF switch*

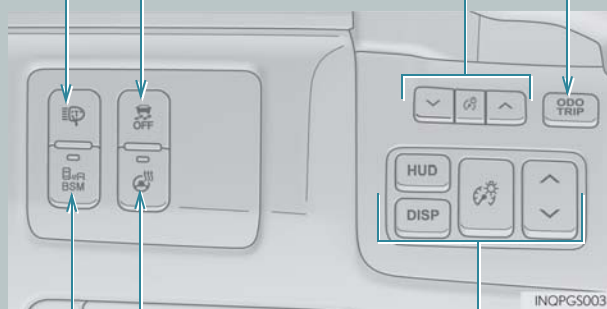

HUD (Head-up display) switches* P.27

Heated steering wheel switch**

BSM (Blind Spot Monitor) main switch* P.41

B

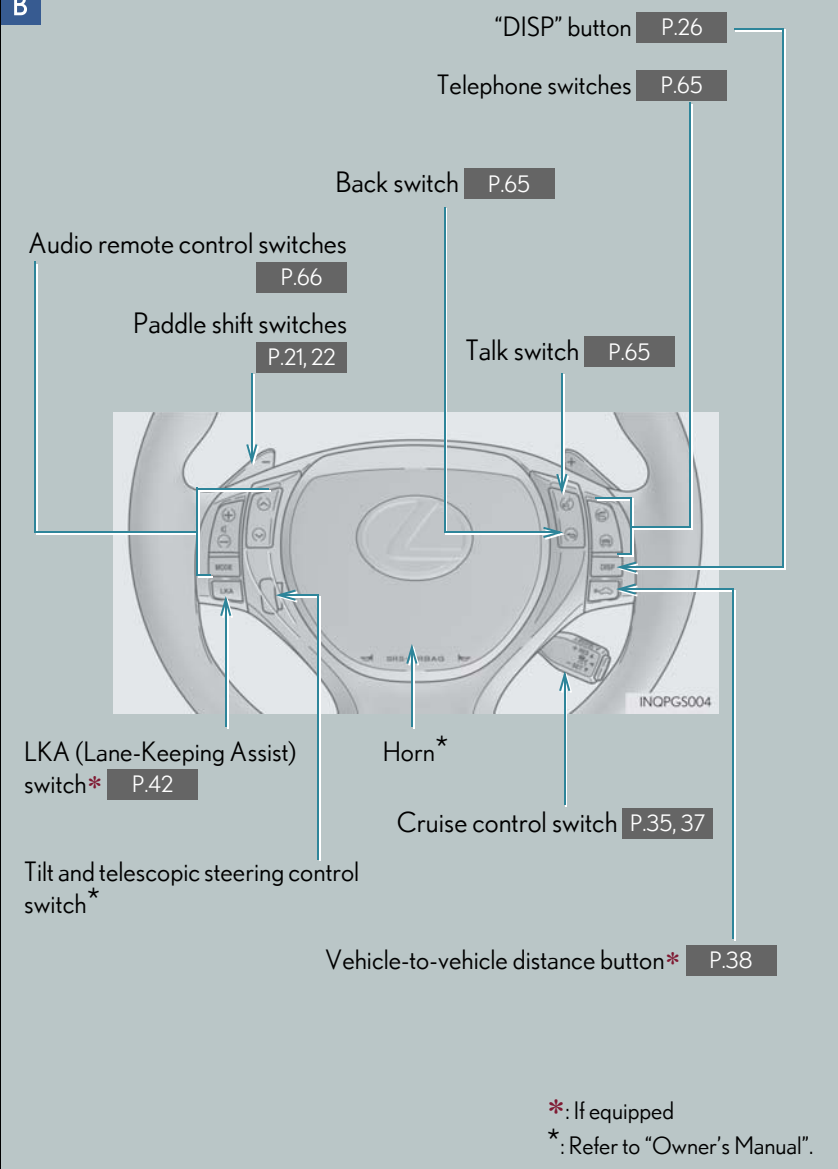

Overview

Instrument Panel

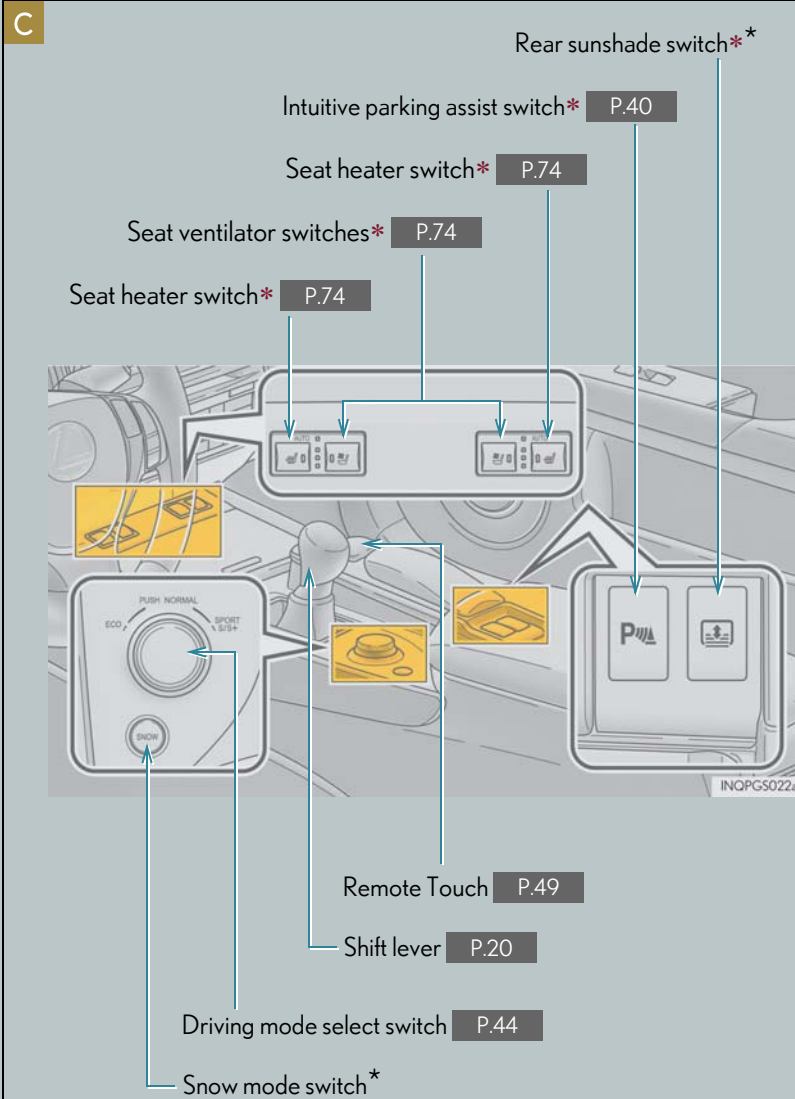

Overview

Roof

Interior light*

Moon roof switches
P.90

Vanity lights*

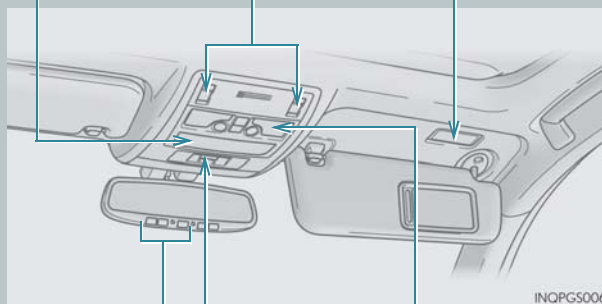

Personal lights*

"SOS" button* P.82

Garage door opener switches P.80

*: If equipped

*: Refer to "Owner's Manual".

Floor mat installation

Use only floor mats designed specifically for vehicles of the same model and model year as your vehicle. Fix them securely in place onto the carpet.

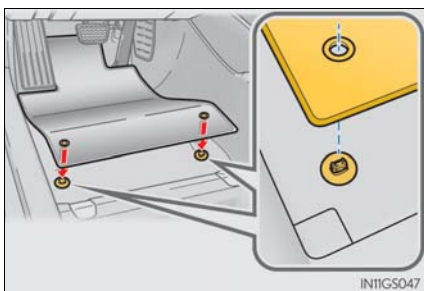

- 1** Insert the retaining hooks (clips) into the floor mat eyelets.

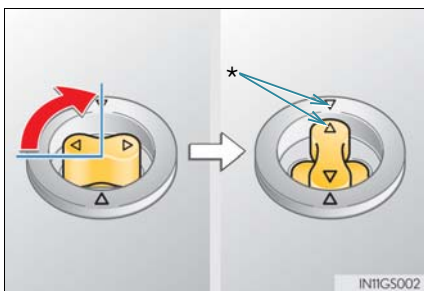

- 2** Turn the upper knob of each retaining hook (clip) to secure the floor mats in place.

*: Always align the \triangle marks.

The shape of the retaining hooks (clips) may differ from that shown in the illustration.

Keys

■ Electronic key

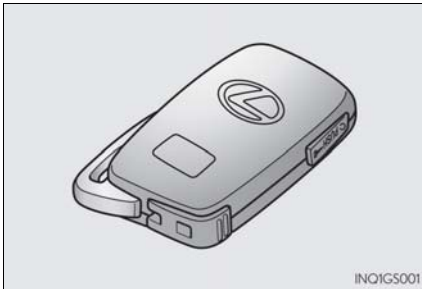

Smart access system with push-button start
(→P.11)

Wireless remote control (→P.11)

■ Mechanical key

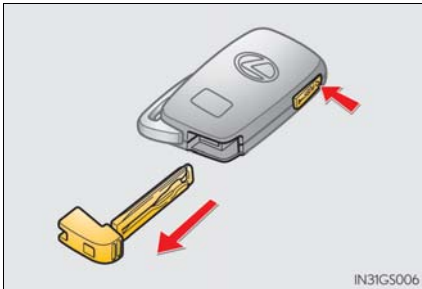

To take out the mechanical key, push the release button and take the key out.

Carry the mechanical key together with the electronic key. If the electronic key battery is depleted or the entry function does not operate properly, you will need the mechanical key.

■ Wireless remote control

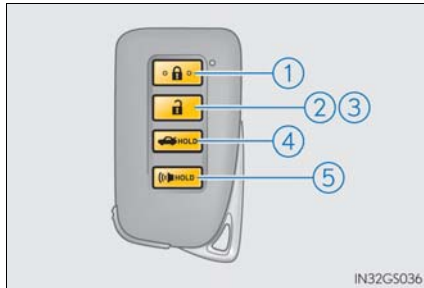

- ① Locks all the doors
- ② Unlocks all the doors
Pressing the button unlocks the driver's door. Pressing the button again within 5 seconds unlocks the other doors.
- ③ Opens the windows and moon roof (press and hold)*
- ④ Opens the trunk (press and hold)
If the vehicle is equipped with a power trunk opener and closer, the trunk lid automatically opens fully.
- ⑤ Sounds the alarm (press and hold)

*: This setting must be customized at your Lexus dealer.

■ Smart Access System with Push-button Start

The following operations can be performed simply by carrying the electronic key on your person, for example in your pocket. (The driver should always carry the electronic key.)
For details on starting the engine, see page 17.

■ Entering the vehicle

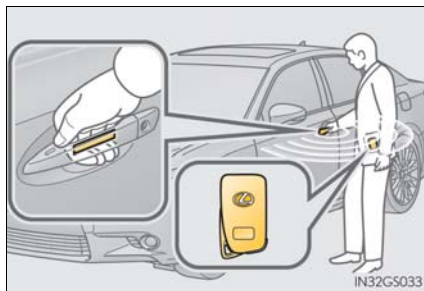

Grip the driver's door handle to unlock the door. Grip the passenger's door handle to unlock all the doors.

Make sure to touch the sensor on the back of the handle.

The doors cannot be unlocked for 3 seconds after the doors are locked.

■ Exiting the vehicle

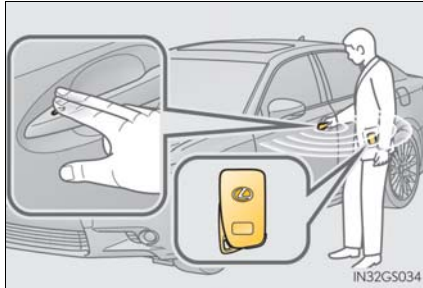

Touch the lock sensor (the indentation on the upper part of the door handle) to lock all the doors.

■ Opening the trunk

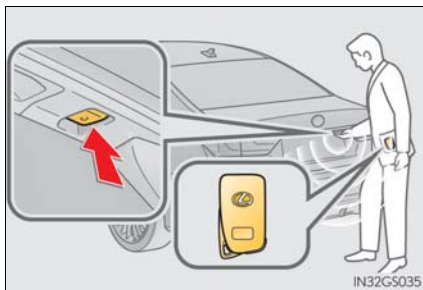

Press the button.

If the vehicle is equipped with power trunk opener and closer, the trunk lid automatically opens fully.

For details on what to do when the electronic key does not operate properly, see page 97.

Theft Deterrent System

■ Engine immobilizer system

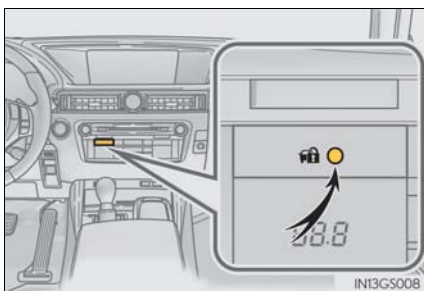

The indicator light flashes after the engine switch has been turned off to indicate that the system is operating.

The indicator light stops flashing after the engine switch has been turned to ACCESSORY or IGNITION ON mode to indicate that the system has been canceled.

■ Alarm

The alarm uses light and sound to give an alert when an intrusion is detected.

To set the alarm:

Close the doors, trunk and hood, and lock all the doors. The system will be set automatically after 30 seconds.

The indicator light changes from being on to flashing when the system is set.

To deactivate or stop the alarm:

- Unlock the doors or open the trunk.
- Turn the engine switch to ACCESSORY or IGNITION ON mode, or start the engine.
(The alarm will be deactivated or stopped after a few seconds.)

Front Seats

■ Adjustment procedure

► Type A

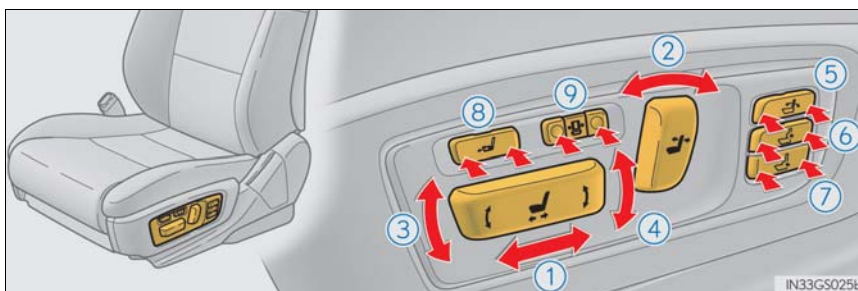

► Type B

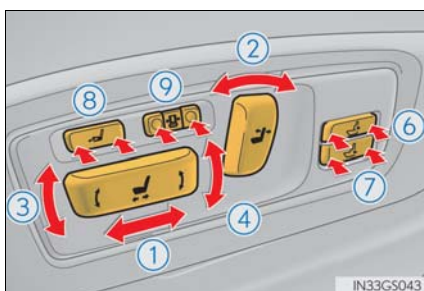

► Type C

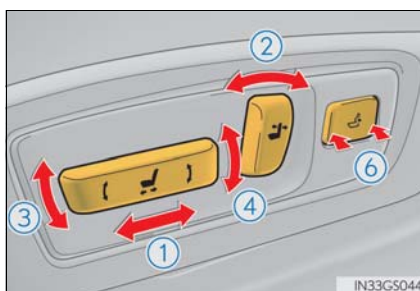

- | | |
|--|---|
| ① Seat position adjustment switch | ⑥ Lumbar support adjustment switch |
| ② Seatback angle adjustment switch | ⑦ Pelvic support adjustment switch (if equipped) |
| ③ Seat cushion (front) angle adjustment switch | ⑧ Seat cushion length adjustment switch (if equipped) |
| ④ Vertical height adjustment switch | ⑨ Seatback side support adjustment switch (if equipped) |
| ⑤ Seatback upper angle adjustment switch (if equipped) | |

Driving Position Memory

This feature automatically adjusts the front seats, steering wheel and outside rear view mirrors to suit your preferences.

Driving position memory

Recording procedure

- 1 Check that the shift lever is in P.
- 2 Turn the engine switch to IGNITION ON mode.
- 3 Adjust the driver's seat, steering wheel, and outside rear view mirrors to the desired positions.

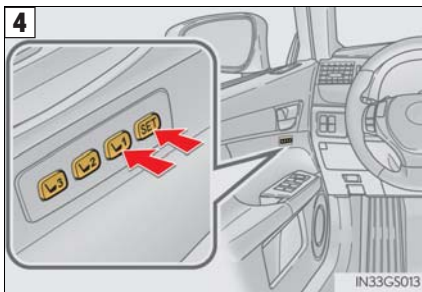

While pressing the "SET" button, or within 3 seconds after the "SET" button is pressed, press button "1", "2" or "3" until the buzzer sounds.

If the selected button has already been preset, the previously recorded position will be overwritten.

Recall procedure

- 1 Check that the shift lever is in P.
- 2 Turn the engine switch to IGNITION ON mode.

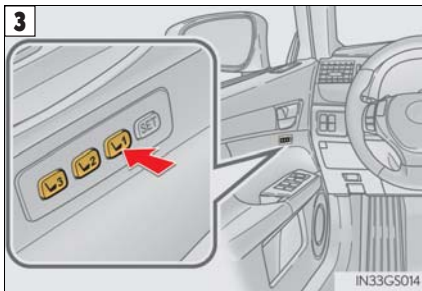

Press one of the buttons for the driving position you want to recall until the buzzer sounds.

■ Memory recall function (driver's side only)

Each electronic key can be registered to recall your preferred driving position.

■ Registering procedure

- 1 Check that the shift lever is in P.
- 2 Turn the engine switch to IGNITION ON mode.
- 3 Recall the driving position that you want to record.

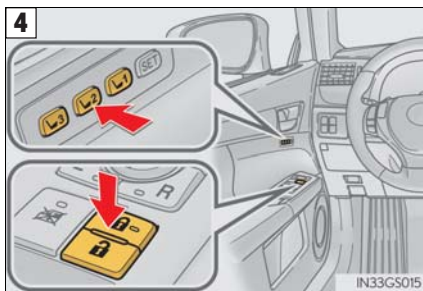

While pressing the recalled button, press and hold the door lock switch (either lock or unlock) until the buzzer sounds.

If the button could not be registered, the buzzer sounds continuously for approximately 3 seconds.

Engine (Ignition) Switch

Performing the following operations when carrying the electronic key on your person starts the engine or changes engine switch modes.

Starting the engine

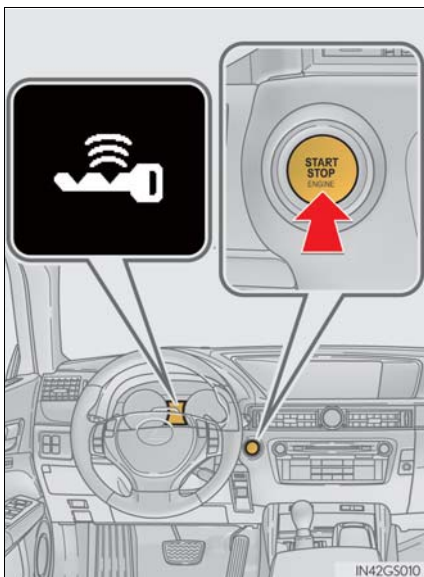

- 1 Check that the parking brake is set.
- 2 Check that the shift lever is set in P.
- 3 Firmly depress the brake pedal.



will be displayed on the multi-information display. If it is not displayed, the engine cannot be started.

- 4 Press the engine switch.
The engine will crank until it starts or for up to 30 seconds, whichever is less. Continue depressing the brake pedal until the engine is completely started. The engine can be started from any engine switch mode.

■ Stopping the engine

- 1 Stop the vehicle.
- 2 Shift the shift lever to P.
- 3 Set the parking brake.
- 4 Press the engine switch.
- 5 Release the brake pedal and check that "POWER ON" on the multi-information display is off.

■ Changing engine switch modes

Modes can be changed by pressing the engine switch with the brake pedal released. (The mode changes each time the switch is pressed.)

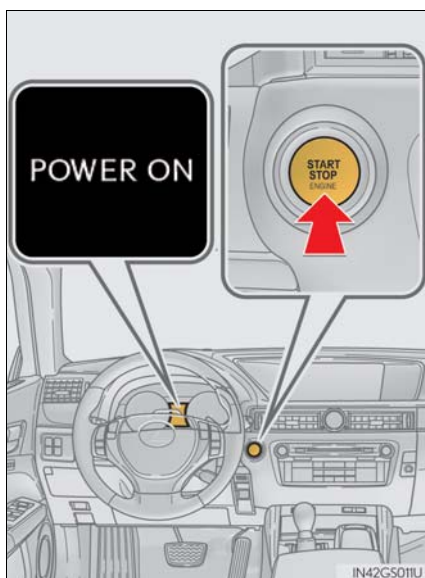

Off*

The emergency flashers can be used.
The multi-information display will not be displayed.

ACCESSORY mode

Some electrical components such as the audio system can be used.
"POWER ON" will be displayed on the multi-information display.

IGNITION ON mode

All electrical components can be used.
"POWER ON" will be displayed on the multi-information display.

*: If the shift lever is in a position other than P when turning off the engine, the engine switch will be turned to ACCESSORY mode, not to off.

■ If your vehicle has to be stopped in an emergency

Only in an emergency, such as if it becomes impossible to stop the vehicle in the normal way, stop the vehicle using the following procedure:

- 1** Steadily step on the brake pedal with both feet and firmly depress it.
Do not pump the brake pedal repeatedly as this will increase the effort required to slow the vehicle.
- 2** Shift the shift lever to N.
► If the shift lever is shifted to N
- 3** After slowing down, stop the vehicle in a safe place by the road.
- 4** Stop the engine.
► If the shift lever cannot be shifted to N
- 3** Keep depressing the brake pedal with both feet to reduce vehicle speed as much as possible.

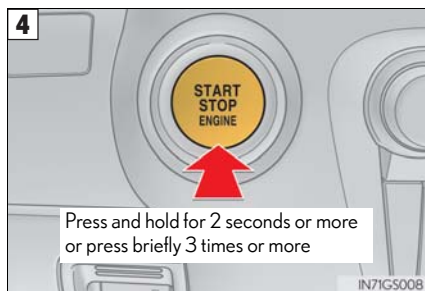

To stop the engine, press and hold the engine switch for 2 consecutive seconds or more, or press it briefly 3 times or more in succession.

- 5** Stop the vehicle in a safe place by the road.

Automatic Transmission

Shifting the shift lever

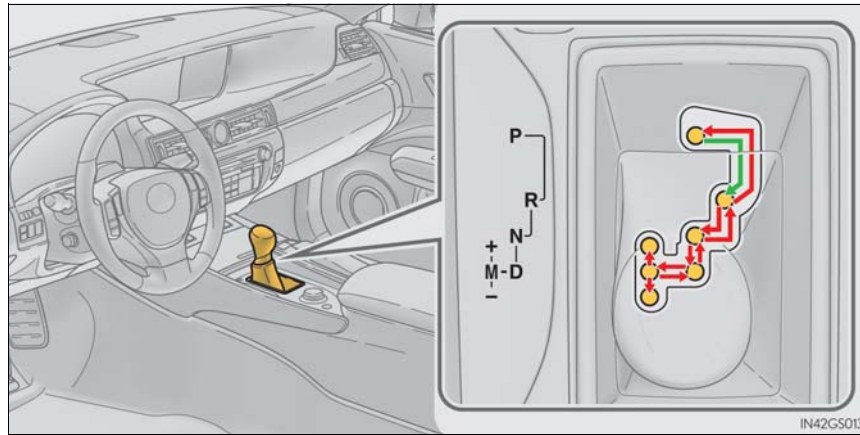

While the engine switch is in IGNITION ON mode, move the shift lever with the brake pedal depressed.

When shifting the shift lever between P and D, make sure that the vehicle is completely stopped.

■ Shift position purpose

Shift position	Objective or function
P	Parking the vehicle/starting the engine
R	Reversing
N	Neutral (Condition in which the power is not transmitted)
D	Normal driving ^{*1}
M	M mode driving ^{*2}

^{*1}: To improve fuel efficiency and reduce noises, set the shift lever in the D position for normal driving.

^{*2}: Any gear range can be fixed when driving in M mode.

■ Selecting shift ranges in the D position

To drive using temporary shift range selection, operate the “-” or “+” paddle shift switch. Changing the shift range allows restriction of the highest gear, preventing unnecessary upshifting and enabling the level of engine braking force to be selected.

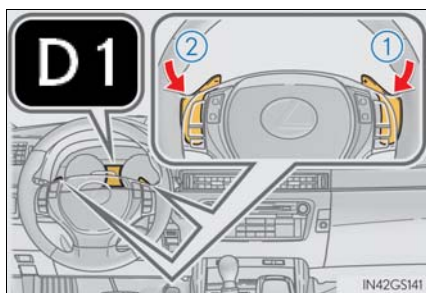

① Upshifting

② Downshifting

6-speed models:

The selected shift range, from D1 to D6, will be displayed in the meter.

8-speed models:

The selected shift range, from D1 to D8, will be displayed in the meter.

To return to normal D position driving, the “+” paddle shift switch must be held down for a period of time.

■ Selecting gears in the M position

To enter M mode, shift the shift lever to M. Gears can then be selected by operating the shift lever or paddle shift switches, allowing you to drive in the gear of your choosing.

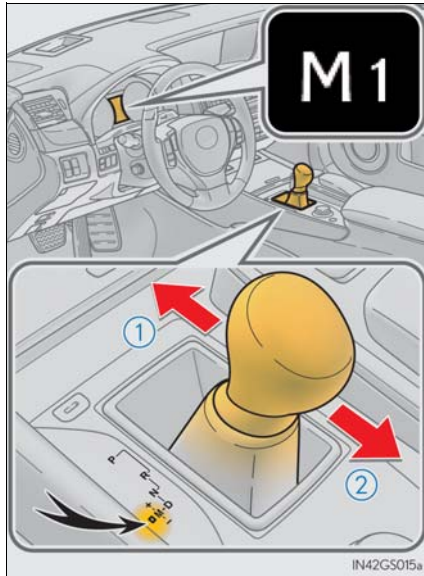

① Upshifting

② Downshifting

6-speed models:

The gear changes once every time the shift lever or paddle shift switch is operated.

The selected gear, from M1 to M6, will be fixed and displayed in the meter.

8-speed models:

The selected gear, from M1 to M8, will be fixed and displayed in the meter.

When in the M position, the gear will not change unless the shift lever or paddle shift switches are operated. However, even when in the M position, the gears will be automatically changed in the following situation:

- When vehicle speed drops (downshift only).
- When the automatic transmission fluid or engine coolant temperature is low.
- When automatic transmission fluid temperature is high.
- When the needle of the tachometer is in the red zone (the range which exceeds the allowable revs of the engine).

In the following situations, the gear will not shift even if the shift lever or paddle shift switches are operated.

- "1st Gear not available due to slippery road surface" is displayed on the multi information display.
- The vehicle speed is low (upshift only).

Turn Signal Lever

The lever will return to its original position immediately after operation.

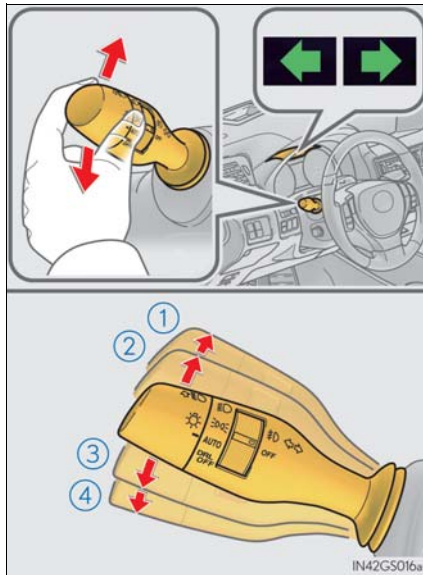

- ① Right turn
- ② Lane change to the right (move the lever partway and release it)
The right hand signals will flash 3 times.
- ③ Lane change to the left (move the lever partway and release it)
The left hand signals will flash 3 times.
- ④ Left turn

■ If the turn signals do not stop flashing after turning left or right, or if you want to stop them flashing

Operate the lever in the opposite direction to either position ② or ③. If you move the lever to either position ① or ④, the selected turn signals will flash.

■ Customization

The number of times the turn signals flash during a lane change can be changed.

Parking Brake

Manual mode

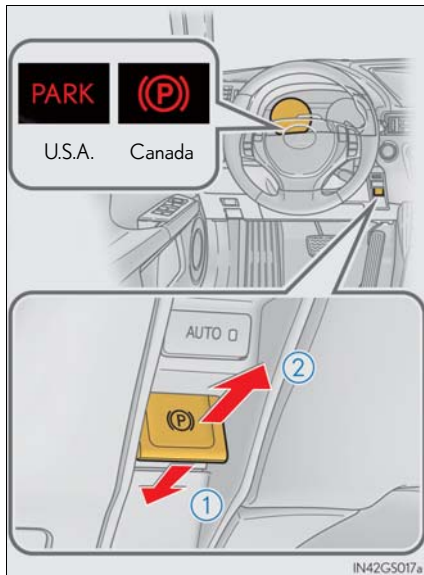

- ① Sets the parking brake
- ② Releases the parking brake
Operate the parking brake switch while depressing the brake pedal. Make sure that the parking brake indicator light goes off.

Automatic mode

The parking brake is set or released automatically according to shift lever operation.



Turns automatic mode on/off

- When the shift lever is moved out of P, the parking brake will be released.
- When the shift lever is moved into P, the parking brake will be set.
Operate the shift lever with the brake pedal depressed.

Multi-information Display

The multi-information display presents the driver with a variety of driving-related data including the current outside air temperature.

■ Display contents

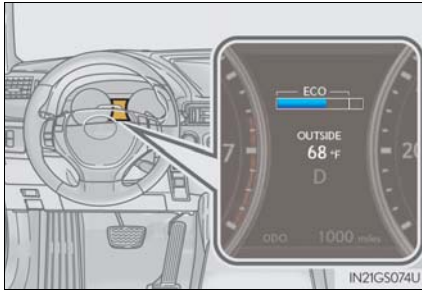

- Trip information
 - Eco Driving Indicator
 - Outside temperature
 - Current fuel consumption
 - Average fuel consumption after refueling
 - Average fuel consumption
 - Average vehicle speed
 - Driving range
 - Tire inflation pressure (if equipped) (→P.48)
 - Drive monitor
 - Outside temperature
 - Average fuel consumption after refueling
 - Driving range
 - Intuitive parking assist display* (if equipped)
 - Dynamic radar cruise control display* (if equipped)
Dynamic radar cruise control with full-speed range* (if equipped)
 - LKA (Lane-Keeping Assist) display* (if equipped)
 - Warning messages
- *: Automatically displayed when the system is used. Display can be switched by pressing the "DISP" button.

■ Switching the display of trip information

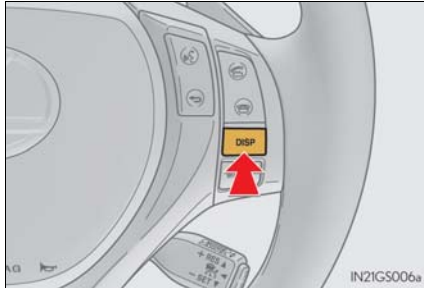

Items displayed can be switched by pressing the “DISP” button.

If a problem is detected in any of the vehicle’s systems, a warning message is shown on the multi-information display.

Head-up Display (if equipped)

The head-up display can be used to project vehicle speed and other information onto the windshield.

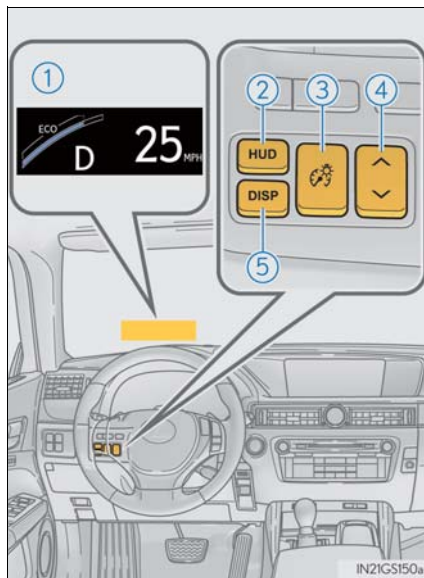

- ① Head-up display
- ② "HUD" button
- ③ Display brightness adjustment switch
- ④ Display position adjustment switch
- ⑤ "DISP" button

Head-up display contents

- Vehicle speed
- Tachometer
- Shift position and shift range
- Eco Driving Indicator
- Audio display
- Route guidance display (vehicles with navigation system)
- Lane departure warning display (LKA [Lane-Keeping Assist]) (if equipped)
- Approach warning display (dynamic radar cruise control, dynamic radar cruise control with full-speed range) (if equipped)
- Pre-collision braking warning message (pre-collision system) (if equipped)

Eco Driving Indicator

Eco Driving Indicator Zone Display

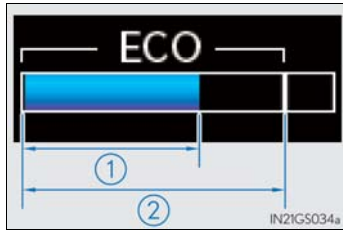

- ① Eco driving ratio based on acceleration
If the acceleration exceeds Zone of Eco driving, the right side of Eco Driving Indicator Zone Display blinks.
- ② Zone of Eco driving

Eco Driving Indicator will not operate in the following conditions:

- The shift lever is anything other than D.
- Paddle shift switch is operated.
- Neither normal mode nor Eco drive mode is selected.
- The vehicle speed is approximately 80 mph (130 km/h) or higher.

Headlights

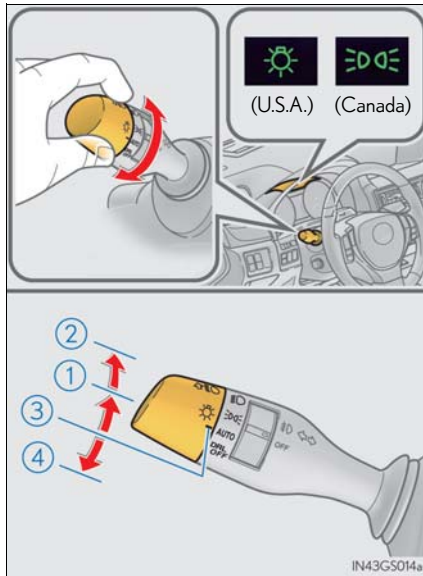

- ① The side marker, parking, tail, license plate and instrument panel lights turn on.
- ② The headlights and all the lights listed above turn on.
- ③ **AUTO** The headlights, daytime running lights and all the lights listed above turn on and off automatically. (When the engine switch is in IGNITION ON mode.)
- ④ **DRL OFF** Off
(U.S.A.)
○ The daytime running lights turn (Canada) on.

Turning on the high beam headlights

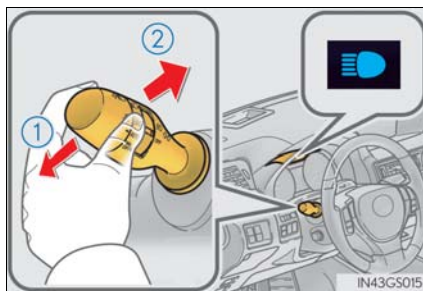

- ① With the headlights on, push the lever away from you to turn on the high beams. Pull the lever toward you to the center position to turn the high beams off.
- ② Pull the lever toward you and release it to flash the high beams once. You can flash the high beams with the headlights on or off.

■ AFS (Adaptive Front-lighting System) (if equipped)

AFS (Adaptive Front-lighting System) secures excellent visibility at intersections and on curves by automatically adjusting the direction of the light axis of the headlights according to vehicle speed and the degree of the tire's angle as controlled by steering input.



Turns the AFS on/off

The indicator turns on when the AFS is deactivated.



Windshield Wipers and Washer

The lever will return to its original position immediately after operation.



Intermittent wipers with interval adjuster

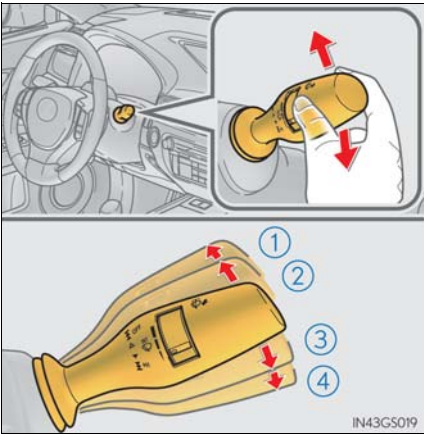

- ①

⬆ OFF (U.S.A.) or ○ (Canada)

Move the lever up 2 levels
- ②

⬆

Move the lever up 1 level
- ③

⬇ (U.S.A.) or ▾ (Canada)

Move the lever down 1 level
- ④

⬇ HI (U.S.A.) or ▾ (Canada)

Move the lever down 2 levels

Operation Status before operation	⬆ OFF or ○	⬆	⬇ or ▾	⬇ HI or ▾
Off	Temporary operation	Temporary operation	Intermittent operation	High speed operation
Intermittent operation	Off	Off	Low speed operation	High speed operation
Low speed operation	Off	Intermittent operation	High speed operation	High speed operation
High speed operation	Off	Low speed operation	No change	No change

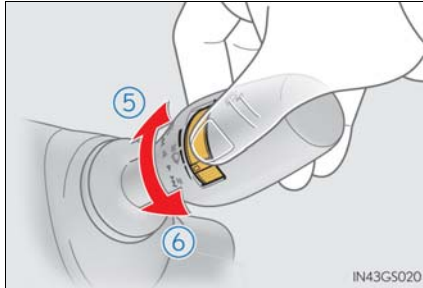

Wiper intervals can be adjusted when intermittent operation is selected.

- ⑤ Increases the intermittent windshield wiper frequency
- ⑥ Decreases the intermittent windshield wiper frequency

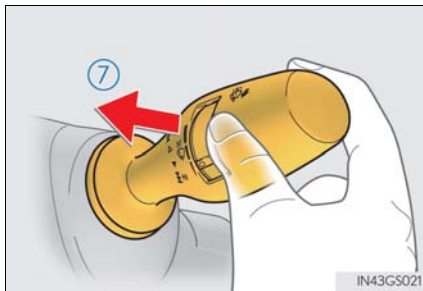

- ⑦ Washer/wiper dual operation
Wipers will automatically operate a couple of times after the washer squirts.

■ Rain-sensing windshield wipers

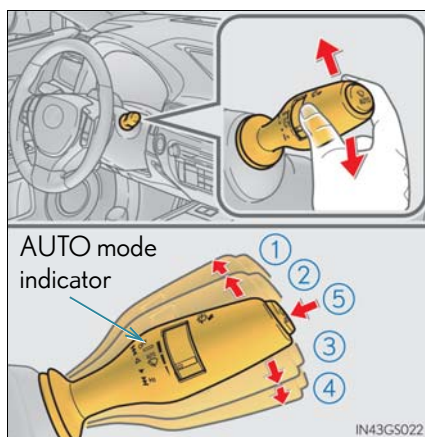

- ① OFF (U.S.A.) or (Canada)
Move the lever up 2 levels
- ② Move the lever up 1 level
- ③ (U.S.A.) or (Canada)
Move the lever down 1 level
- ④ HI (U.S.A.) or (Canada)
Move the lever down 2 levels
- ⑤ AUTO AUTO mode on/off switch

With AUTO mode selected, the wipers will operate automatically when the sensor detects falling rain. The system automatically adjusts wiper timing in accordance with rain volume and vehicle speed.

AUTO mode indicator will turn on when AUTO mode is selected.

Operation Status before operation		OFF or		or	HI or
Off		Temporary operation	Temporary operation	Low speed operation	High speed operation
Low speed operation		Off	Off	High speed operation	High speed operation
High speed operation		Off	Low speed operation	No change	No change
AUTO mode	Intermittent operation	Off	Temporary operation ^{*1}	Low speed operation ^{*2}	High speed operation ^{*2}
	Continuously		No change		

^{*1}: After temporary operation, the mode will return to AUTO mode.

^{*2}: AUTO mode will be canceled.



When AUTO mode is selected, the sensor sensitivity can be adjusted by turning the switch ring.

⑥ Increases the sensitivity

⑦ Decreases the sensitivity

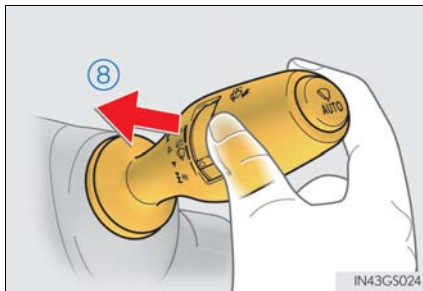

⑧ Washer/wiper dual operation

Wipers will automatically operate a couple of times after the washer squirts.

Cruise Control (if equipped)

Use the cruise control to maintain a set speed without depressing the accelerator pedal.

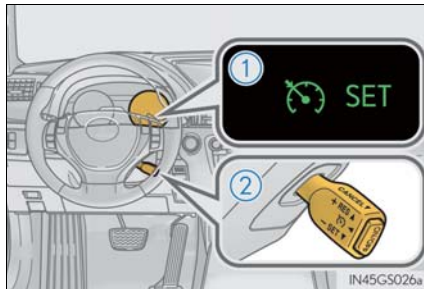

- ① Indicators
- ② Cruise control switch

Setting the vehicle speed

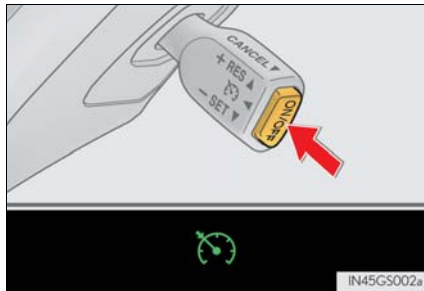

- 1 Press the "ON/OFF" button to activate the cruise control.
Cruise control indicator will come on.
Press the button again to deactivate the cruise control.

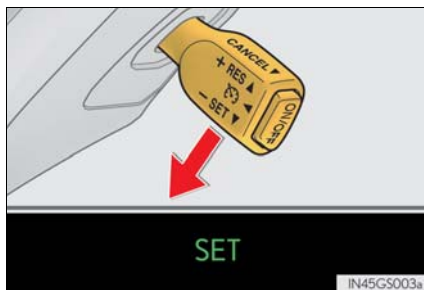

- 2 Accelerate or decelerate the vehicle to the desired speed, and push the lever down to set the speed.
"SET" indicator will come on.
The vehicle speed at the moment the lever is released becomes the set speed.

■ Adjusting the set speed

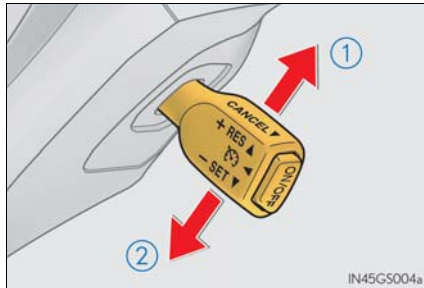

- ① Increases the speed
 - ② Decreases the speed
- Fine adjustment: Momentarily move the lever in the desired direction.
Large adjustment: Hold the lever in the desired direction.

■ Canceling and resuming the constant speed control

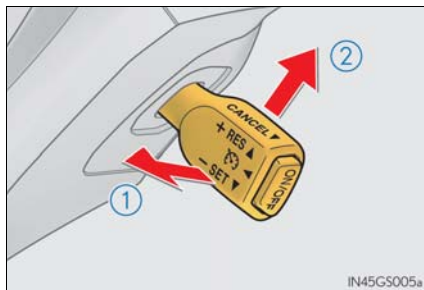

- ① Pulling the lever toward you cancels the constant speed control. The speed setting is also canceled when the brakes are applied.
- ② Pushing the lever up resumes the constant speed control. Resuming is available when the vehicle speed is more than approximately 25 mph (40 km/h).

Dynamic Radar Cruise Control (if equipped)

Dynamic radar cruise control supplements conventional cruise control with a vehicle-to-vehicle distance control. In vehicle-to-vehicle distance control mode, the vehicle automatically accelerates or decelerates in order to maintain a set following distance from vehicles ahead.

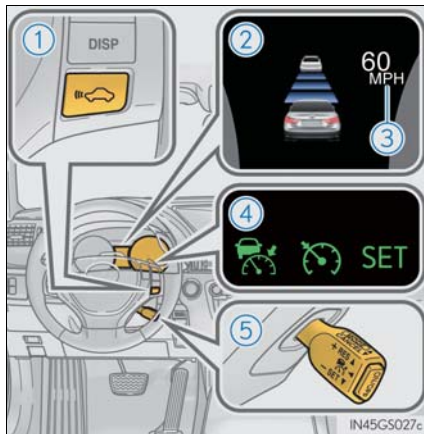

- ① Vehicle-to-vehicle distance button
- ② Display
- ③ Set speed
- ④ Indicators
- ⑤ Cruise control switch

Setting the vehicle speed (vehicle-to-vehicle distance control mode)

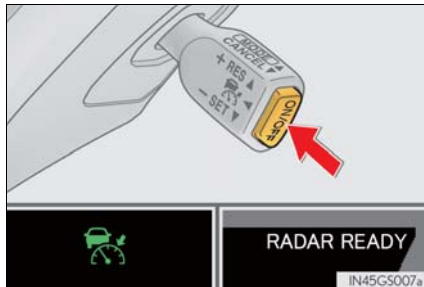

- 1 Press the "ON/OFF" button to activate the cruise control.
Radar cruise control indicator will come on.
Press the button again to deactivate the cruise control.

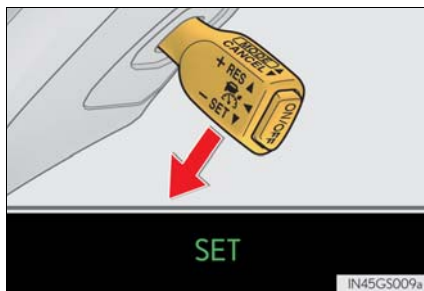

- 2 Accelerate or decelerate the vehicle to the desired speed, and push the lever down to set the speed.
"SET" indicator will be displayed.
The vehicle speed at the moment the lever is released becomes the set speed.

■ Adjusting the set speed

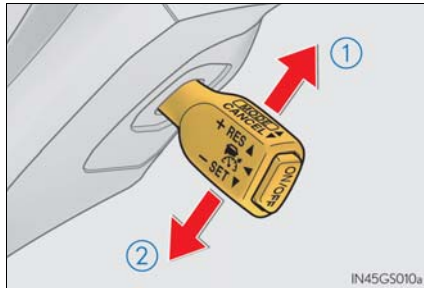

- ① Increases the speed
 - ② Decreases the speed
- Fine adjustment: Momentarily move the lever in the desired direction.
Large adjustment: Hold the lever in the desired direction.

■ Changing the vehicle-to-vehicle distance

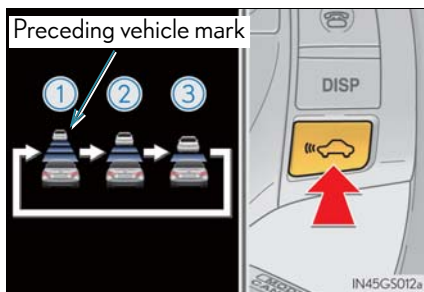

Pressing the button changes the vehicle-to-vehicle distance as follows:

- ① Long
 - ② Medium
 - ③ Short
- The vehicle-to-vehicle distance is set automatically to long mode when the engine switch is turned to IGNITION ON mode.
If a vehicle is running ahead of you, the preceding vehicle mark will be also displayed.

The vehicle-to-vehicle distance control mode maintains the preset cruising speed as long as no vehicle is detected ahead.

■ Canceling and resuming the speed control

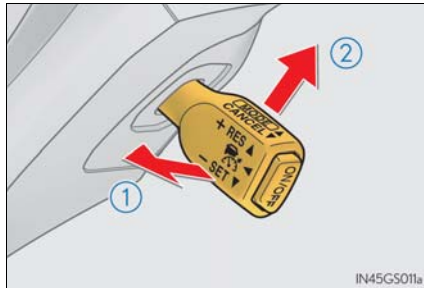

- ① Pulling the lever toward you cancels the cruise control.
The speed setting is also canceled when the brakes are applied.
- ② Pushing the lever up resumes the cruise control.
Resuming is available when the vehicle speed is more than approximately 25 mph (40 km/h).

■ Selecting conventional constant speed control mode

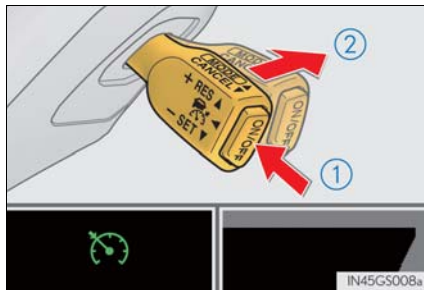

- ① Press the "ON/OFF" button to activate the cruise control.
Press the button again to deactivate the cruise control.
- ② Switch to constant speed control mode.
(Push the lever forward and hold for approximately one second.)
Cruise control indicator will come on.
When in constant speed control mode, to return to vehicle-to-vehicle distance control mode, push the lever forward again and hold for approximately 1 second.

Intuitive Parking Assist (if equipped)

The distance from your vehicle to nearby obstacles when parallel parking or maneuvering into a garage is measured by the sensors and communicated via the multi-information display, Remote touch screen and a buzzer. Always check the surrounding area when using this system.

■ Turning the system on and off

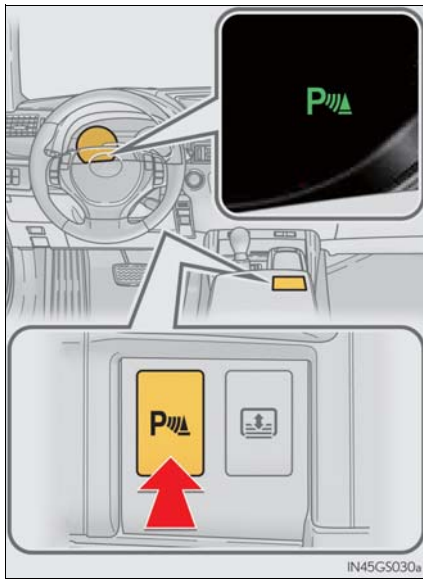

Turns the intuitive parking assist on/off

When on, the indicator light comes on to inform the driver that the system is operational.

BSM (Blind Spot Monitor) (if equipped)

The Blind Spot Monitor is a system that has 2 functions;

- The Blind Spot Monitor function
Assists the driver in making the decision when changing lanes
- The Rear Cross Traffic Alert function
Assists the driver when backing up

These functions use same sensors.

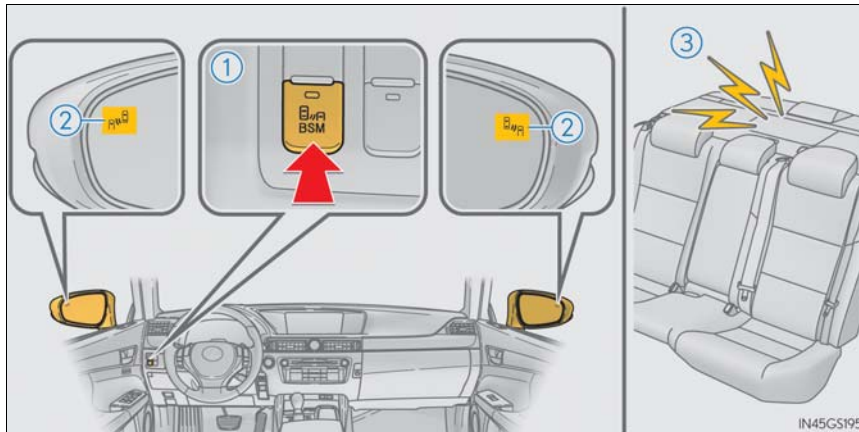

- ① BSM main switch
Pressing the switch turns the system on or off. When the switch is set to on, the switch's indicator illuminates and the buzzer sounds. Common switch for Blind Spot Monitor function and Rear Cross Traffic Alert function.
- ② Outside rear view mirror indicators
Blind Spot Monitor function:
When a vehicle is detected in the blind spot, the outside rear view mirror indicator comes on while the turn signal lever is not operated and the outside rear view mirror indicator flashes while the turn signal lever is operated.
Rear Cross Traffic Alert function:
When a vehicle approaching from the right or left rear of the vehicle is detected, the outside rear view mirror indicators flash.
- ③ Rear Cross Traffic Alert buzzer (Rear Cross Traffic Alert function only)
When a vehicle approaching from the right or left rear of the vehicle is detected, a buzzer sounds from behind the rear seat.

LKA (Lane-Keeping Assist) (if equipped)

While driving on a freeway or motor highway that has lane markers and no sharp curves, the system recognizes the lanes using a camera located above the inside rear view mirror as a sensor to assist the driver with staying in the lane. The LKA system has two functions.

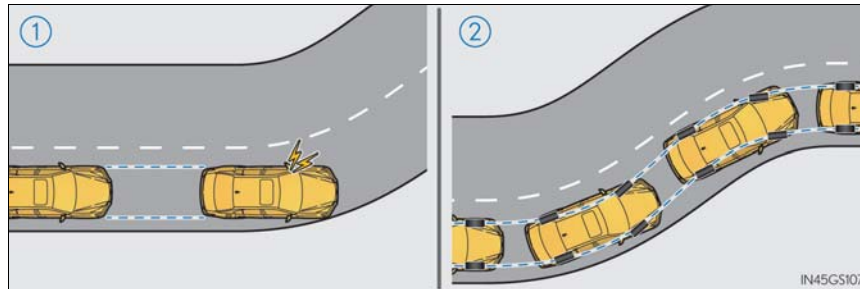

① Lane departure warning function

If the system judges that the vehicle may deviate from its lane, it alerts the driver using beeping, screen displays and a sensory warning* given via the steering wheel.

*: A slight steering torque is applied for a short period of time in the direction of the center of the lane.

② Lane keeping assist function

- This function will be active when the vehicle-to-vehicle distance control mode of the cruise control is set with vehicle speed above approximately 45 mph (72 km/h) and while the lane departure warning function is active.
- When the lane keeping assist function is active, a slight steering torque will be applied, to help the driver maintain the vehicle inside the lane.

■ Turning the LKA system on

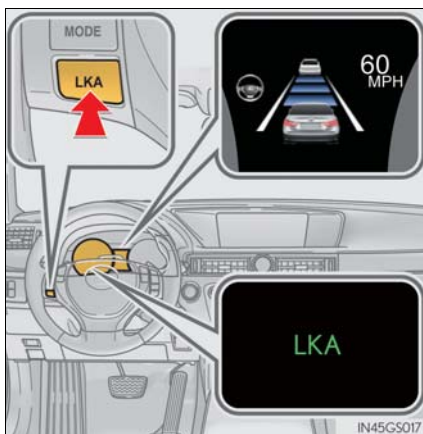

Press the "LKA" switch to activate the system.

"LKA" indicator will come on.

Press the switch again to turn the LKA system off.

The LKA system will revert to off each time the engine switch is turned to IGNITION ON mode.

■ Indication on the multi-information display

When the LKA system is on, the lane line display and steering wheel display are shown.

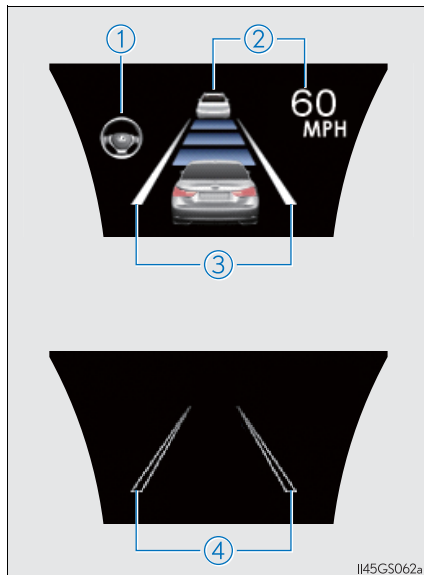

- ① Lane keeping assist function operation indication
Steering wheel displayed:
Indicates that the function is currently operating.
Steering wheel not displayed:
Indicates that the function is not currently operating.
- ② Dynamic radar cruise control display
- ③ Lane departure warning function indication (when the inside of the white line is white):
The function has recognized lane markers.
- ④ Lane departure warning function indication (when the inside of the white line is black):
A lane marker is not recognized by the system, or the LKA system functions are temporarily canceled.

Driving Mode Select Switch

The driving modes can be selected to suit driving condition.

Vehicles without AVS

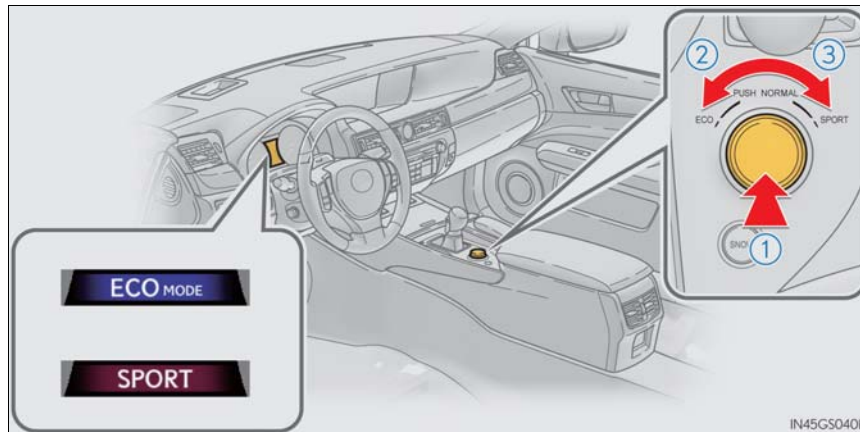

- ① Normal mode
For normal driving.
Press the switch to change the driving mode to normal mode when selected to Eco drive mode or sport mode.
- ② Eco drive mode
Use Eco drive mode to help achieve low fuel consumption during trips that involve frequent accelerating.
When not in Eco drive mode and the driving mode select switch is turned to the left, the "ECO MODE" indicator comes on in the multi-information display.
- ③ Sport mode
Assists acceleration response by controlling the transmission and steering. Suitable for when precise handling is desirable, for example when driving on mountain roads.
When not in sport mode and the driving mode select switch is turned to the right, the "SPORT" indicator comes on in the multi-information display.

■ Vehicles with AVS

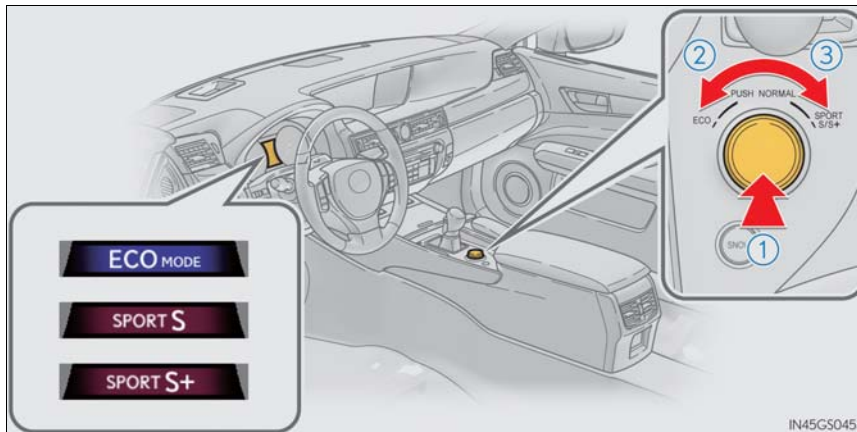

- ① Normal mode
For normal driving.
Press the switch to change the driving mode to normal mode when selected to Eco drive mode or sport mode.
- ② Eco drive mode
Use Eco drive mode to help achieve low fuel consumption during trips that involve frequent accelerating.
When not in Eco drive mode and the driving mode select switch is turned to the left, the "ECO MODE" indicator comes on in the multi-information display.
- ③ Sport mode
 - SPORT S mode
Assists acceleration response by controlling the transmission.
When not in SPORT S mode and the driving mode select switch is turned to the right, the "SPORT S" indicator comes on in the multi-information display.
 - SPORT S+ mode
Helps to ensure steering performance and driving stability by simultaneously controlling the steering and suspension in addition to the transmission. Suitable for sporty driving.
When in SPORT S mode and the driving mode select switch is turned to the right, the "SPORT S+" indicator comes on in the multi-information display.

Lexus Night View (if equipped)

Lexus night view is a system which assists with nighttime driving. Near-infrared rays are irradiated forward and an image converted from the irradiated light is shown on the Remote Touch screen. The image shows pedestrians, obstacles, and road conditions ahead of the vehicle, which are difficult to see at nighttime with the naked eye.

■ Displaying the Lexus night view

- 1 Turn the engine switch to IGNITION ON mode.
- 2 Turn the headlights on.



Press the Lexus night view switch

The Lexus night view is displayed on the Remote Touch screen.

To return the screen to its previous state, press the switch again.

When the light sensor determines that it is currently night time from the brightness of the surrounding area, the Lexus night view can be operated by pressing the Lexus night view switch while the headlights are on.

■ The Lexus night view display

● When displaying on the "Main Display"



- ① Lexus night view screen
- ② "Side Display" switching button
- ③ Brightness adjustment button

● When displaying on the "Side Display"

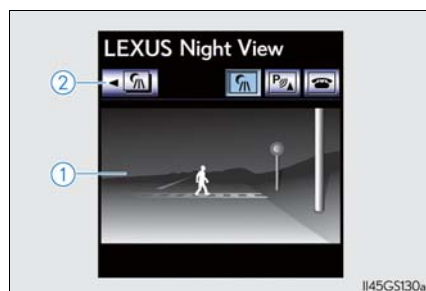

When another screen is displayed on the "Main Display" while the Lexus night view is being shown on the "Main Display", the Lexus night view screen will be displayed on the "Side Display".

- ① Lexus night view screen
- ② "Main Display" switching button

Tire Pressure Warning System

Your vehicle is equipped with a tire pressure warning system that uses tire pressure warning valves and transmitters to detect low tire inflation pressure before serious problems arise.

■ The tire inflation pressure display function (if equipped)

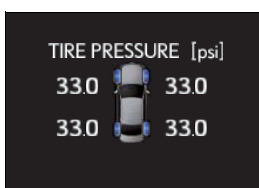

The tire pressure detected by the tire pressure warning system can be displayed on the multi-information display.

■ Initializing the tire pressure warning system

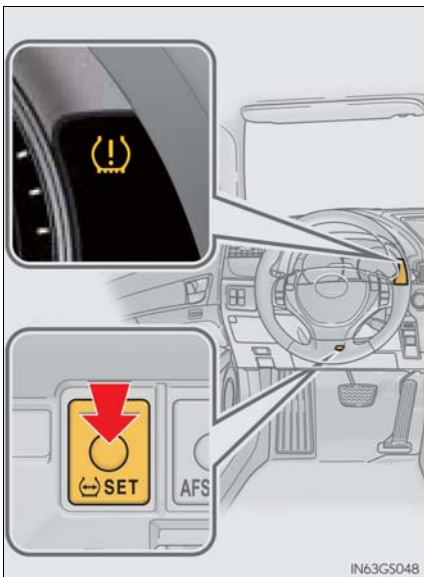

Press and hold the tire pressure warning reset switch until the tire pressure warning light blinks slowly 3 times.

Remote Touch

The Remote Touch can be used to operate the Remote Touch screens.

Basic operation

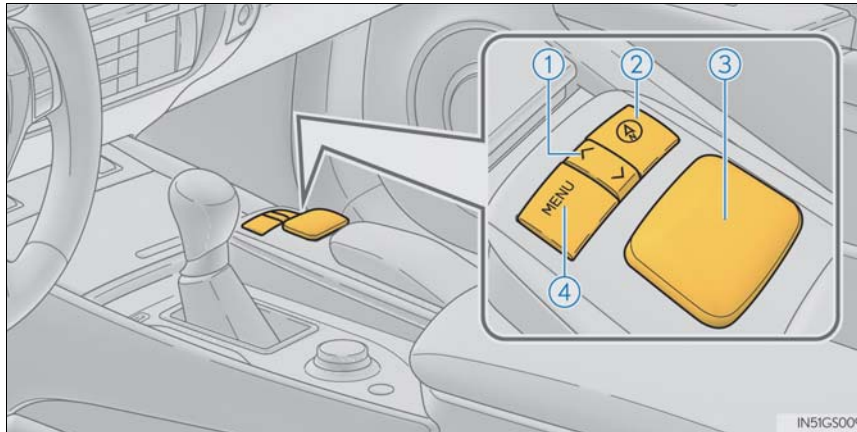

- ① “^•v” button
Press this button to change map scale and scroll through lists.
- ② Compass (“MAP/VOICE”) button
Press this button to display the compass mode screen (vehicle’s current position).
- ③ Remote Touch knob
Move in the desired direction to select a function, number or screen button.
Push the knob to enter the selected function, number and screen button.
Feedback force, pointer sound volume, on or off of selection sounds etc. can be changed. Refer to the “Owner’s Manual” and “Navigation System Owner’s Manual”.
- ④ “MENU” button
Press this button to display the “Menu” screen.

■ Menu

Vehicles without a navigation system

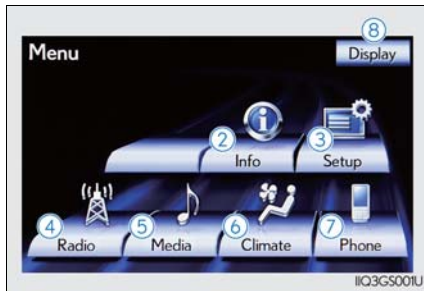

Vehicles with a navigation system



Press the "MENU" button on the Remote Touch to display the "Menu" screen.

- ① "Destination" (→P.53)
- ② "Info/Apps" or "Info"
- ③ "Setup"
- ④ "Radio" (→P.67)
- ⑤ "Media" (→P.66)
- ⑥ "Climate" (→P.70)
- ⑦ "Phone" (→P.59)
- ⑧ "Display" (→P.51)

■ Side Display (vehicles with a navigation system)



The following functions can be displayed and operated on the "Side Display".

- ① Audio (→P.66)
- ② Air conditioning (→P.70)
- ③ Vehicle information

■ Display



Press the "MENU" button on the Remote Touch and select "Display" on the "Menu" screen.

- ① Displays the screen in "Day Mode" with the headlight switch on
- ② Turns the screen off
- ③ Change function
- ④ Adjust contrast/brightness

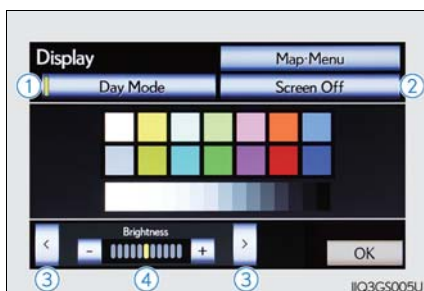

■ Screen scroll operation



To scroll over the map, place the pointer in a position near the desired destination and then press and hold the Remote Touch knob.

- ① Indicates the street name, city name, etc. for the selected point
- ② Displays various information for the selected point
- ③ Indicates the distance from the current position to the pointer
- ④ Switches the screens
- ⑤ Zooms in on the map
- ⑥ Zooms out on the map

■ Setting a route

While route guidance is operating, you can change the route using the following method.



Select "Route".

The following settings can be accessed

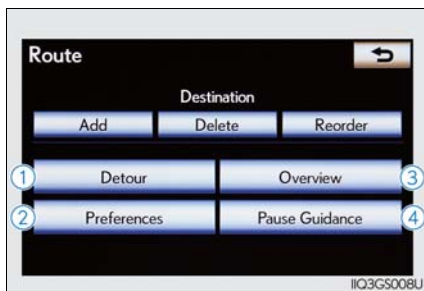

- ① Detour setting
- ② Route preferences
- ③ Route overview
- ④ Pause and resume route guidance

Some functions are unavailable while the vehicle is in motion. Refer to the "Navigation System Owner's Manual".

Navigation System (if equipped)

Register home

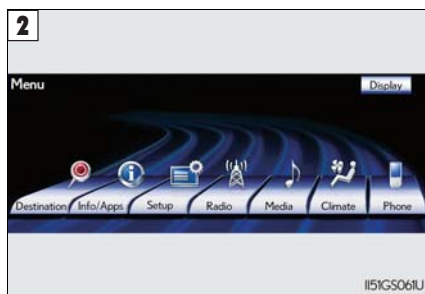

- 1** Press the "MENU" button on the Remote Touch.
Please refer to page 49 for the Remote Touch operation.
- 2** Select "Setup".
- 3** Select "Navigation".
- 4** Select "Home".
- 5** Select "Set Home".
- 6** Select "Address".
- 7** Select "City".
- 8** Input a city name and select "OK".
- 9** Select the screen button of the desired city name from the displayed list.
- 10** Input the street name and select "OK".
- 11** When the desired street name is found, select the corresponding screen button.
- 12** Input a house number and select "OK".
- 13** Select "Enter".
- 14** Select "OK".

■ Destination input — Search by address

Select by city name



- 1** Press the "MENU" button on the Remote Touch.
Please refer to page 49 for the Remote Touch operation.
- 2** Select "Destination".
- 3** Select "Address".
- 4** Select "City".
- 5** Input a city name and select "OK".
- 6** Select the screen button of the desired city name from the displayed list.
- 7** Input the street name and select "OK".
- 8** When the desired street name is found, select the corresponding screen button.
- 9** Input a house number and select "OK".
- 10** Select "Go to".
- 11** Select "OK".

Select by street address



- 1** Press the "MENU" button on the Remote Touch.
Please refer to page 49 for the Remote Touch operation.
- 2** Select "Destination".
- 3** Select "Address".
- 4** Select "Street Address".
- 5** Input a house number and select "OK".
- 6** Input the street name and select "OK".
- 7** When the desired street name is found, select the corresponding screen button.
- 8** Input a city name and select "OK".
- 9** Select the screen button of the desired city name from the displayed list.
- 10** Select "Go to".
- 11** Select "OK".

■ Destination input — Search points of interest by name

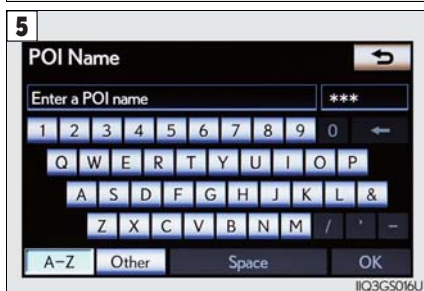
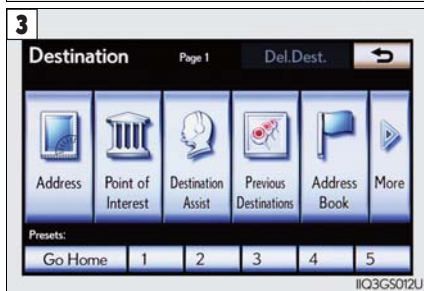

- 1** Press the "MENU" button on the Remote Touch.
Please refer to page 49 for the Remote Touch operation.
- 2** Select "Destination".
- 3** Select "Point of Interest".
- 4** Select "Name".
- 5** Input the name of the point of interest and select "OK".
- 6** Select the screen button of the desired destination.
- 7** Select "Go to".
- 8** Select "OK".

■ Destination input — Search points of interest by category

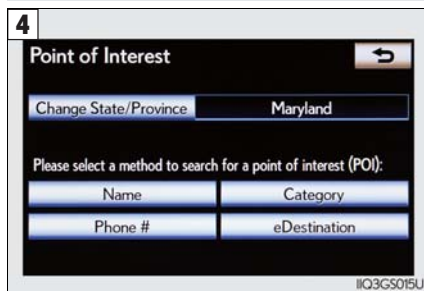
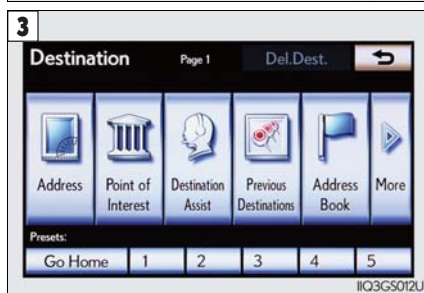

- 1 Press the "MENU" button on the Remote Touch.
Please refer to page 49 for the Remote Touch operation.
- 2 Select "Destination".
- 3 Select "Point of Interest".
- 4 Select "Category".
- 5 Select "Near a Destination".
- 6 Select the screen button of the desired destination and set screen the search point.
- 7 Select the desired point of interest category from the displayed list.
- 8 Select the screen button of the desired item.
- 9 Select "Go to".
- 10 Select "OK".

■ Destination input — Search points of interest by telephone number

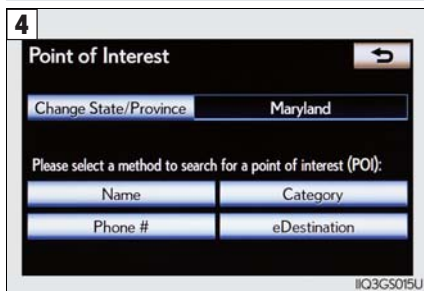
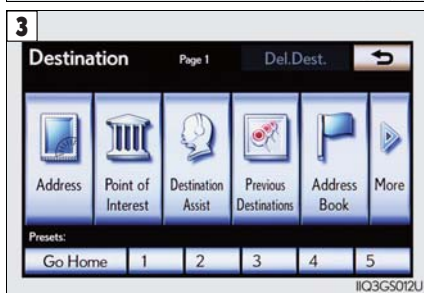

- 1** Press the "MENU" button on the Remote Touch.
Please refer to page 49 for the Remote Touch operation.
- 2** Select "Destination".
- 3** Select "Point of Interest".
- 4** Select "Phone #".
- 5** Input a telephone number and select "OK".
- 6** Select "Go to".
- 7** Select "OK".

Hands-free System For Cellular Phone

Bluetooth® phone pairing

Compatible Bluetooth®-equipped phones can be connected to the vehicle, enabling hands-free operation. Please refer to the cellular phone manufacturer's user guide for pairing procedures, or go to "<http://www.lexus.com/MobileLink>" for more phone information.



To use a Bluetooth® phone, it is necessary to first register it in the system.

- 1** Press the "MENU" button on the Remote Touch.
Please refer to page 49 for the Remote Touch operation.
- 2** Select "Phone".
- 3** Select "Yes".
- 4** Enter the passcode displayed on the screen into the phone.
Refer to the cellular phone user's manual for cellular phone operation.
- 5** If a completion message is displayed, registration is complete.

■ Phonebook transfer



- 1** Press the "MENU" button on the Remote Touch.
Please refer to page 49 for the Remote Touch operation.
- 2** Select "Setup".
- 3** Select "Phone".
- 4** Select "Phonebook".
- 5** Select "Manage Contacts".
- 6** Select "Transfer Contacts".
- 7** Select "Update Contacts".
- 8** Transfer the phonebook data to the system using the cellular phone.
Refer to the cellular phone user's manual for cellular phone operation.

Phonebook transfer may not be possible depending on phone model.

■ Registering a speed dial

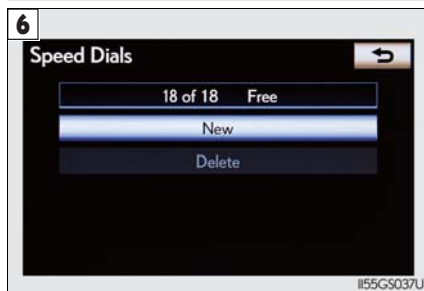

- 1** Press the "MENU" button on the Remote Touch.
Please refer to page 49 for the Remote Touch operation.
- 2** Select "Setup".
- 3** Select "Phone".
- 4** Select "Phonebook".
- 5** Select "Manage Speed Dials".
- 6** Select "New".
- 7** Select the data you want to register.
- 8** Select the desired phone number.
- 9** Select the button you want to register in.

■ Calling by name

You can call by saying a name registered in the phonebook. For setting the voice recognition, refer to the "Owner's Manual" and "Navigation System Owner's Manual". Only when English is selected as the system language can you call by saying a name registered in the phonebook without registering any voice tags beforehand. (Names in the phonebook work as voice tags.)

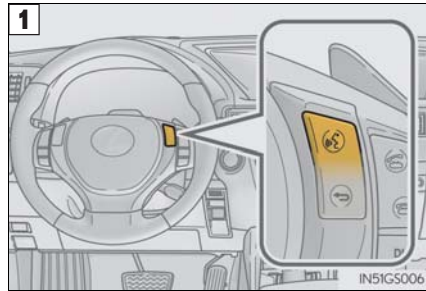

- 1 Press .
- 2 Follow the voice guidance and say "Call <name> <type>".
- 3 Follow the voice guidance and say a contact name.
- 4 Follow the voice guidance and say "Dial".

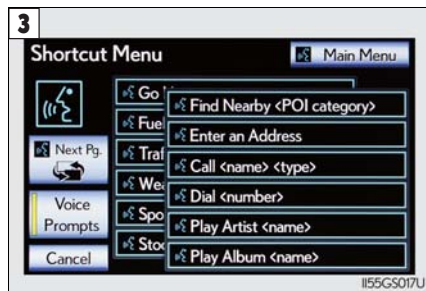

: Pressing this switch turns the voice command system on. Say a command after the beep.

■ Calling by speed dial



- 1** Press the "MENU" button on the Remote Touch.
Please refer to P.49 for the Remote Touch operation.
- 2** Select "Phone".
- 3** Select "Speed Dials".
- 4** Select the desired number to call.

■ Calling using SMS/MMS message



- 1 Press the "MENU" button on the Remote Touch.
Please refer to P.49 for the Remote Touch operation.
- 2 Select "Phone".
- 3 Select "Messages".
- 4 Select "SMS/MMS" tab.
- 5 Select the desired received message from the displayed list.
- 6 Press  on the steering wheel.

The tab display may vary depending on the type of cellular phone.

■ Receiving a call



1 When a call is received, this screen is displayed with a sound.

2 Press  on the steering wheel to talk on the phone.

To refuse the call, press  on the steering wheel.

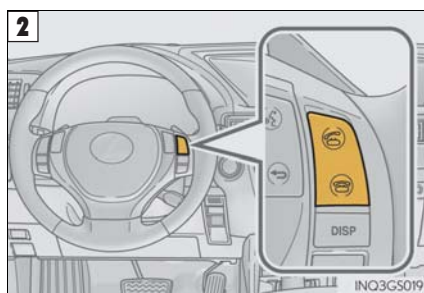

■ Steering switches

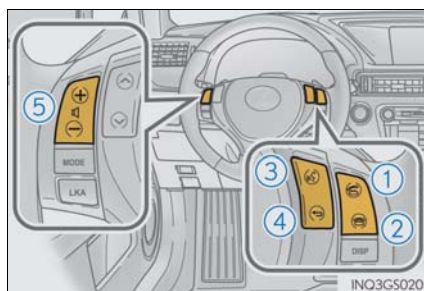

- ① Sending/Receiving/"Phone" screen display
- ② End call/Refuse call
- ③ Start the voice command system
- ④ Return to the previous screen
- ⑤ Increases/decreases volume

Audio System

Audio control screen

Follow the procedure below to display the audio control screen.



- 1 Press the "MENU" button on the Remote Touch.
Please refer to page 49 for the Remote Touch operation.
The "Menu" screen will be displayed.
- 2 Using the Remote Touch, select "Radio" or "Media" and select each tab.

Side Display (vehicles with a navigation system)



Operations such as selecting a preset station or track are carried out on the screen.

- 1 Changing the audio sources
- 2 Station selector/selecting a track/file/chapter

Remote control (steering wheel switches)

Some audio features can be controlled using the switches on the steering wheel.

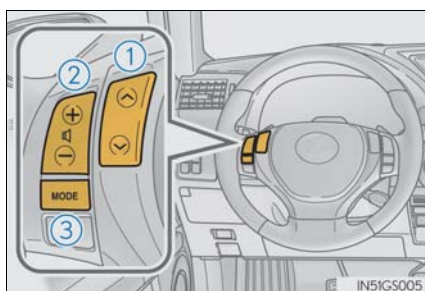

- 1 Radio mode: Selects a radio station
Audio CD mode: Selects a track
MP3/WMA disc mode: Selects a file and folder
DVD mode: Selects a chapter
iPod mode: Selects a song
- 2 Increases/decreases volume
- 3 Turns the power on, selects an audio source

Basic operation



- ① Sound quality modes
- ② Audio sources
 - AM: AM radio
 - FM: FM radio
 - SAT: Satellite radio
 - Apps (if equipped): Internet radio broadcast
 - DISC: DVD player/CD player
 - iPod: iPod
 - USB: USB memory
 - BT Audio: Bluetooth® audio
 - AUX: Auxiliary audio device
- ③ Power/Volume

Radio

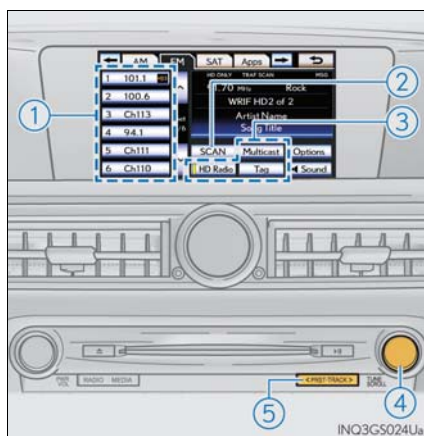

- ① Station selector
- ② Scanning for receivable stations
- ③ Using HD Radio™ Technology (if equipped)
- ④ Adjusting the frequency
- ⑤ Preset turning/seeking the frequency

Entering station presets

- 1 Select the desired station by using the tune, the seek or the scan function.
- 2 Using the Remote Touch, select one of the left side screen buttons (1-6) and hold it until a beep is heard, indicating that the station has been set.
There are 6 sets of presets. There is a total of 36 presets.

■ DVD player/CD player

■ Playing an audio CD

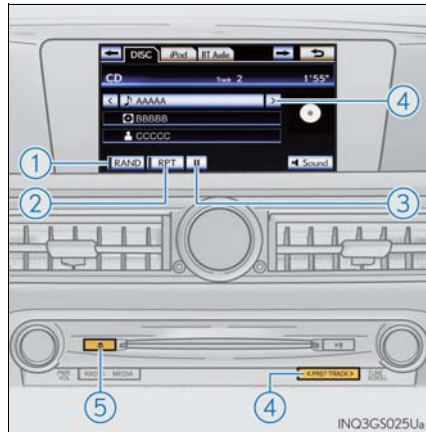

- ① Random playback
- ② Repeat play
- ③ Playback/pause
- ④ Selecting a track
- ⑤ CD eject

■ Playing a CD with MP3/WMA files

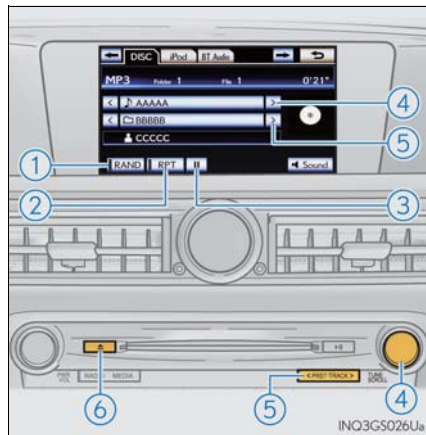

- ① Random playback
- ② Repeat play
- ③ Playback/pause
- ④ Selecting a file
- ⑤ Folder selection
- ⑥ CD eject

■ Playing a DVD



- ① Image display (full screen)
- ② Reverse
- ③ Stop
- ④ Playback/pause
- ⑤ Fast forward
- ⑥ Chapter selection
- ⑦ DVD eject

■ Operating an iPod



- ① Shuffle playback
- ② Repeat play
- ③ Playback/pause
- ④ Select play mode
- ⑤ Song selection

■ Rear seat audio controls (if equipped)

Some front audio features can be controlled from the rear seats.

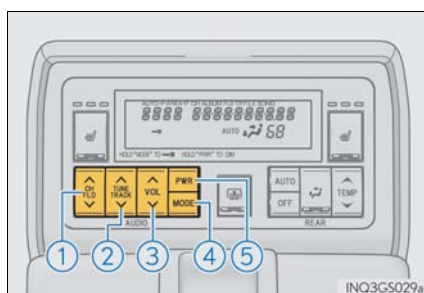

- ① Preset station or folder etc.
- ② Track or file etc.
- ③ Volume
- ④ Audio sources
- ⑤ Power

Front Air Conditioning System

Without rear air conditioning system

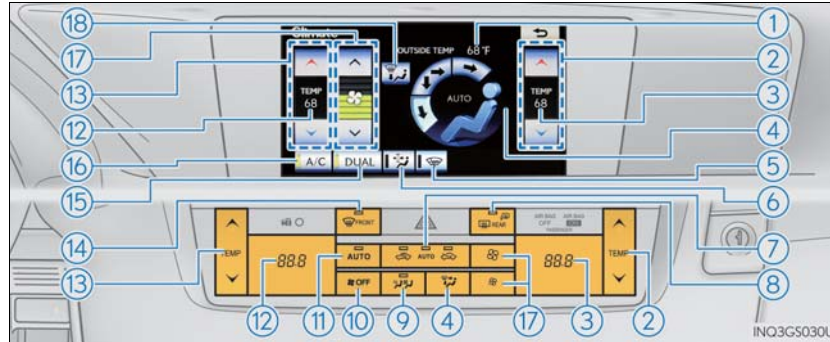

With rear air conditioning system

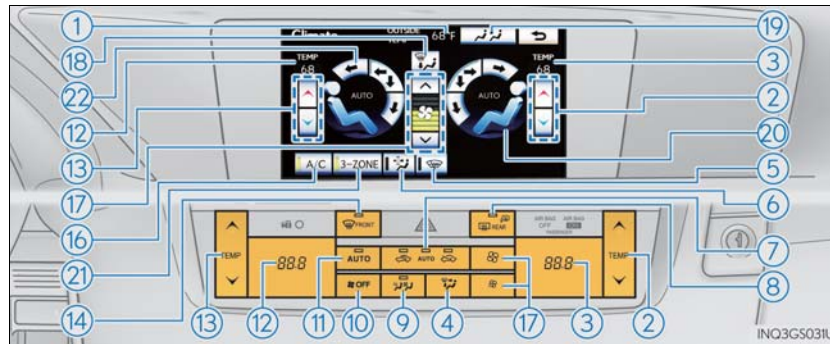

- | | |
|--|--|
| ① Outside temperature | ⑬ Driver's side temperature control |
| ② Passenger's side temperature control | ⑭ Windshield defogger |
| ③ Passenger's side temperature display | ⑮ DUAL mode |
| ④ Front seat air outlet selector | ⑯ Cooling and dehumidification function on/off |
| ⑤ Windshield wiper de-icer | ⑰ Fan speed control |
| ⑥ Micro dust and pollen filter | ⑱ Rear air conditioning operation screen |
| ⑦ Outside air or recirculated mode | ⑳ Passenger's side air outlet selector |
| ⑧ Rear window and outside rear view mirror defoggers | ㉑ 3-ZONE mode |
| ⑨ S-FLOW mode | ㉒ Driver's side air outlet selector |
| ⑩ Off | |
| ⑪ Automatic mode | |
| ⑫ Driver's side temperature display | |

■ Side Display (vehicles with a navigation system)

Without rear air conditioning system

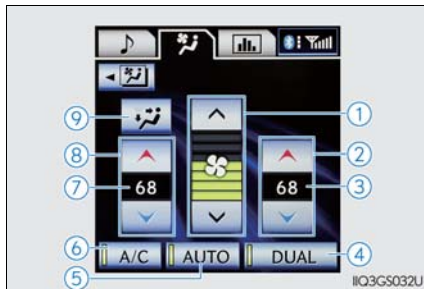

Operations such as changing the air outlets or fan speed are carried out on the screen.

- ① Fan speed control
- ② Passenger's side temperature control
- ③ Passenger's side temperature display
- ④ DUAL mode
- ⑤ Automatic mode
- ⑥ Cooling and dehumidification function on/off

With rear air conditioning system



- ⑦ Driver's side temperature display
- ⑧ Driver's side temperature control
- ⑨ Front seat air outlet selector
- ⑩ Passenger's side air outlet selector
- ⑪ 3-ZONE mode
- ⑫ Driver's side air outlet selector

■ Using the automatic mode

Press the automatic mode button to turn on the airflow and the driver's side temperature control buttons to adjust the temperature.

■ Adjusting the temperature

Without rear air conditioning system

In dual mode, driver and passenger side temperature settings can be adjusted separately.

Press the passenger's side temperature control buttons to adjust the temperature for the passenger side.

To cancel the dual mode, press the DUAL mode button.

With rear air conditioning system

In individual mode, the temperature for the driver's, front passenger's and rear seats can be adjusted separately.

Press the passenger's side temperature control buttons to adjust the temperature for the passenger side.

To adjust the temperature for the rear seats, see page 73.

To cancel the individual mode, press the 3-ZONE mode button.

■ Using the S-FLOW mode



Press the S-FLOW mode button to operate the system.

When the S-FLOW mode button is pressed, the airflow changes as follows.

Without rear air conditioning system: Air flows to the front seats only.

With rear air conditioning system: Air flows to the front seats only, and if the passenger seat is unoccupied, the set temperature, outside humidity and temperature inside the cabin are assessed, and air flows to the driver seat only.

Rear Air Conditioning System (if equipped)

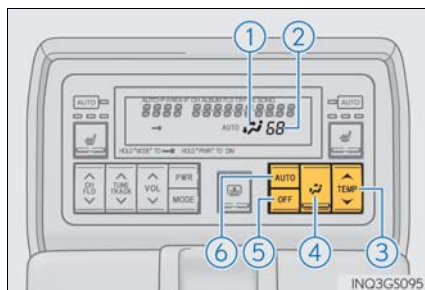

- ① Air outlet mode display
- ② Temperature display
- ③ Temperature control
- ④ Air outlet selector
- ⑤ Off
- ⑥ Automatic mode

Front controller

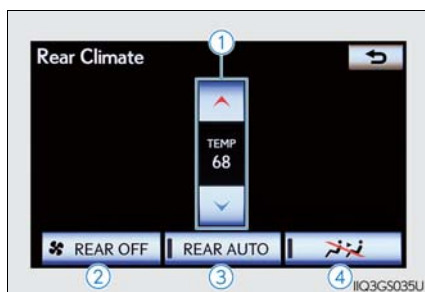

- ① Temperature control
- ② Off
- ③ Automatic mode
- ④ Disabling the switches on the rear arm-rest

Seat Heaters/Seat Ventilators (if equipped)

The seat can be warmed and air from the seat can improve ventilation.

■ Front seat heaters and ventilators (if equipped)/rear seat heaters (if equipped)

► Front seats

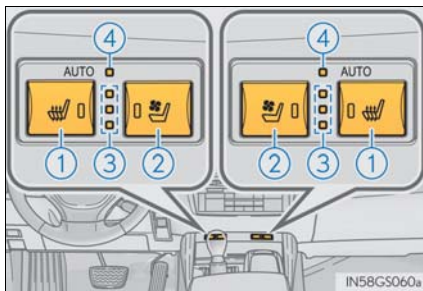

- ① Seat heater switches
The indicator light (yellow) on the switch comes on when the seat heater is operating.
- ② Seat ventilator switches (front seats only)
The indicator light (green) on the switch comes on when the seat ventilator is operating.
- ③ Level indicator lights
The seat heater temperature level or the seat ventilator fan speed level (for front seats only) is displayed.
- ④ "AUTO" indicator lights

► Rear seats

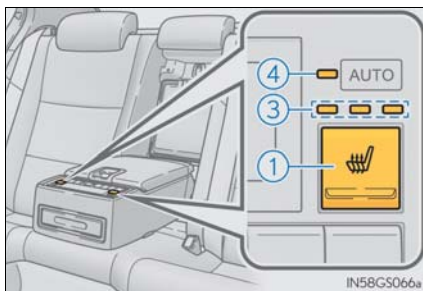

● Modes and indicators

The mode can be changed by pressing the switch.

Mode	"AUTO" indicator light	Level indicator lights
Off	Off	Off
Automatic*	On	3 to 1, or off
Hi	Off	3
Mid	Off	2
Lo	Off	1

*: When automatic mode is selected, the level automatically changes depending on the air conditioning settings.



If the driving mode select switch is switched to Eco drive mode in cold temperatures, the seat heater may be automatically operated to assist heating performance. (→P.44)

Voice Command System

NOTE: When inputting voice commands you must wait until after the beep to speak.

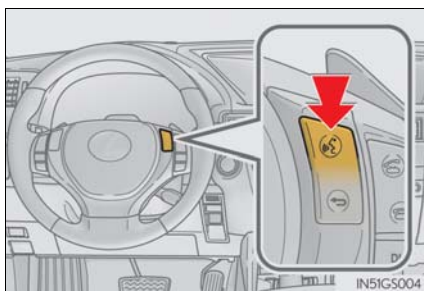
Basic operation





- 1** Press  on the steering wheel.
- 2** - If you know the command:
Press  again.
- If you do not know the command:
Follow the voice guidance to learn the command and then press  again.
- 3** Say a command after the beep.

Continue on to pages 77-79 for a detailed list of Voice Commands for the following categories:

Set a Destination	page 77
Use the Phone	page 77
Play Music	page 78
Get Information	page 78
Select audio mode	page 79
Climate/air conditioning system command	page 79

Important voice commands information and tips

- Voice commands can be used while driving.
- You must wait until after the beep to say a command.
- In vehicles with a navigation system, a large TALK icon  will appear on the navigation screen to prompt you to say a command.
- If you know what command to use, you can press  at any time to interrupt the voice guidance.
- If a desired outcome is not shown, or if no selections are available, press  on the steering wheel to return to the previous screen.

■ Command list

Set a Destination (vehicles with a navigation system)

Command	Action
"Find Nearby <POI category>"	Displays a list of <POI category> ^{*1} near the current position.
"Enter an Address"	Enables setting a destination by saying the address.
"Go Home"	Displays the route to home.
"Call Destination Assist"	Connects Lexus Enform with Safety Connect response center.
"Destination by Phone Number" ^{*2}	Enables setting a destination by saying the phone number.

*1: For example; Gas stations, Restaurants, etc.

*2: To use this function, say "Main menu" and then "Set a destination" while the "Shortcut Menu" screen is being displayed.

Use the Phone

Command	Action
"Call <name> <type>"	Calls made by saying a name from the phonebook. For example: Say "Call John Smith", "Call John Smith, mobile" etc.
"Dial <number>"	Calls made by saying the phone number. For example: Say "Dial 911", "Dial 5556667777" etc.
"International Call" [*]	Calls international numbers by saying the phone number.

*: To use this function, say "Main menu" and then "Use the phone" while the "Shortcut Menu" screen is being displayed.

Play Music

Command	Action
"Play Artist <name>"	Plays tracks by the selected artist. For example: Say "Play artist <XXXXX>"*1
"Play Album <name>"	Plays tracks from the selected album. For example: Say "Play album <XXXXX>"*1
"Play Song <name>"*2	Plays the selected track. For example: Say "Play song Summertime", "Play song Concerto in A Major" etc.
"Play Playlist <name>"*2	Plays tracks from the selected playlist. For example: Say "Play playlist My Favorite Songs", "Play Playlist Classic Hits" etc.

*1: Say the desired artist name or album name in the place of the "<>".

*2: To use this function, say "Main menu" and then "Play music" while the "Shortcut Menu" screen is being displayed.

Get Information (vehicles with a navigation system)

Command	Action
"Traffic"	Displays the traffic incident list.
"Weather"	Displays weather information.
"Sports Scores"	Displays the sports list.
"Stock Quotes"	Displays the stocks list.
"Fuel Prices"	Displays the fuel prices list.
"Lexus Insider"	Displays the Lexus insider list.

Navigation command (When destinations are set) (vehicles with a navigation system)

Command	Action
"Delete next destination"	Deletes the next destination.
"Pause guidance"	Pauses the route guidance.
"Resume guidance"	Resumes the route guidance.

Select audio mode

Command	Action
"Radio", "AM", "FM", "Satellite radio", "Disc", "Auxiliary", "Bluetooth* audio", "iPod", "USB audio"	Change the audio mode.
"Audio on"	Turns the audio system on.
"Audio off"	Turns the audio system off.

*: Bluetooth is a registered trademark of Bluetooth SIG, Inc.

Climate/air conditioning system command

Command	Action
"Automatic climate control"	Turns air conditioning system on and off.
"Warmer"	Turns temperature up.
"Cooler"	Turns temperature down.

"Select audio mode" and "Climate/air conditioning system command" are enable when expanded voice commands are turned "On". Refer to the "Owner's Manual" and "Navigation System Owner's Manual".

Portable Audio Device Ports

These ports can be used to connect a portable audio device and listen to it through the vehicle's speakers.

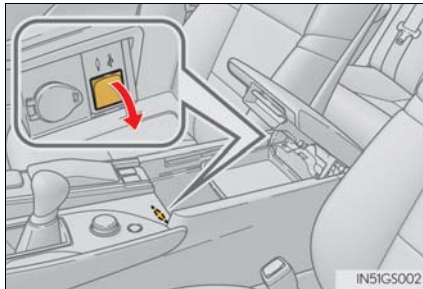

Open the console box, open the cover and connect the portable audio device.

Garage Door Opener (if equipped)

The garage door opener can be programmed to operate garage doors, gates, entry doors, door locks, home lighting systems, security systems, and other devices.

The garage door opener (HomeLink® Universal Transceiver) is manufactured under license from HomeLink®.

■ Programming the HomeLink® (for U.S.A. owners)

The HomeLink® compatible transceiver in your vehicle has 3 buttons which can be programmed to operate 3 different devices. Refer to the programming method below appropriate for the device.

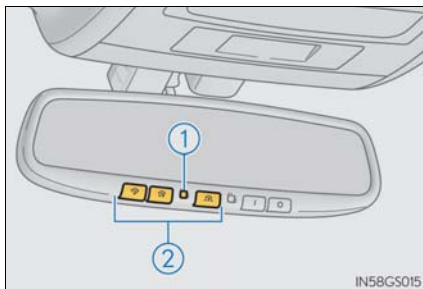

- ① Indicator light
- ② Buttons

■ Programming HomeLink®

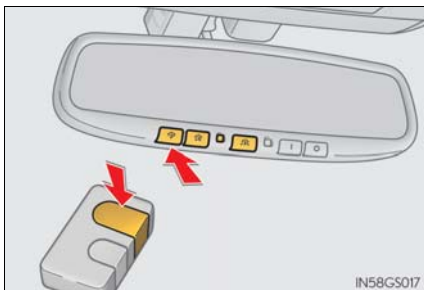

1 Hold your hand-held transmitter 1 to 3 in. (25 to 75 mm) of the HomeLink® buttons.

2 Press and hold down the desired HomeLink® button.

3 For U.S.A. owners:
While pressing the HomeLink® button, press and hold down the button on the hand-held transmitter until the indicator light changes from a slow to a rapid flash.

For Canadian owners:

While pressing the HomeLink® button, repeatedly press and release (cycle) the button on the hand-held transmitter every 2 seconds until the indicator light changes from a slow to a rapid flash.

If your garage door is of the rolling code type:

4 Press the training button on the motor-head unit in your garage.

5 Press and hold the vehicle's programmed HomeLink® button for 2 seconds and release it. Repeat this step once again.

If the door does not open, press and release the same button once again.

■ Programming other devices

For U.S.A. owners:

To program an entry gate, see the Owner's Manual.

To program other devices, contact your Lexus dealer.

For Canadian owners:

To program all other devices, follow the same procedure as for garage door programming.

■ Operating HomeLink®

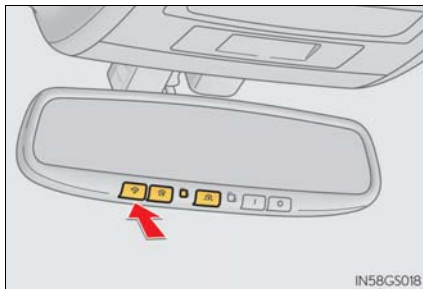

Press the appropriate HomeLink® button.
The indicator light should come on.

■ Safety Connect (if equipped)

Safety Connect is a subscription-based telematics service that uses Global Positioning System (GPS) data and embedded cellular technology to provide safety and security features to subscribers. Safety Connect is supported by Lexus' designated response center, which operates 24 hours per day, 7 days per week.

Safety Connect service is available by subscription on select, telematics hardware-equipped vehicles.

■ System components

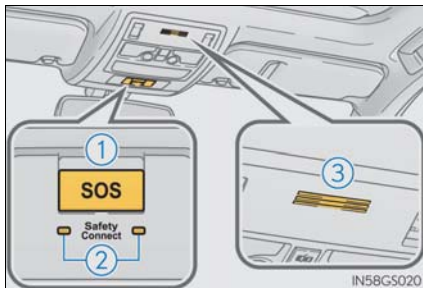

- ① "SOS" button
- ② LED light indicators
- ③ Microphone

■ Services

Subscribers have the following Safety Connect services available:

- **Automatic Collision Notification***

In case of either airbag deployment or severe rear-end collision, the system is designed to automatically call the response center. The responding agent receives the vehicle's location and attempts to speak with the vehicle occupants to assess the level of emergency. If the occupants are unable to communicate, the agent automatically treats the call as an emergency, contacts the nearest emergency services provider to describe the situation, and requests that assistance be sent to the location.

*: U.S. Patent No. 7,508,298 B2

- **Stolen Vehicle Location**

If your vehicle is stolen, Safety Connect can work with local authorities to assist them in locating and recovering the vehicle. After filing a police report, call the Safety Connect response center at 1-800-25-LEXUS (1-800-255-3987) and follow the prompts for Safety Connect to initiate this service.

In addition to assisting law enforcement with recovery of a stolen vehicle, Safety-Connect-equipped vehicle location data may, under certain circumstances, be shared with third parties to locate your vehicle. Further information is available at Lexus.com.

- **Emergency Assistance Button (SOS)**

In the event of an emergency on the road, push the "SOS" button to reach the Safety Connect response center. The answering agent will determine your vehicle's location, assess the emergency, and dispatch the necessary assistance required.

If you accidentally press the "SOS" button, tell the response-center agent that you are not experiencing an emergency.

- **Enhanced Roadside Assistance**

Enhanced Roadside Assistance adds GPS data to the already included warranty-based Lexus roadside service.

Subscribers can press the "SOS" button to reach a Safety Connect response-center agent, who can help with a wide range of needs, such as: towing, flat tire, fuel delivery, etc. For a description of the Roadside Assistance services and their limitations, please see the Safety Connect Terms and Conditions, which are available at Lexus.com.

■ Subscription

After you have signed the Telematics Subscription Service Agreement and are enrolled, you can begin receiving services.

A variety of subscription terms is available for purchase. Contact your Lexus dealer, call 1-800-25-LEXUS (1-800-255-3987) or push the "SOS" button in your vehicle for further subscription details.

Lexus Enform with Safety Connect (if equipped)

Lexus Enform with Safety Connect is a generic name for Apps, Destination Assist, eDestination, Lexus Insider, and Safety Connect.

The functions included in Lexus Enform with Safety Connect are classified into the following three functions.

For details, refer to the "Owner's Manual" and "Navigation System Owner's Manual".

Function achieved by using a cellular phone

Services

Of the functions included with Lexus Enform with Safety Connect, only Apps can be achieved by using a cellular phone.

Apps is a service that enables the usable contents of a cellular phone to be displayed on and operated from the navigation screen.

● **APPS**

Each time "Apps" is activated, the system checks for updates. When there are no updates available, the main menu screen will be displayed right after a screen indicating that updates are being checked for has been displayed.

Subscription

Apps will be available on a trial period included upon purchase of a new vehicle. User registration is required to start using the service.

When a trial period has elapsed after purchasing a new vehicle, a fee will be charged to renew the contract. Services requiring a separate contract can also be used. For details, refer to <http://www.lexus.com/enform/> or call 1-800-255-3987.

Function achieved by using DCM and the navigation system

Services

Of the functions included with Lexus Enform with Safety Connect, Destination Assist, eDestination, and Lexus Insider can be achieved by making DCM cooperate with the navigation system.

These are subscription-based telematics services that use Global Positioning System (GPS) data, embedded cellular technology to provide safety and security as well as convenience features to subscribers. The services are supported by Lexus' designated response center, which operates 24 hours per day, 7 days per week.

The services are available by subscription on select, telematics hardware-equipped vehicles.

● **Destination Assist**

Destination Assist provides you with live assistance for finding destinations via the Lexus Enform with Safety Connect response center. You can request either a specific business, address, or ask for help locating your desired destination by category, such as restaurants, gas stations, shopping centers or other points of interest (POI).

After you tell the agent your choice of destination, its coordinates are sent wirelessly to your vehicle's navigation system.

- **eDestination**

With the eDestination feature, you can go online, via the Lexus.com owner's Web site, to select and organize destinations of your choice and then wirelessly send them to your vehicle's navigation system.

You can store up to 200 locations online to access and update at any time.

Your locations can be organized into up to 20 personalized folders.

You must first go online at www.lexus.com/drivers/ to view the Owners site where you will need to register and log in. After this, you can create your personalized folders containing the locations you wish to send to your vehicle. (See Lexus Enform with Safety Connect Guide for more information.)

- **Lexus Insider**

Lexus Insider is an optional service that can send audio messages, or articles, to participating owners' vehicles via the navigation system. Potential Lexus Insider subjects might include, for example, Lexus vehicle technology tips, updates on regional Lexus events, or audio excerpts from Lexus Magazine articles. Up to 20 articles can be stored at a time.

You may opt out of receiving Lexus Insider messages at any time.

- **Subscription**

After you have signed the Telematics Subscription Service Agreement and are enrolled, you can begin receiving services. A variety of subscription terms is available for purchase.

Contact your Lexus dealer, call 1-800-25-LEXUS (1-800-255-3987), or select the "Destination Assist" in your vehicle for further subscription details.

- **Function achieved by using DCM**

- **Services**

Of the functions included with Lexus Enform with Safety Connect, Safety Connect can be achieved by using DCM.

- Safety Connect (→P.82)

XM Services (if equipped)

XM services are subscription-based XM Satellite Radio services to provide convenient features to subscribers.

For details, refer to the "Owner's Manual" and "Navigation System Owner's Manual".

Services

With an active XM subscription, the following features are available:

- **XM Sports and Stocks**^{*1}

XM Sports and Stocks is a service included with an XM Satellite Radio subscription. This service is also available with an XM TravelLink subscription. With this service, you can receive updates via the navigation system on your personally selected sports teams and stocks.

- **XM Fuel Prices**^{*2}

XM Fuel Prices is a service included with an XM TravelLink subscription. It enables the navigation system to display current fuel prices and gas station locations, which can be set as a destination if desired.

- **XM NavWeather**^{TM*2}

The subscription-based XM NavWeatherTM service allows the navigation system to display weather information on the map screen.

- **XM NavTraffic**^{®*2}

The subscription-based XM NavTraffic[®] service allows the navigation system to display traffic information on the map screen.

^{*1}: Available at no extra charge with an active XM Satellite Radio subscription.

^{*2}: Available via separate XM subscription(s).

Subscription

XM NavTraffic[®], XM NavWeatherTM and XM TravelLink require separate XM subscription(s). XM Sports^{*}, XM Stocks^{*} and XM Fuel Prices are available with an XM TravelLink subscription. After a 90-day trial, you must contact XM and set up the appropriate XM subscription(s) to continue receiving these services.

^{*}: XM Sports and XM Stocks are included with an XM Satellite Radio subscription.

Door Locks

The vehicle can be locked and unlocked using the entry function, wireless remote control or door lock switches.

For details the entry function or wireless remote control (→ P.10, 11)

Door lock switches

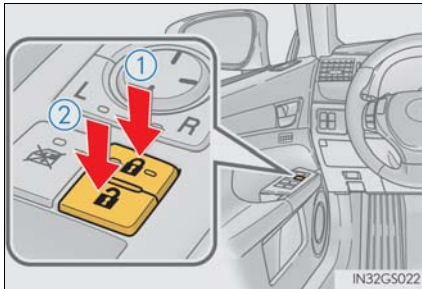

- ① Locks all the doors
- ② Unlocks all the doors

Inside lock button

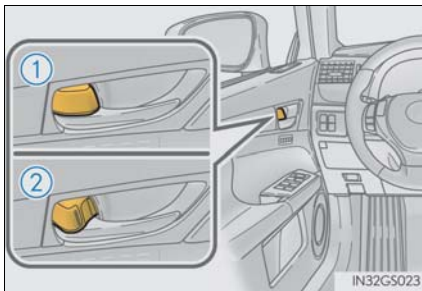

- ① Locks the door
 - ② Unlocks the door
- The front doors can be opened by pulling the inside handle even if the lock buttons are in the lock position.

■ Rear door child-protector lock

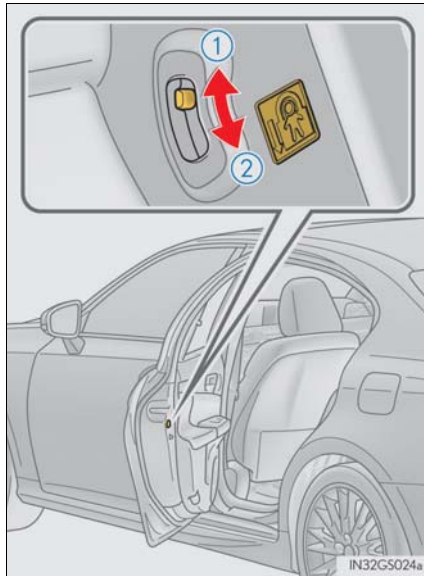

The door cannot be opened from inside the vehicle when the lock is set.

① Unlock

② Lock

These locks can be set to prevent children from opening the rear doors. Push down on each rear door switch to lock both rear doors.

Power Windows

Power window switches

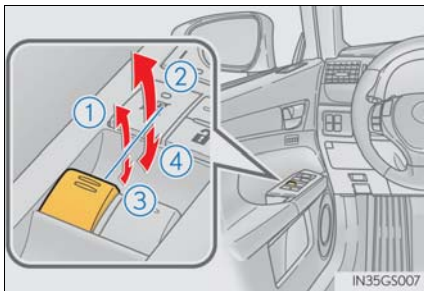

- ① Closing
- ② One-touch closing*
- ③ Opening
- ④ One-touch opening*

*: To stop the window partway, operate the switch in the opposite direction.

Window lock switch

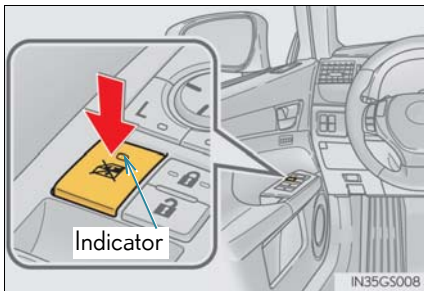

Press the switch down to lock the passenger window.

The indicator will come on.

Use this switch to prevent children from accidentally opening or closing a passenger window.

Moon Roof

■ Opening and closing

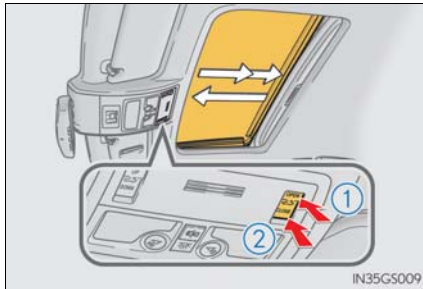

- ① Opens the moon roof*
The moon roof stops slightly before the fully open position to reduce wind noise.
Press the switch again to fully open the moon roof.

- ② Closes the moon roof*

*: Lightly press either of the moon roof switches to stop the moon roof partway.

■ Tilting up and down

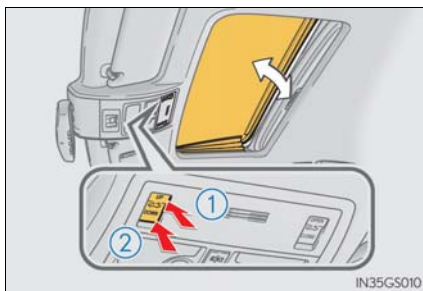

- ① Tilts the moon roof up*

- ② Tilts the moon roof down*

*: Lightly press either of the moon roof switches to stop the moon roof partway.

Fuel Tank Cap

■ Before refueling the vehicle

- Close all the doors and windows, and turn the engine switch off.
- Confirm the type of fuel.

■ Opening the fuel tank cap

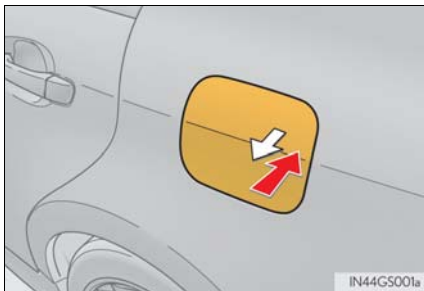

- 1** With the doors unlocked, press the center of the rear edge of the fuel filler door. Push until you hear a click and take your hand away to slightly open the fuel filler door. Then open the door fully by hand.

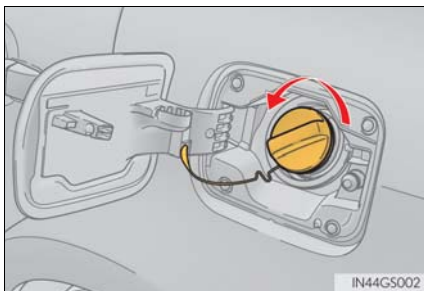

- 2** Turn the fuel tank cap slowly to open.

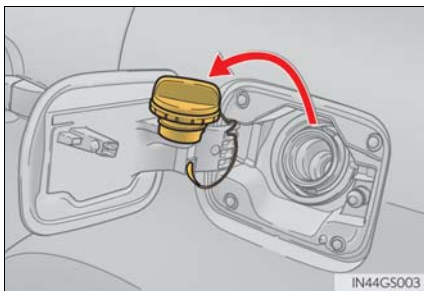

- 3** Hang the fuel tank cap on the back of the fuel filler door.

Trunk

Opening the trunk

● From inside the vehicle

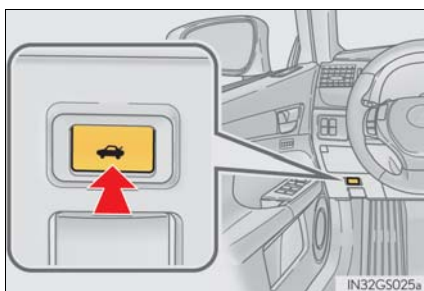

Press the opener switch.

If the vehicle is equipped with a power trunk opener and closer, the trunk lid automatically opens fully.

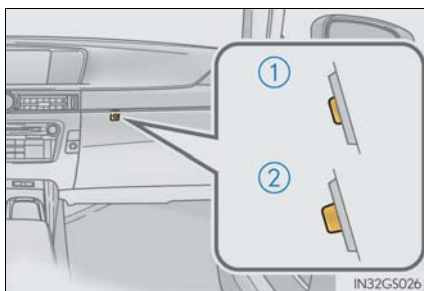

Turn the main switch in the glove box off to disable the trunk opener.

① On

② Off

The trunk lid cannot be opened even with the wireless remote control or the trunk release button.

● From outside the vehicle

- Trunk release button

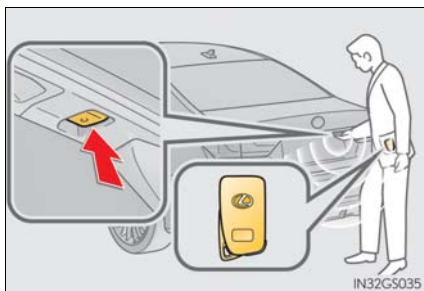

While carrying the electronic key, press the button on the trunk lid.

When all the doors are unlocked with the power door lock system, the trunk can be opened without carrying the electronic key.

- Wireless remote control
→ P.10

Trunk easy closer (vehicles with power trunk opener and closer)

In the event that the trunk lid is left slightly open, the trunk easy closer will automatically close it to the fully closed position.

■ Trunk closer switch (vehicles with power trunk opener and closer)

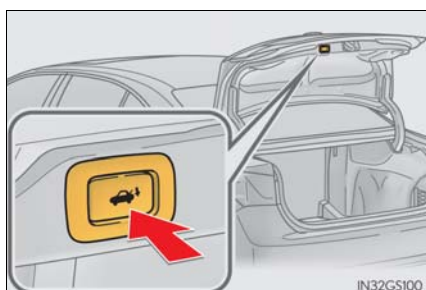

Pressing the switch closes the trunk lid automatically. (A buzzer sounds.)

Pressing the switch while the trunk lid is closing opens the trunk lid again.

What to do if...

List of Warning/Indicator Lights

Stop the vehicle immediately. Continuing to drive the vehicle may be dangerous.

- 

(U.S.A.)

Brake system warning light
- 

(Canada)

Stop the vehicle immediately.

- 

Charging system warning light

Have the vehicle inspected immediately.

- 

(U.S.A.)

Malfunction indicator lamp
- 

(Canada)
- 

SRS warning light
- 

(U.S.A.)

ABS warning light
- 

(Canada)
- 

Electric power steering system warning light
- 

(Flashes)

"PCS" warning light (if equipped)
- 

Slip indicator
- 

(Flashes)

"AFS OFF" indicator (if equipped)
- 

(Flashes)

(U.S.A.)

Parking brake indicator
- 

(Canada)
- 

Brake system warning light
- 

(Blinking and then continuously on)

Tire pressure warning light

For further information, refer to the Owner's Manual.

What to do if...

Follow the correction procedures.



Open door warning light



Master warning light



Low fuel level warning light



Tire pressure warning light*



Seat belt reminder light

(Illuminates without blinking)

See the Owner's Manual



Turn signal indicator



Intuitive parking assist indicator (if equipped)



Headlight indicator (U.S.A.)



"AFS OFF" indicator (if equipped)



Tail light indicator (Canada)



Slip indicator



Headlight high beam indicator



VSC OFF indicator



Front fog light indicator (if equipped)



"PCS" warning light (if equipped)



Cruise control indicator



Parking brake indicator (U.S.A.)



Radar cruise control indicator (if equipped)



Parking brake indicator (Canada)



Cruise control "SET" indicator



BSM (Blind Spot Monitor) outside rear view mirror indicators (if equipped)



LKA (Lane-Keeping assist) indicator (if equipped)



"AIR BAG ON/OFF" indicator

For further information, refer to the Owner's Manual.

*: It also comes on due to natural causes such as natural air leaks and tire inflation pressure changes caused by temperature. Adjust the tire inflation pressure to the specified level. The light will turn off after a few minutes. In case the light does not turn off even if the tire inflation pressure is adjusted, have the system checked by your Lexus dealer.

What to do if...

If the electronic key does not operate properly

■ Unlocking and locking the doors

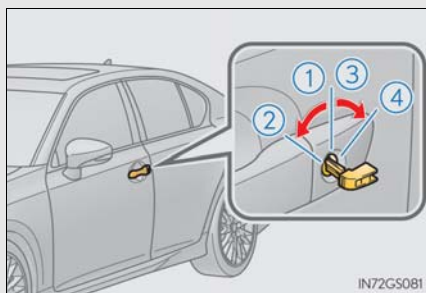

Use the mechanical key in order to perform the following operations:

- ① Locks all the doors
- ② Closes the windows and moon roof* (turn and hold)
- ③ Unlocks the door
Turning the key rearward unlocks the driver's door. Turning the key once again within 5 seconds unlocks the other doors.
- ④ Opens the windows and moon roof* (turn and hold)

*: This setting must be customized at your Lexus dealer.

■ Unlocking the trunk

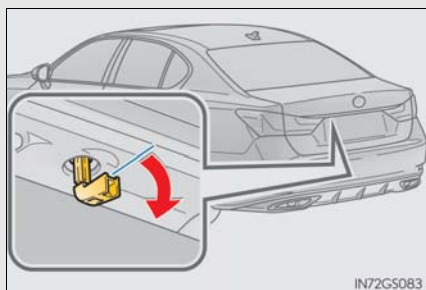

Turn the mechanical key clockwise to open.

What to do if...

■ Starting the engine

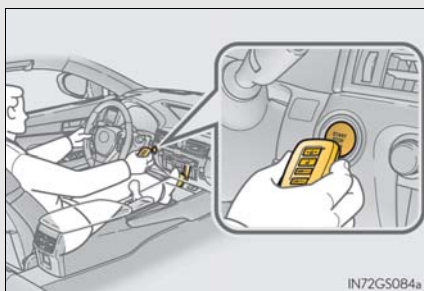

- 1** Ensure that the shift lever is in P and depress the brake pedal.
- 2** Touch the Lexus emblem side of the electronic key to the engine switch. The engine switch will turn to IGNITION ON mode. When the smart access system with push-button start is deactivated in customization setting, the engine switch will turn to ACCESSORY mode.
- 3** Firmly depress the brake pedal and check that  is shown on the multi-information display.
- 4** Press the engine switch.

In the event that the engine still cannot be operated, contact your Lexus dealer.

If the electronic key battery becomes depleted, replace it with a new battery. For instructions on replacing the battery, refer to the Owner's Manual. If you need further assistance, contact your Lexus dealer.

If the engine doesn't start

Make sure that the correct operating procedures have been followed.

Brake pedal

Make sure that the brake pedal is firmly depressed when attempting to start the engine. (→P.17)

If the engine still does not start, see the Owner's Manual for more information or contact your Lexus dealer.

Memo

Memo

Memo



Your Lexus dealer

Your Lexus dealer will provide quality maintenance and any other assistance you may require.

If there is not a Lexus dealer near you, please call the following number:

■ U.S. OWNERS

- In the U.S. mainland or Canada:
Lexus Roadside Assistance
1-800-25-LEXUS or **1-800-255-3987** (Toll-Free)
- In Hawaii:
Servco Automotive Roadside Assistance/Customer Services
1-800-25-LEXUS or **1-800-255-3987** (Toll-Free)

■ CANADIAN OWNERS

- In Canada or the U.S. mainland:
Lexus Roadside Assistance/Customer Service
1-800-26-LEXUS or **1-800-265-3987** (Toll-Free)

Please access our **websites** for further information.

- The U.S. mainland: www.lexus.com
- Hawaii: www.servcolexus.com
- Canada: www.lexus.ca

©2013 TOYOTA MOTOR CORPORATION

All rights reserved. This material may not be reproduced or copied, in whole or in part, without the written permission of Toyota Motor Corporation.