

1	Charging operation	
2	Plug-in Hybrid Applications	
3	Basic operation	
4	Things you must know	

The quick guide is not intended as a substitute for your “OWNER’S MANUAL”. We strongly encourage you to review the “OWNER’S MANUAL” and supplementary manuals so you will have a better understanding of your vehicle’s capabilities and limitations.

Depending on specifications, the vehicle shown in the illustration may differ from your vehicle in terms of equipment.

Charging equipment

Charging equipment and names

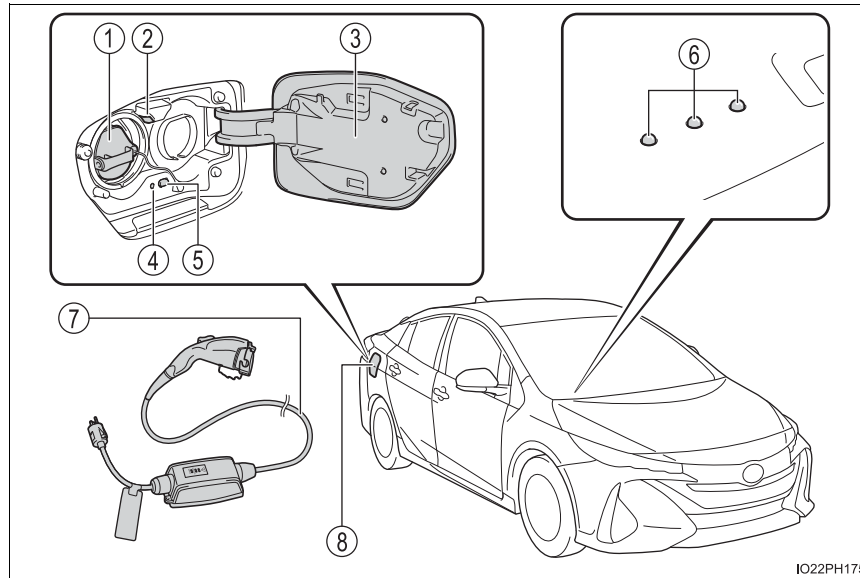

- ① Charging inlet
- ② Charging inlet light
- ③ Charging port lid
- ④ Charging indicator
- ⑤ Charging connector lock switch*
- ⑥ Hybrid battery (traction battery) status indicator
- ⑦ Charging cable
- ⑧ Charging port

*: If equipped, refer to "OWNER'S MANUAL"

The names of each part of the charging cable

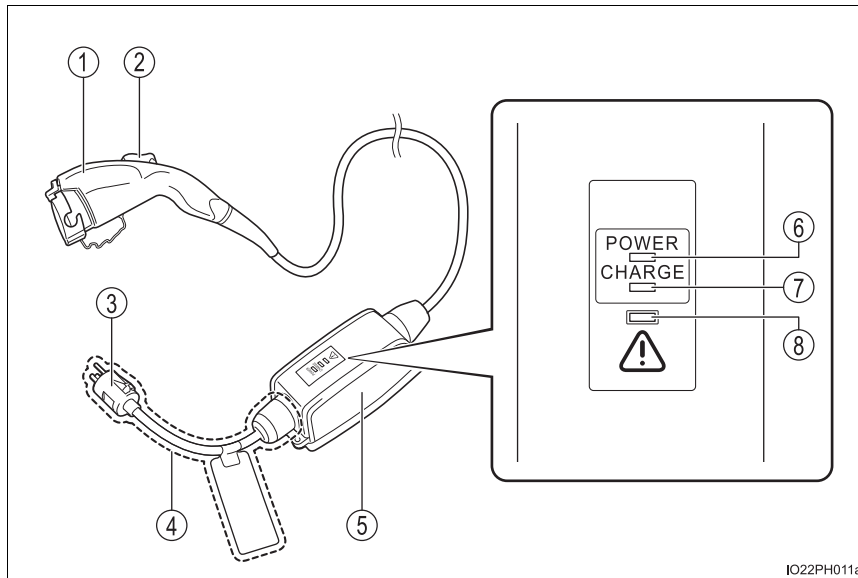

1

Charging operation

- ① Charging connector
- ② Latch release button
- ③ Plug
- ④ Plug-cord
- ⑤ CCID (Charging Circuit Interrupting Device)
- ⑥ Power indicator
- ⑦ Charging indicator
- ⑧ Error warning indicator

■ Safety functions

The CCID (Charging Circuit Interrupting Device) has the following safety features.

● Electrical leakage detection function

If an electrical leakage is detected during charging, the power source will be automatically interrupted, thus preventing fires or electrical shocks caused by electrical leakage.

● Automatic check function

This is an automatic system check that is run before charging begins to check for problems in the operation of the electrical leakage detection function.

● Temperature detection function

A temperature detection function is equipped to the plug. While charging, if heat is generated due to looseness on the outlet side etc., this function suppresses heat by controlling the charging current.

● Conditions for supplying current to the vehicle

The CCID (Charging Circuit Interrupting Device) is designed to prevent electrical current from being supplied to the charging connector when it is not connected to the vehicle, even if the plug is inserted into the outlet.

-
- The hybrid system will not start while the charging cable is attached to the vehicle, even if the power switch is operated.
 - If the charging cable is connected while the "READY" indicator is illuminated, the hybrid system will stop automatically and driving will not be possible.
 - When the charging cable is connected to the vehicle, the shift position cannot be changed from P to another position.

⚠ WARNING**■ Power sources precautions**

Observe the following precautions.

If you do not follow them, fire, electrical shock or damage may occur, possibly resulting in death or serious injury.

- Connect to an AC 120 V outlet (NEMA 5-15R) with a Ground-Fault Circuit-Interrupter (GFCI) and supplied by a circuit breaker per your local code. Use of a 15A individual circuit is strongly recommended.

- Do not connect the charging cable to a multi-outlet adapter, multi-plugs, or conversion plug.

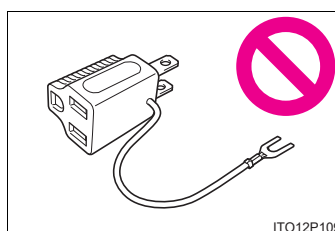

- Connecting the charging cable to an extension cord is strictly prohibited. The extension cord may overheat and does not contain a Ground-Fault Circuit-Interrupter (GFCI).

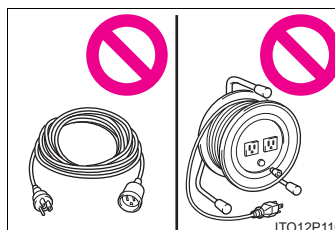

- Do not connect to a power strip.

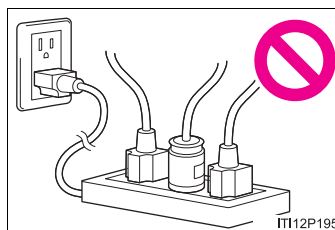

- Use of a block heater for charging is prohibited.
- Make sure to connect the charging connector and charging inlet directly. Do not connect a converting adaptor or extension cord between the charging connector and charging inlet.

Opening and closing the charging port lid**■ Opening the charging port lid**

Vehicles without smart lid & connector locking system:

Press the rear edge of the charging port lid (the position shown in the illustration).

Push and take your hand away to slightly open the charging port lid. Then open the lid fully by hand.

Vehicles with smart lid & connector locking system:

Press the rear edge of the charging port lid (the position shown in the illustration) with the doors unlocked.

Push and take your hand away to slightly open the charging port lid. Then open the lid fully by hand.

While the doors are locked, only the charging port lid can be unlocked by carrying an electronic key and pressing the charging port lid.

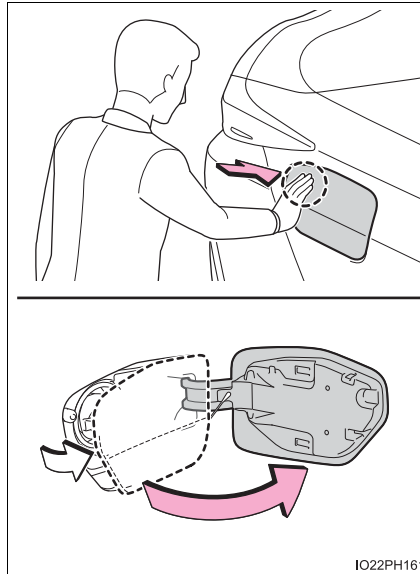

■ Closing the charging port lid

Close the charging port lid and press the rear edge of the charging port lid (the position shown in the illustration).

Vehicles with smart lid & connector locking system:

- When the doors are locked with the smart key system, wireless remote control or door lock switch, the charging port lid is also locked.
- If the charging port lid is closed with the doors locked, the charging port lid locks.

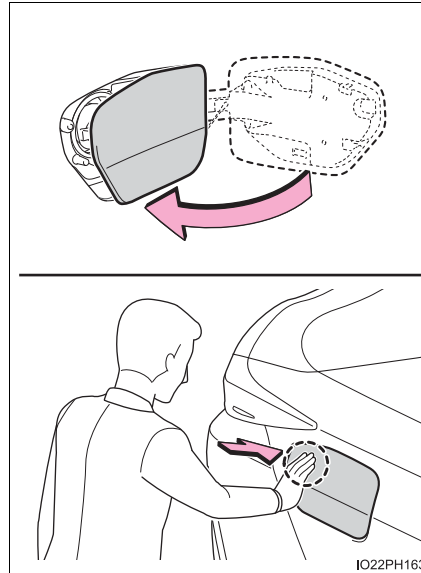

1

Charging operation

JO22PH163

Hybrid battery (traction battery) status indicator

When the charging cable is connected to the charging inlet, the user is informed of the charging status of the hybrid battery (traction battery) by the statuses of 3 indicators (turned off, illuminated or flashing).

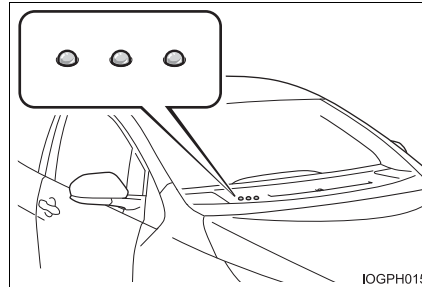
**When the hybrid battery (traction battery) is fully charged**

When the charging cable is connected, all 3 hybrid battery (traction battery) status indicators illuminate to inform the user that the hybrid battery (traction battery) is fully charged.

Charging indicator

The illumination/flashing pattern changes to inform the user of the charging status.

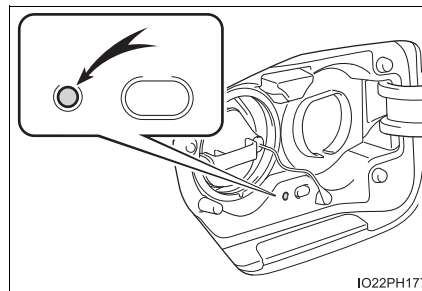

How to charge

Charging precautions

This vehicle has been designed to allow charging from an external power source using a charging cable for exclusive use with standard household AC outlets.

However, the vehicle differs greatly from standard household electrical goods in the following ways, and incorrect usage could cause fire or electric shock, possibly leading to death or serious injury.

- The charging operation is designed to operate at 12A continuously for the charge duration (up to 5 hours 10 minutes).
- Charging can be conducted outdoors.

To charge properly, follow the procedure after reading the explanation below. Charging is intended to be carried out by licensed drivers only who properly understand the charging procedure.

- Charging should not be carried out by children.
- When charging with a charging equipment, follow the procedures for using each equipment.
- When charging using a public charging facility, check the setting of the charging timer function.
 - When the charge schedule is registered, temporarily turn off the function or turn "Charge Now" on.
 - When the charge schedule is set to ON, charging will not start even if the charging cable is connected. Also, charging fee may occur due to connection of the charging cable.

1

Charging operation

Confirm the following before charging

Before charging, always check the following items.

- The parking brake is applied.
- The headlights are switched off or set to AUTO, and lights such as the emergency flashers and interior lights etc. are switched off.

If these light switches are turned ON, then these features will consume electricity, and charging time will increase.

- The power switch is off.

Estimated charging time

The time required to charge the hybrid battery (traction battery) differs according to the charging voltage and charging current.

Connected power source	Charging station	Home power source
Charging voltage	AC 240 V	AC 120 V
Charging current ^{*1}	16A	12A
Estimated charging time ^{*2}	Approximately 2 hours	Approximately 5 hours 10 minutes

^{*1}: This is the maximum value.

^{*2}: The time required for charging to complete depends on conditions such as the remaining charge of the hybrid battery (traction battery) and the outside temperature.

When charging

- 1 Prepare the charging cable.
- 2 Insert the charging cable into the outlet of the external power source.

Make sure to hold the body of the plug and insert it firmly into the outlet.

Check that the power indicator on the CCID (Charging Circuit Interrupting Device) is illuminated.

In order to reduce the load on the outlet and plug, when inserting the plug, use a string, etc. to hang the CCID (Charging Circuit Interrupting Device) on a hook or equivalent.

- 3 Open the charging port lid.
- The charging inlet light will illuminate.

- 4 Remove the charging inlet cap and secure it as shown in the illustration.

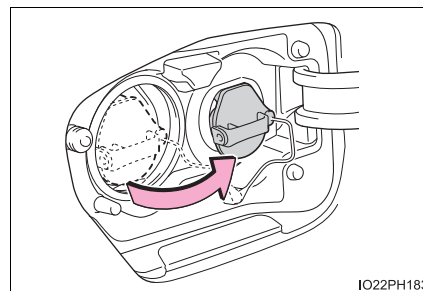
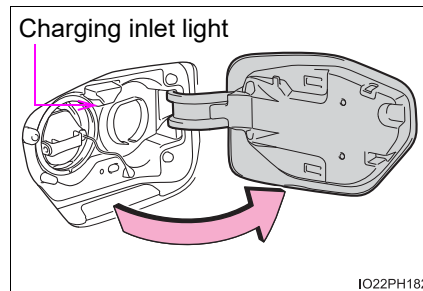
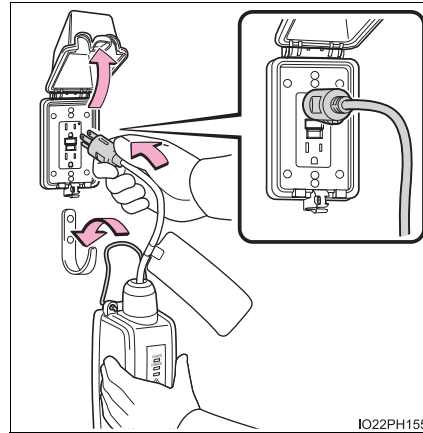

1

Charging operation

- 5 Remove the protective cap of the charging connector and secure it to the cable.

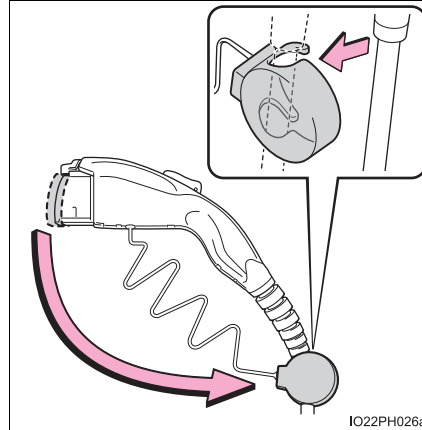

- 6 Insert the charging connector into the charging inlet.

Align the guide position on the bottom of the charging connector, and push the charging connector straight into the charging inlet as far as possible.

Once a “click” sound is heard, check that the charging connector is securely locked.

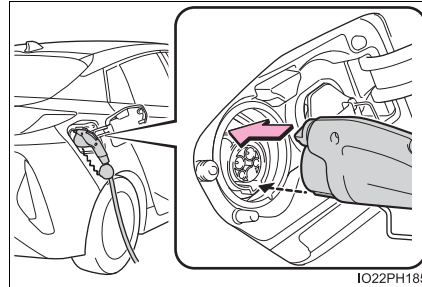

- 7 Confirm that the charging indicator is illuminated.

Charging will not start if the charging indicator does not illuminate when the charging connector is inserted.

If the charging indicator is flashing, the charge schedule is registered.

If the error warning indicator on the CCID (Charging Circuit Interrupting Device) flashes during charging, refer to “OWNER’S MANUAL” and follow the correction procedure.

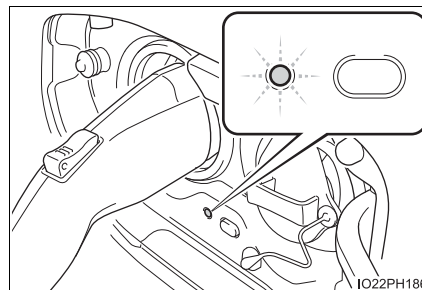

- 8 Vehicles with smart lid & connector locking system:
When you wish to lock the charging connector, carry an electronic key and press the charging connector lock switch.

The charging connector will be locked by the smart lid & connector locking system. After the charging connector is locked, the charging connector cannot be unlocked by pressing the charging connector lock switch if the electronic key is not in detection area of charging port lid.

The charging indicator will turn off when charging is completed.

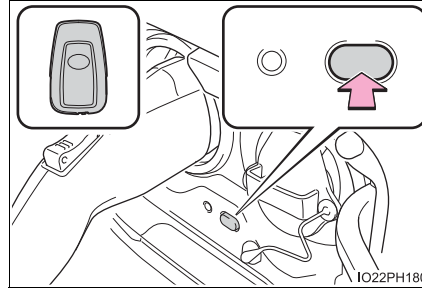

1

Charging operation

■ During charging

- The surface of the CCID (Charging Circuit Interrupting Device) may become hot, but this does not indicate a malfunction.
- Depending on radio wave conditions, interference may be heard on the radio.
- The current charging condition and the estimated time until charging will complete can be checked on the multi-information display or 11.6-inch display (if equipped).
- During charging, the hybrid battery (traction battery) status indicator illuminates and flashes, and changes according to the charging amount.

After charging

- 1 Vehicles with smart lid & connector locking system:
When the charging connector is locked, carry an electronic key and press the charging connector lock switch.

The charging connector is unlocked by the smart lid & connector locking system.

Carrying an electronic key and moving near the charging inlet will cause the charging inlet light to illuminate.

- 2 Pull the charging connector towards you while pressing the latch release button.

If the charging connector is disconnected during charging (while the charging indicator is on), charging will be interrupted.

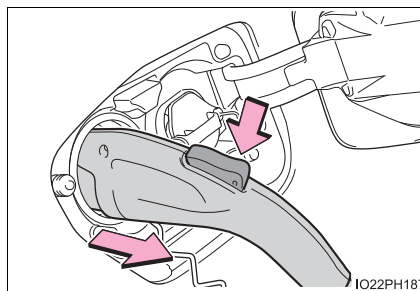
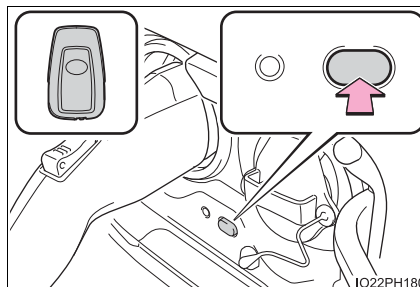

- 3 Attach the charging connector cap.
- 4 Attach the charging inlet cap and close the charging port lid.
- 5 Remove the plug from the outlet when the charging equipment will not be used for a prolonged period of time.

Hold the body of the plug when removing.

Make sure to put the cable away immediately after disconnecting.

When leaving the plug inserted, inspect the plug and connector once a month to check if dirt or dust has accumulated.

■ Safety function

If the latch release button is pressed, charging will not begin even if the charging cable is connected.

Also, charging will be stopped if the latch release button is pressed and held for several seconds during charging. When restarting charging, reinsert the charging connector after pulling it out, and check that the charging indicator illuminates.

**WARNING****■ When charging**

Observe the following precautions.

Failure to do so may cause an unexpected accident, resulting in death or serious injury.

- Connect to a power source suitable for charging.
- Check that the charging inlet, charging cable, plug and outlet are free of foreign matter.
- Only use outlets where the plug can be securely inserted.
- Do not charge if the charging cable is coiled or bundled.
- Wrapping 120 V charging cable while in-use is not recommended because cable may overheat. Failure to rewrap charging cable when not in-use could result in strangulation or tripping hazard.
- Do not wash the vehicle while the charging cable is connected to the vehicle and when the charging lid is open.
- Do not touch the terminals of the charging connector and charging inlet with a sharp metal objects (needles etc.) or hands, or short them with foreign objects.
- When charging outdoors, make sure to connect to a weatherproof outlet for outdoor use.
- Do not insert the plug if the outlet is submerged in water or snow.
- Follow these points when charging while it is raining or snowing.
 - Check that no snow, water or ice has accumulated around the charging connector terminals and the vehicle charging inlet. Tap snow, water or ice gently from connector prior to inserting charging connector into the vehicle's charging inlet.
 - Do not connect the plug if your hands are wet. Also, do not get the plug or outlet wet.
- Do not charge the vehicle during a lightning storm.
- Do not let the wheels on the charging cable, plug, charging connector and CCID (Charging Circuit Interrupting Device).
- Firmly insert the plug into the outlet.
- Do not use an extension cord and converting adaptor.

**WARNING****■ After charging**

Remove the plug if it will not be used for a long time.
Dirt and dust may accumulate plug or outlet, which could cause a malfunction or fire, possibly leading to death or serious injury.

■ Charging equipment

There is charging equipment under the rear seats. Make sure to observe the following precautions regarding the charging equipment. Failure to observe these precautions may result in death or serious injury such as burns and electric shocks.

- The charging equipment is hot during charging. Do not touch the charging equipment, as doing so may result in burns.
- Do not disassemble, repair or modify the charging equipment.
When the charging equipment needs to be repaired, consult your Toyota dealer.

**NOTICE****■ When use the charging cable and related parts**

To prevent damage to the charging cable and related parts, observe the following precautions.

- When interrupting or canceling charging, remove the charging connector before removing the plug.
- Vehicles with smart lid & connector locking system: When removing the charging cable, check that the charging connector is unlocked.
- Do not forcefully pull the connector cap and charging inlet cap.
- Do not apply a vibration to the charging connector while charging.
Charging may be stopped.
- Do not insert anything but the charging connector.
- When inserting the plug into or removing the plug from the outlet, make sure to hold the body of the plug.
- Do not damage the charging inlet cap with a sharp object.
- Do not forcefully pull the charging cable that is caught or entangled.
If the cable is entangled, disentangle it before using.
- When charging from the external device, use the charging cable equipped with the vehicle.

■ When charging

Do not insert the plug into the charging inlet.
The charging inlet may be damaged.

**NOTICE****■ After charging**

- After disconnecting the charging connector from the charging inlet, make sure to put on the charging inlet cap and close the charging port lid. If the charging inlet cap is not put on, water or foreign objects may enter the charging inlet, which could lead to vehicle damage.

- Vehicles without smart lid & connector locking system: The charging port lid does not have a lock. Take care not to press and open the door accidentally.
- Vehicles with smart lid & connector locking system: If the charging port lid is not locked, take care as it may open if unintentionally touched.

- After removing the plug from the outlet, keep it in a safe place free from moisture and dust.

The charging cable or plug may be damaged if the cable is stepped on or ridden over by the vehicle.

■ Using private power generator

Do not use private power generators as a power source for charging. Doing so may make charging unstable, the voltage may be insufficient, and the error warning indicator on the CCID (Charging Circuit Interrupting Device) of the charging cable may flash.

■ Usable temperature range

- Do not charge if the outside temperature is -22°F (-30°C) or below, as it is likely that charging will take longer, and equipment related to charging will be damaged.
- Do not leave the vehicle or the charging cable in areas where the outside temperature is lower than -40°F (-40°C). The vehicle or charging cable will probably be damaged.

■ Charging equipment

Due to the environment in which the power equipment is located, charging may be unstable due to noise, the voltage may be insufficient, and the error warning indicator on the CCID (Charging Circuit Interrupting Device) of the charging cable may flash.

Using the charging timer function

Charging timer function

Charging can be carried out at the desired time by registering the charge schedule. When registering the charge schedule, the following settings can be changed.

- Select the charging mode (“Start”/“Departure”)
- Repeated setting
- Air conditioning-linked setting (“Climate Prep”)
- Turning “Charge Now” on and off
- Changing “Next Charging Event”

For details of each settings, refer to “OWNER’S MANUAL”.

The charge schedule can be registered on the multi-information display or 11.6-inch display (if equipped).

Setting operations on multi-information display

When operating timer settings, use the charging timer switch and meter control switches.

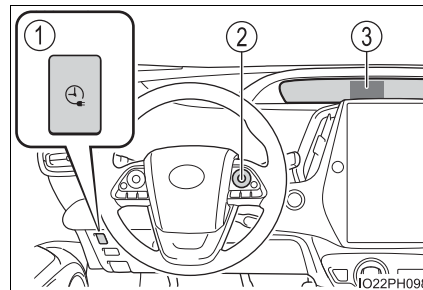

- ① Charging timer switch
- ② Meter control switches
- ③ Multi-information display



■ Registering the charge schedule

- 1 Press the charging timer switch.

The “Charge Schedule” screen will display on the multi-information display.

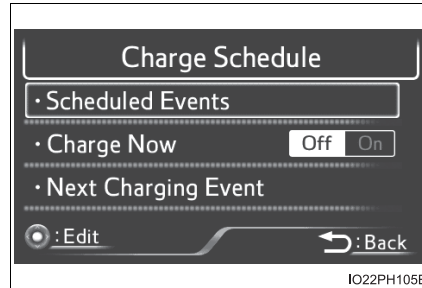

- 2 Press  or  of the meter control switches to select “Scheduled Events”, and then press .

The “Scheduled Events” screen will display.



IO22PH105E

For information about setting of the items other than “Scheduled Events”, refer to “OWNER’S MANUAL”.

- 3 Press  or  of the meter control switches to select “+”, and then press .

The “Edit Charging Event” screen will display.

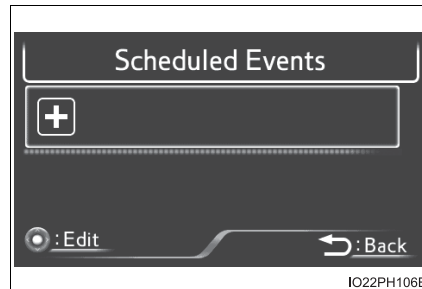

IO22PH106E

- 4 Operate the meter control switches to select the item and change the setting.

After changing the settings to the desired settings, press  to return to the previous screen.

After setting operations are complete, when the charging cable is connected to the vehicle, charging will be carried out according to the charging timer settings.

1



Charging operation

■ Changing the registered charge schedules



The registered charge schedules can be turned on, off, deleted or modified.

- 1 Press the charging timer switch.

The “Charge Schedule” screen will display on the multi-information display.

- 2 Press  or  of the meter control switches to select “Scheduled Events”, and then press .

The “Scheduled Events” screen is displayed, which displays a list of the registered charge schedule.

- 3 Press  or  of the meter control switches to select the item to change, and then press .

The “Edit Charging Event” screen will display.

- 4 Operate the meter control switches to select the item and change the setting.

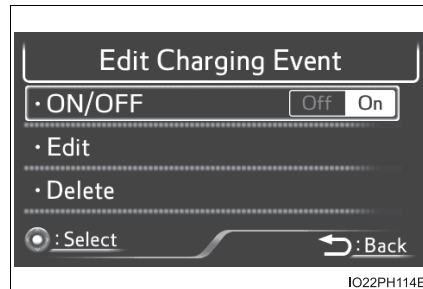
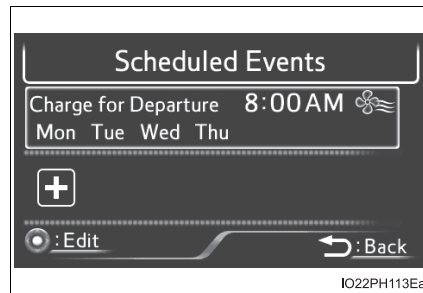
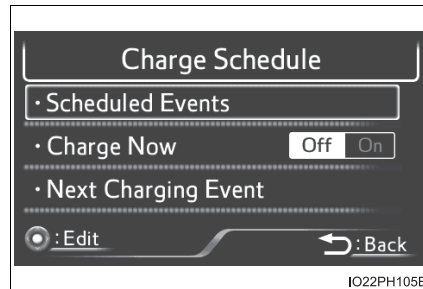

Setting operations on the 11.6-inch display (if equipped)

Press the “MENU” button, then select “Info” and “Charge Schedule”.
For details of “Charge Schedule” screen, refer to “OWNER’S MANUAL”.

■ Registering the charge schedule

- 1 Display the “Charge Schedule” screen.
- 2 Press “Add”.
- 3 Select the charging mode.
- 4 Operate the time setting wheel to set the start (or departure) time.
- 5 When activating the repeated settings, press the desired day button.
- 6 When the charging mode is set to “Departure”, set the “Climate Prep” to on or off.
- 7 After setting operations are complete, press “Save”.

To cancel registration of the timer settings, press .

After setting operations are complete, when the power switch is turned off and the charging cable is connected to the vehicle, charging is carried out according to the charging timer settings.

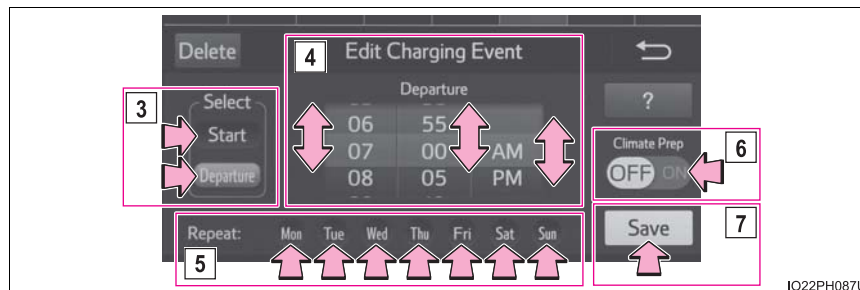

IO22PH087U

■ Changing the registered charge schedules

- 1 Display the “Charge Schedule” screen.
- 2 From the items displayed on the bottom of the screen, press “Edit” in the row of the charge schedule you wish to change.

The settings screen will display on the bottom of the screen.

It is also possible to display the settings screen by pressing the icon of the charge schedule you wish to change from those displayed on the calendar.

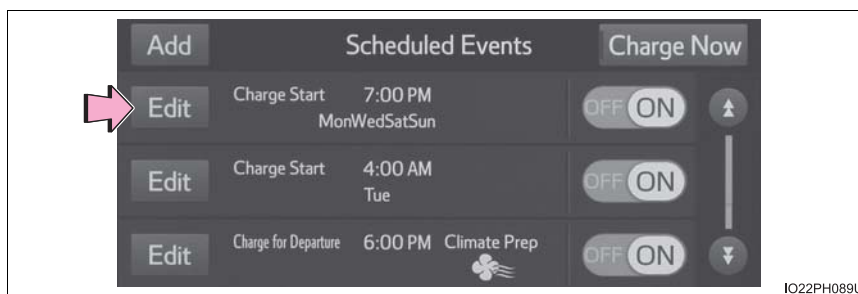

Charging tips

Checking information related to charging

Information related to charging can be displayed and checked on the multi-information display.

For details on the screen display for the 11.6-inch display (if equipped), refer to "OWNER'S MANUAL".

■ While charging

When any door is opened during charging, the current charging condition and remaining time until charging is complete can be checked.

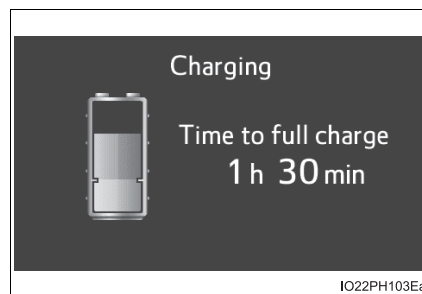

■ After charging is complete

After charging is complete, the first time that the hybrid system is started, a message detailing the results of the charging is displayed. Also, a message is displayed if an operation that stops charging is performed or a situation where charging cannot be performed occurs.

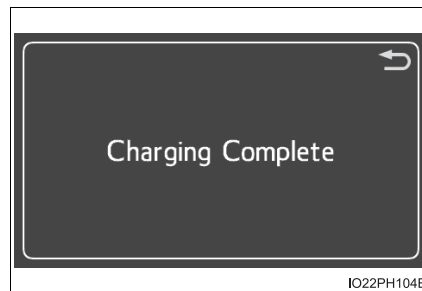

1

Charging operation

Inspecting and maintaining the charging cable

For safety, inspect the charging cable on a routine basis.



WARNING

■ Routine inspection

Check the following points regularly.

Failure to do so may cause an unexpected accident, resulting in death or serious injury.

- The charging cable, plug, charging connector, CCID (Charging Circuit Interrupting Device) etc. have not been damaged
- The outlet has not been damaged
- The plug can be securely inserted into the outlet
- The plug does not get extremely hot during use
- The tip of the plug has not been deformed
- The plug is not dirtied by dust etc.

Remove the plug from the outlet before inspecting it. If any abnormalities are found in the charging cable as a result of the inspection, immediately stop use and consult your Toyota dealer.

■ Maintaining the charging cable

When the charging cable is dirty, first remove the dirt with a hard, wringed cloth, and then wipe the cable with a dry cloth.

However, never wash it with water. If the charging cable is washed with water, fire or electric shock may occur during charging, possibly resulting in death or serious injury.

■ When not using the charging cable for a long time

Remove the plug from the outlet. Dust could accumulate on the plug or in the outlet, possibly causing overheating which could lead to a fire.

Also, keep the cable in a place free from moisture.

Plug-in Hybrid Applications

Plug-in Hybrid Applications is a service for plug-in hybrid vehicles.

These are added to the Safety Connect and Entune App Suite products.

The contents provide charge support, comfort support and drive support via the vehicle's navigation system and the owner's Smartphone.

Both of the following accounts are required for the services.

- Active Safety Connect account
- Active Toyota Entune App Suite account

Plug-in Hybrid Applications operation

The following functions can be used with the navigation system.

- Download of nearby charging stations to the map screen (Type A)
- View list of nearby charging stations and corresponding charging station information (such as voltage supported) (Type B)

For details about the function, refer to <http://www.toyota.com/entune/>.

Basic operation

How to operate the Remote Air Conditioning System

■ Before leaving the vehicle

Check the temperature setting of the air conditioning system.

The Remote Air Conditioning System will operate in accordance with the temperature settings of the air conditioning system.

■ Activating the Remote Air Conditioning System

Press and hold “A/C” on the wireless remote control to operate the Remote Air Conditioning System.

The system will shut off if a door is opened.

The system can be stopped by pressing “A/C” twice.

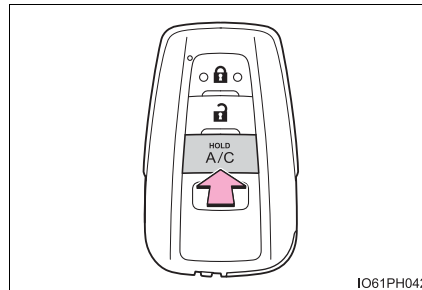

IO61PH042

■ Operating conditions

The system will only operate if all of the following conditions are met:

- The shift position is in P.
- The power switch is off.*
- All doors are closed.
- The hood is closed.

*: The Remote Air Conditioning System cannot be used for approximately 3 minutes and a half after the power switch is turned off.

How to operate unlocking and locking the doors

Carry the electronic key to enable these functions.

■ Front door handles

- ① Grip the driver's door handle to unlock the door. Holding the driver's door handle for approximately 2 seconds unlocks all the doors. Some models, grip the front passenger's door handle to unlock all the doors*.

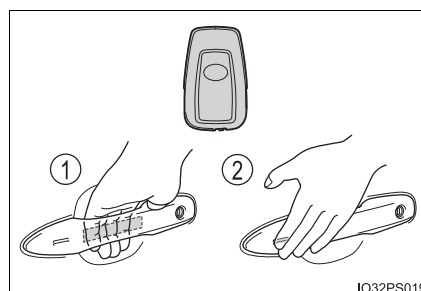

Make sure to touch the sensor on the back of the handle.

The doors cannot be unlocked for 3 seconds after the doors are locked.

*: The door unlock settings can be changed. (Refer to "OWNER'S MANUAL".)

- ② Touch the lock sensor (the indentation on the surface of the front door handle) to lock the doors.

Check that the door is securely locked.

■ Back door

- ① Locks all the doors
Check that the door is securely locked.
- ② Unlocks all the doors
The doors cannot be unlocked for 3 seconds after the doors are locked.

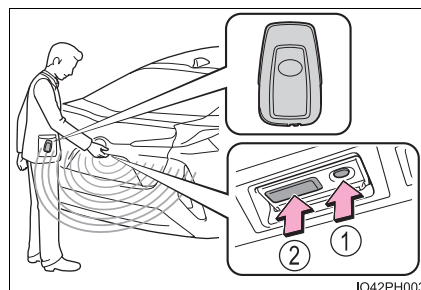

How to operate the power (ignition) switch

■ Starting the hybrid system

- 1 Check that the charging cable is disconnected.
- 2 Check that the parking brake is set.
- 3 Firmly depress the brake pedal.



and a message will be displayed on the multi-information display.

When the shift position is N, the hybrid system cannot start. Shift the shift position to P when starting the hybrid system.

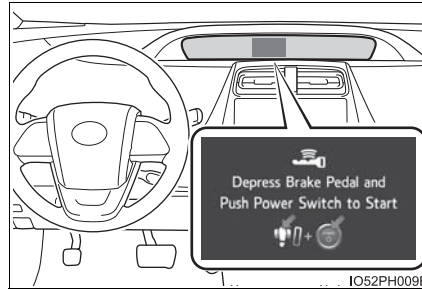

- 4 Press the power switch shortly and firmly.

When operating the power switch, one short, firm press is enough. It is not necessary to press and hold the switch.

If the "READY" indicator turns on, the hybrid system will operate normally.

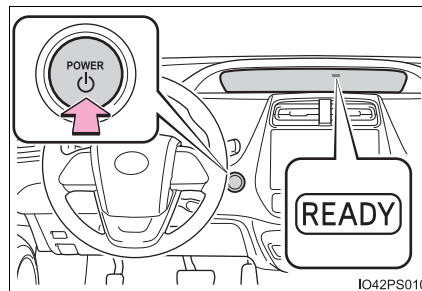

Continue depressing the brake pedal until the "READY" indicator is illuminated.

The hybrid system can be started from any power switch mode.

- 5 Check that the "READY" indicator is illuminated.

If the "READY" indicator changes from a flashing light to a solid light and the buzzer sounds, the hybrid system is starting normally.

The vehicle will not move when the "READY" indicator is off.

The vehicle can move when the "READY" indicator is on even if the engine is stopped. (The gasoline engine starts or stops automatically in accordance with the state of the vehicle.)

■ Stopping the hybrid system

- 1 Stop the vehicle completely.
- 2 Set the parking brake.
- 3 Shift the shift position to P.
Check that the shift position indicator shows P.

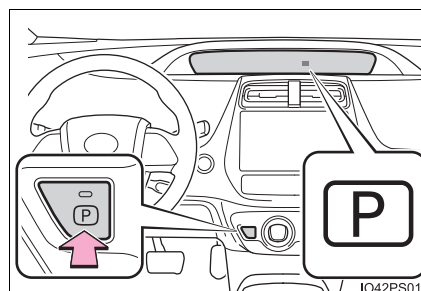

- 4 Press the power switch.
The hybrid system will stop.
- 5 Slowly release the brake pedal and check that the display on the instrument cluster is off.

The meter display sequentially turns off after the hybrid system stops.

■ Changing power switch modes

Modes can be changed by pressing the power switch with the brake pedal released. (The mode changes each time the switch is pressed.)

- ① Off
The emergency flashers can be used.
- ② ACCESSORY mode
Some electrical components such as the audio system can be used.
"Accessory" is displayed on the main display.
- ③ ON mode
All electrical components can be used.
"Ignition ON" is displayed on the main display.

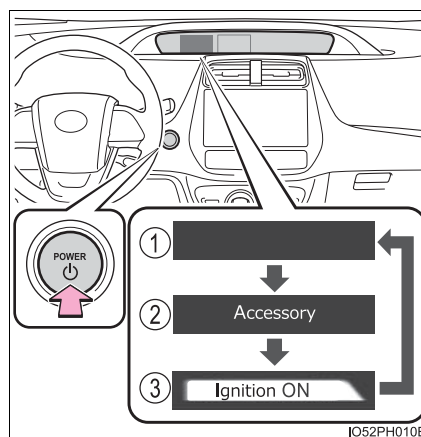

Shift lever operation**■ Starting procedure**

- 1 When the “READY” indicator comes on, shift the shift position to D or R and release it with the brake pedal depressed. The D or R position is selected and the lever returns to its home position. Confirm which position is selected with the shift position indicator in the instrument cluster.
- 2 Release the parking brake and your foot from the brake pedal gradually, and then start the vehicle by depressing the accelerator pedal gently.

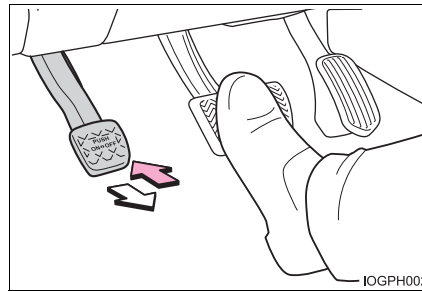
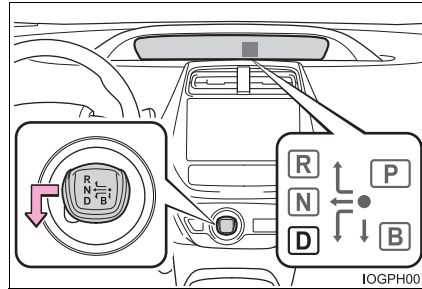
**■ Stopping procedure**

- 1 Stop the vehicle completely by depressing the brake pedal and then apply the parking brake.

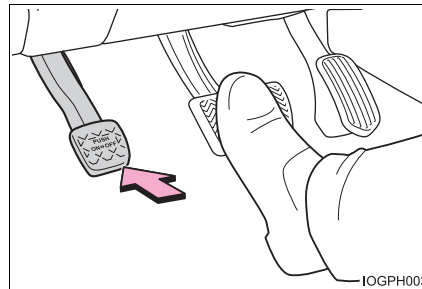

- 2 Shift the shift position to P. Check that the P position is highlighted on the shift position indicator, and release the brake pedal gently after applying the parking brake.

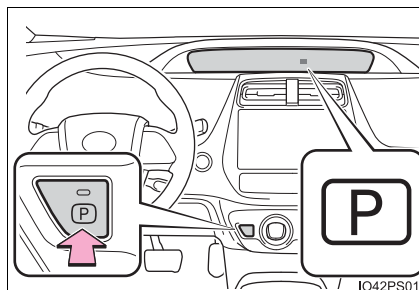

■ About engine braking

When shift position B is selected, releasing the accelerator pedal will apply engine braking.

- When the vehicle is driven at high speeds, compared to ordinary gasoline-fueled vehicles, the engine braking deceleration is felt less than that of other vehicles.
- The vehicle can be accelerated even when shift position B is selected.

If the vehicle is driven continuously in the B position, fuel efficiency will become low. Usually, select the D position.



NOTICE

■ Hybrid battery (traction battery) charge

If the shift position is in N, the hybrid battery (traction battery) will not be charged. To help prevent the battery from discharging, avoid leaving the N position selected for an extended period of time.

How to operate the wipers and washers





Operating the  lever operates the wipers or washer as follows.

■ Intermittent windshield wipers with interval adjuster (if equipped)

► Type A

- ① **OFF** Off
- ② **INT** Intermittent operation
- ③ **LO** Low speed operation
- ④ **HI** High speed operation
- ⑤ **MIST** Temporary operation

► Type B

- ①  Off
- ②  Intermittent operation
- ③  Low speed operation
- ④  High speed operation
- ⑤  Temporary operation

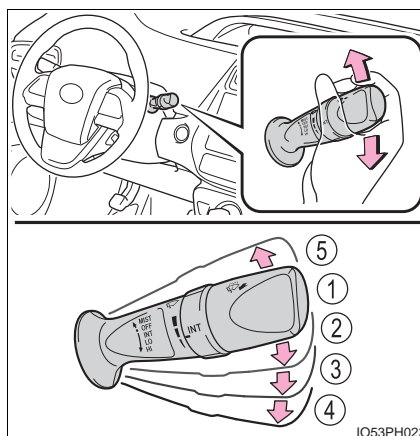

Wiper intervals can be adjusted when intermittent operation is selected.

- ⑥ Increases the intermittent windshield wiper frequency
- ⑦ Decreases the intermittent windshield wiper frequency

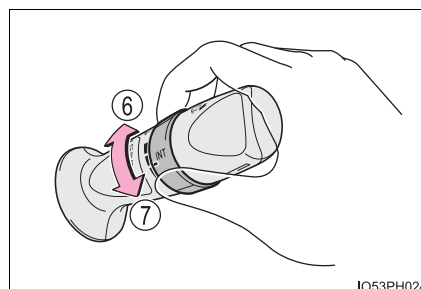

- ⑧  Washer/wiper dual operation

Pulling the lever operates the wipers and washer.

The wipers will automatically operate a couple of times after the washer squirts.

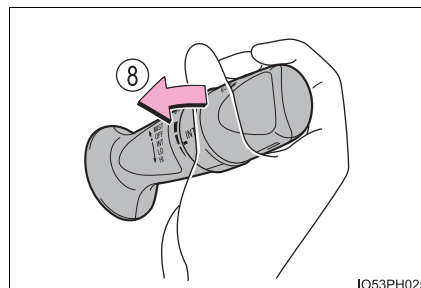

■ Rain-sensing windshield wipers (if equipped)

► Type A

- ① **OFF** Off
- ② **AUTO** Rain-sensing operation
- ③ **LO** Low speed operation
- ④ **HI** High speed operation
- ⑤ **MIST** Temporary operation

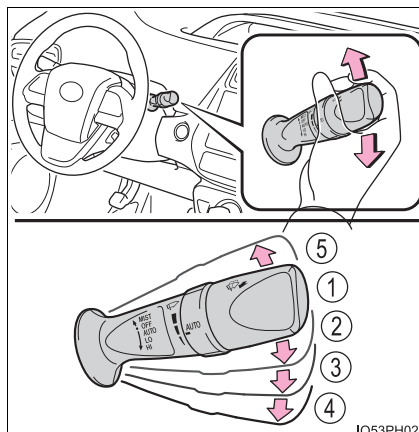

► Type B

- ① **○** Off
- ② **AUTO** Rain-sensing operation
- ③ **▼** Low speed operation
- ④ **▼▼** High speed operation
- ⑤ **△** Temporary operation

When **AUTO** is selected, the wipers will operate automatically when the sensor detects falling rain. The system automatically adjusts wiper timing in accordance with rain volume and vehicle speed.

The sensor sensitivity can be adjusted when **AUTO** is selected.

- ⑥ Increases the sensitivity
- ⑦ Decreases the sensitivity

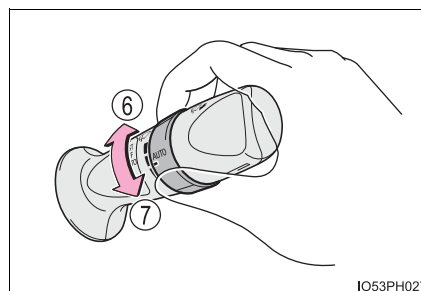

- ⑧  Washer/wiper dual operation

Pulling the lever operates the wipers and washer.

The wipers will automatically operate a couple of times after the washer squirts.

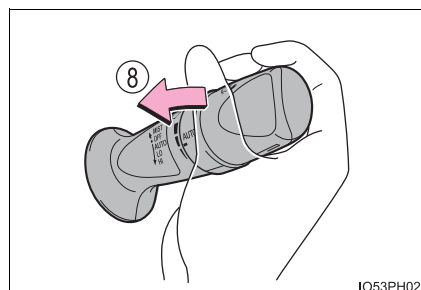

Dynamic radar cruise control operation (vehicle-to-vehicle distance control mode)

■ Set the vehicle speed

- 1 Press the “ON-OFF” button to activate the cruise control.
Radar cruise control indicator will come on and a message will be displayed on the multi-information display.
Press the button again to deactivate the cruise control.

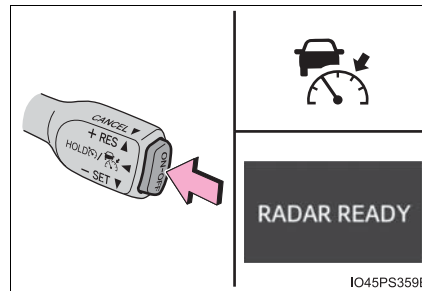

- 2 Accelerate or decelerate, with accelerator pedal operation, to the desired vehicle speed (at or above approximately 30 mph [50 km/h]) and push the lever down to set the speed.

■ Adjusting the set speed

- 1 Increases the speed
(Except when the vehicle has been stopped by system control in vehicle-to-vehicle distance control mode)
- 2 Decreases the speed
Fine adjustment: Momentarily move the lever in the desired direction.

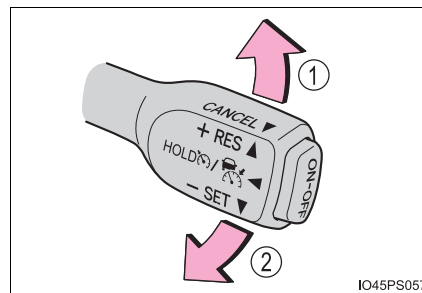

Large adjustment: Hold the lever up or down to change the speed, and release when the desired speed is reached.

■ Canceling and resuming the speed control

- ① Pulling the lever toward you cancels the speed control.

The speed control is also canceled when the brake pedal is depressed.

(When the vehicle has been stopped by system control, depressing the brake pedal does not cancel the setting.)

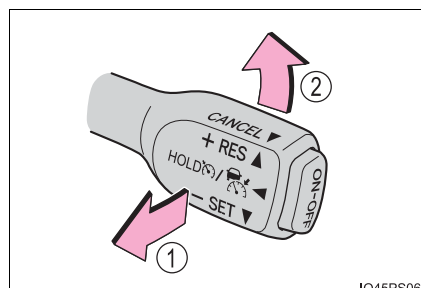

- ② Pushing the lever up resumes the cruise control and returns vehicle speed to the set speed.

However, when a vehicle ahead is not detected, cruise control does not resume when the vehicle speed is approximately 25 mph (40 km/h) or less.

■ Dynamic radar cruise control with full-speed range can be set when

- The shift position is in D.
 - Vehicle speed is at or above approximately 30 mph (50 km/h).
- However, when a preceding vehicle is detected, the dynamic radar cruise control with full-speed range can be set even if the vehicle speed is below approximately 30 mph (50 km/h).

Things you must know

■ Regenerative braking

In the following situations, kinetic energy is converted to electric energy and deceleration force can be obtained in conjunction with the recharging of the hybrid battery (traction battery).

- The accelerator pedal is released while driving with the shift position in D or B.
- The brake pedal is depressed while driving with the shift position in D or B.

■ Gasoline engine operation in EV/EV auto mode

Even if there is a sufficient amount of electricity remaining in the hybrid battery (traction battery) and EV driving range is being displayed on the multi-information display etc., EV driving (driving using only the electric motor) may be canceled and both gasoline engine and electric motor are used depending on the situation (EV driving will be returned to automatically after EV driving becomes possible again).

EV driving may be canceled automatically in the following circumstances:

- When vehicle speed is more than approximately 84 mph (135 km/h).
- When power is needed temporarily, for example when the accelerator pedal is depressed firmly or when accelerating suddenly.*
- When the temperature of the hybrid system is high.
The vehicle has been left in the sun, driven on a hill, driven at high speeds, etc.
- When the temperature of the hybrid system is low.
- When the heater is switched on when the outside temperature is below about 14°F (-10°C).
- When the windshield defogger switch is pressed.
- When the system determines that the gasoline engine needs to be started.

The gasoline engine may also operate in circumstances other than those listed above, depending on conditions.

*: When traveling in the EV auto mode only

■ Conditions in which the gasoline engine may not stop

The gasoline engine starts and stops automatically. However, it may not stop automatically in the following conditions*:

- During gasoline engine warm-up
- During hybrid battery (traction battery) charging
- When the temperature of the hybrid battery (traction battery) is high or low
- When the windshield defogger switch is pressed.

*: Depending on the circumstances, the gasoline engine may also not stop automatically in situations other than those above.

⚠ WARNING**■ While driving**

The driver should pay extra attention to pedestrians when the vehicle is powered only by the electric motor (traction motor). As there is no engine noise, the pedestrians may misjudge the vehicle's movement. Even though the vehicle is equipped with the vehicle proximity notification system, drive with care as pedestrians in the vicinity may still not notice the vehicle if the surrounding area is noisy.

⚠ NOTICE**■ Hybrid battery (traction battery) air intake vents**

There are air intake vents on both sides of the rear seatback for the purpose of cooling the hybrid battery (traction battery). If the vents are blocked, charging/discharging of the hybrid battery (traction battery) may become limited.

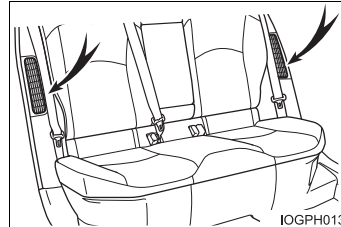

- Make sure not to block the air intake vent with anything, such as a seat cover, plastic cover, or luggage. If the vents are blocked, the charging/discharging of the hybrid battery (traction battery) may become limited.
- When dust etc. has accumulated in the air intake vent, clean it with a vacuum cleaner to prevent the vent from clogging.
- Do not wet or allow foreign substances to enter the air vents as this may cause a short circuit and damage the hybrid battery (traction battery).
- Do not carry large amounts of water such as water cooler bottles in the vehicle. If water spills onto the hybrid battery (traction battery), the battery may be damaged. Have the vehicle inspected by your Toyota dealer.
- A filter is installed to the air intake vent. When the filter remains noticeably dirty even after cleaning the air intake vent, filter cleaning or replacement is recommended. When cleaning the filter, refer to "OWNER'S MANUAL".

**NOTICE**

■ **Charging equipment cooling air intake vents**

The grilles under the rear seats are the cooling air intake vents for the charging equipment installed under the seats.

Make sure to observe the following precautions regarding the cooling air intake vents. Failure to observe these precautions may result in a charging system malfunction.

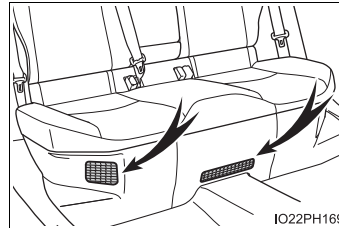

- Do not block the air intake vents with seat covers or luggage
- If the air intake vents are clogged with dust, clean them with a vacuum cleaner
- Do not allow water or foreign matter to enter the air intake vents
- Do not spill large amounts of water near the air intake vents
If water is spilled, have the vehicle inspected by your Toyota dealer and do not charge the hybrid battery (traction battery) before the inspection.

■ **Notice about fuel**

- For plug-in hybrid vehicles, fuel may remain in the tank for a long time and undergo changes in quality depending on the how the vehicle is used. Refuel at least 5.3 gal.(20 L, 4.4 Imp.gal.) of fuel every 12 months (refuel a total of at least 5.3 gal. [20 L, 4.4 Imp.gal.] over a 12-month period), as this may affect components of the fuel system or the gasoline engine.
- If the vehicle has not been refueled for a certain amount of time and it is possible that the quality of the fuel remaining in the tank has changed, "No new fuel has been added recently. Please refuel" is displayed on the multi-information display when the power switch is turned to ON mode. If the message is displayed, refuel the vehicle immediately.