

Prius
Plug-in Hybrid
2 0 2 6

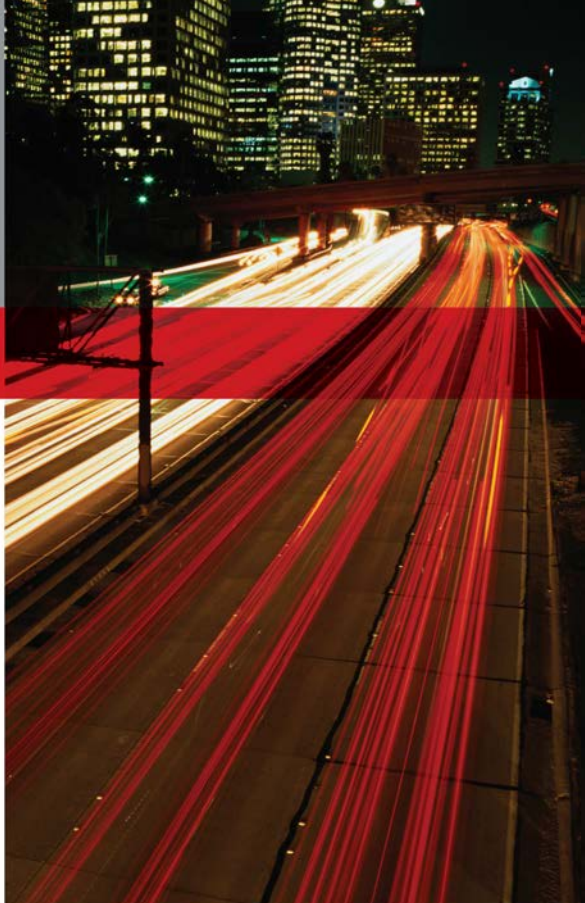

OWNER'S MANUAL
QUICK GUIDE



1	Plug-in hybrid system	
2	Charging operation	
3	Things you must know	

The quick guide is not intended as a substitute for your “OWNER’S MANUAL”. We strongly encourage you to review the “OWNER’S MANUAL” and supplementary manuals so you will have a better understanding of your vehicle’s capabilities and limitations.

Depending on specifications, the vehicle shown in the illustration may differ from your vehicle in terms of equipment.

Plug-in hybrid system features

The plug-in hybrid system is a system excellent in both economical efficiency of electric vehicles and practicality of Plug-in Hybrid Electric Vehicles

- EV driving can be performed using electricity charged from an external power source.*
- If the amount of electricity remaining in the hybrid battery (traction battery) becomes low, the vehicle is automatically controlled in such a way that it can be driven as a Plug-in Hybrid Electric Vehicle through the joint use of the gasoline engine.

*: The EV driving range will vary in accordance with conditions such as vehicle speed, the amount of charge remaining in the hybrid battery (traction battery) and the usage of the air conditioning system. The gasoline engine may also be used simultaneously in accordance with driving conditions.

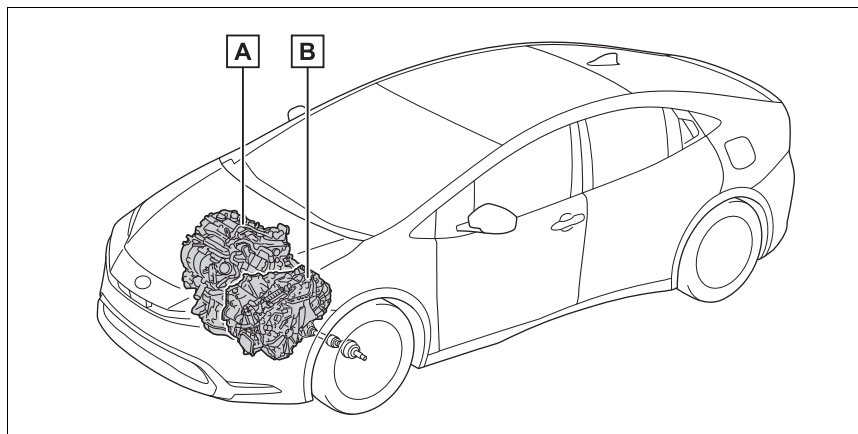

The illustration is an example for explanation and may differ from the actual item.

- A** Gasoline engine
- B** Electric motor (traction motor)

Types of charging methods

■ AC charging

This is a charging method used when charging from an AC socket with the AC charging cable or charging that use an AC charger.

By setting charging schedule, it is also possible to charge at the desired date and time.

Plug-in hybrid system operation mode

■ EV mode

When a sufficient amount of electricity is remaining after charging, EV driving is performed using electricity stored in the hybrid battery (traction battery).

When in EV mode, the EV drive mode indicator illuminates.

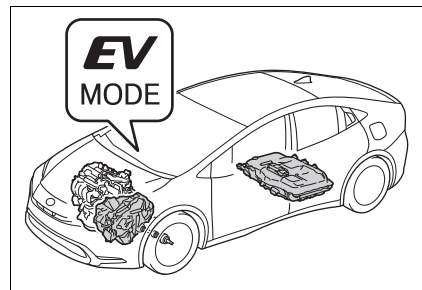

■ AUTO EV/HV mode

Normally, the electricity stored in the hybrid battery (traction battery) is used for EV driving. However, when more power is required, such as for driving uphill or accelerating suddenly, the gasoline engine starts and provides powerful acceleration by strongly depressing the accelerator pedal.

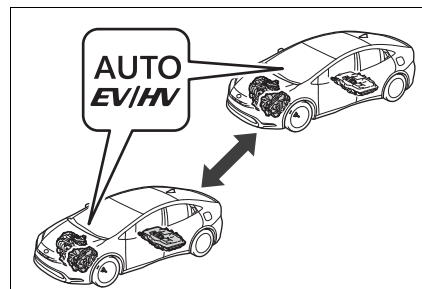

When the vehicle is in a condition where EV driving is possible, EV mode and AUTO EV/HV mode can be switched by operating the switch.

When in AUTO EV/HV mode, the AUTO EV/HV mode indicator illuminates.

■ HV mode

When in HV mode, the vehicle is driven using both the gasoline engine and electric motor.

- If electricity needed for EV driving in EV mode or AUTO EV/HV mode is not remaining, the operation mode will be automatically switched to HV mode.

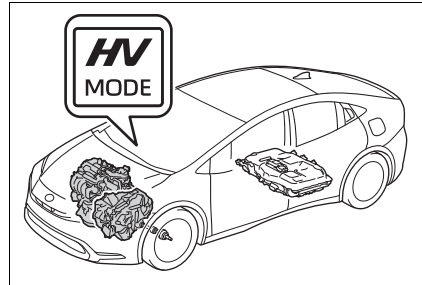

- The operation mode can be switched to HV mode at any timing by operating the switch to keep electricity for EV driving etc. Switching to HV mode when driving on a highway or when driving uphill is recommended in order to conserve battery power.

When in HV mode, the HV drive mode indicator illuminates.

Plug-in hybrid system operation mode selection switches

The plug-in hybrid system operation modes can be switched using the switches.

Switching the plug-in hybrid system operation modes

Press the AUTO EV/HV mode switch or EV/HV mode selection switch to change modes as the following table shows.

When in EV mode, the EV drive mode indicator illuminates.

When in AUTO EV/HV mode, the AUTO EV/HV mode indicator illuminates.

When in HV mode, the HV drive mode indicator illuminates.

- ▶ AUTO EV/HV mode switch
- ▶ EV/HV mode selection switch

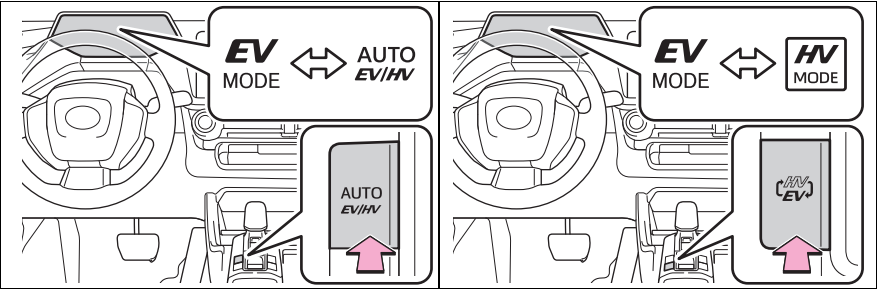

Current mode	Mode after switching
EV mode	AUTO EV/HV mode
AUTO EV/HV mode	EV mode
HV mode	AUTO EV/HV mode*

*: If there is not enough charge remaining in the hybrid battery (traction battery) to allow EV driving, AUTO EV/HV mode will not be selectable.

Current mode	Mode after switching
EV mode	HV mode
AUTO EV/HV mode	HV mode
HV mode	EV mode*

*: If there is not enough charge remaining in the hybrid battery (traction battery) to allow EV driving, EV mode will not be selectable.

■ If the plug-in hybrid system operation mode cannot be changed

When electricity needed for EV driving is not remaining (when in EV mode or AUTO EV/HV mode), the plug-in hybrid system operation mode cannot be changed even if the AUTO EV/HV mode switch or EV/HV mode selection switch is pressed. (In this case, the warning message is displayed on the multi-information display when the switch is pressed.)

■ When switching from EV mode to another mode using the switch

When the power switch is turned off, operation mode switching is canceled and the system returns to EV mode the next time the vehicle is started.*

*: If there is not enough charge remaining in the hybrid battery (traction battery) to allow EV driving, the system switches to HV mode.

Acoustic Vehicle Alerting System

When driving with the gasoline engine stopped, a sound, which changes in accordance with the driving speed, will be played in order to warn people nearby of the vehicle's approach.

The sound will stop when the vehicle speed exceeds approximately 22 mph (35 km/h).

Charging equipment

Charging equipment and names

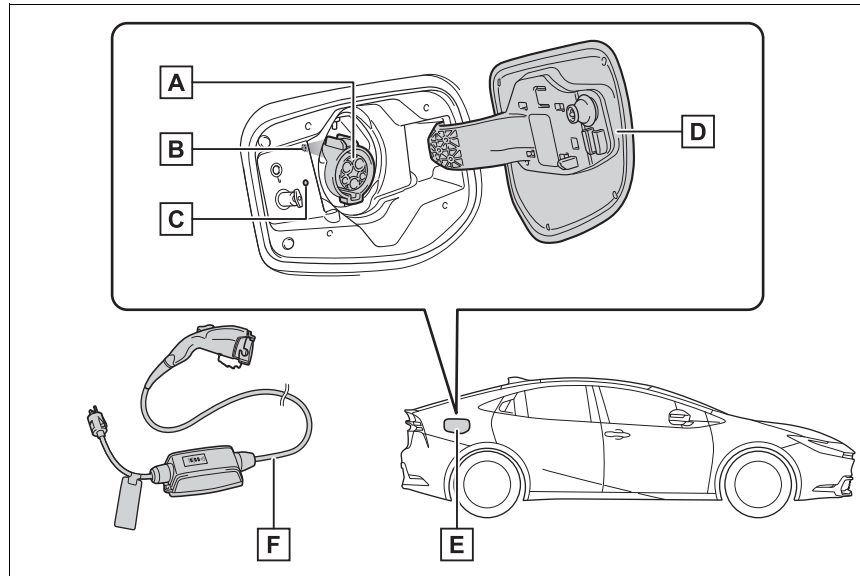

- | | |
|----------------------------------|---|
| A AC charging inlet | D Charging port lid |
| B AC charging inlet light | E Charging port |
| C Charging indicator | F AC charging cable (if equipped)* |

*: Vehicles without AC charging cable: For proper handling and precautions for the AC charging cable, refer to the owner's manual that comes with it.

AC charging cable (if equipped)

■ The names of each part of the AC charging cable

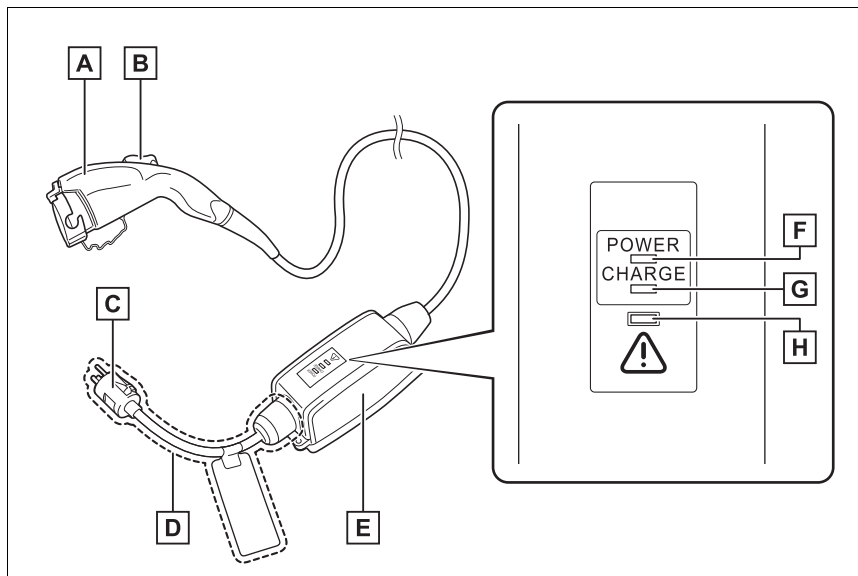

- | | |
|--|----------------------------------|
| A Charging connector | F Power indicator |
| B Latch release button | G Charging indicator |
| C Plug | H Error warning indicator |
| D Plug-cord | |
| E CCID (Charging Circuit Interrupting Device) | |

■ Safety functions

The CCID (Charging Circuit Interrupting Device) has the following safety features.

● Electrical leakage detection function

If an electrical leakage is detected during charging, the power source will be automatically interrupted, thus preventing fires or electrical shocks caused by electrical leakage.

● Automatic check function

This is an automatic system check that is run before charging begins to check for problems in the operation of the electrical leakage detection function.

● Temperature detection function

A temperature detection function is equipped to the plug. While charging, if heat is generated due to looseness on the socket side etc., this function suppresses heat by controlling the charging current.

● Conditions for supplying current to the vehicle

The CCID (Charging Circuit Interrupting Device) is designed to prevent electrical current from being supplied to the charging connector when it is not connected to the vehicle, even if the plug is inserted into the socket.

■ Safety functions

- The hybrid system will not start while the AC charging cable is attached to the vehicle, even if the power switch is operated.
- If the AC charging cable is connected while the "READY" indicator is illuminated, the hybrid system will stop automatically and driving will not be possible.

WARNING

■ Power sources precautions

Observe the following precautions.

If you do not follow them, fire, electrical shock or damage may occur, possibly resulting in death or serious injury.

- Connect to an AC 120 V socket (NEMA 5-15R) with a Ground-Fault Circuit-Interrupter (GFCI) and supplied by a circuit breaker per your local code. Use of a 15A individual circuit is strongly recommended.

- Do not connect the AC charging cable to a power strip, multiple electrical socket adapter or conversion plug.

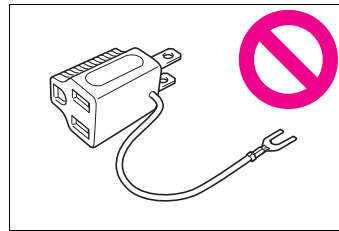

- Connecting the AC charging cable to an extension cord is strictly prohibited. The extension cord may overheat and does not contain a Ground-Fault Circuit-Interrupter (GFCI). The leakage detection function of the CCID (Charging Circuit Interrupting Device) (→P. 9) may not operate correctly.

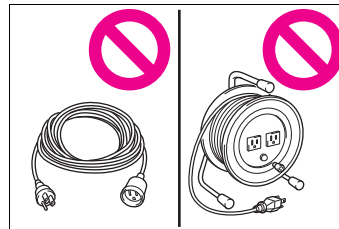

- Do not connect to a branch electrical socket.

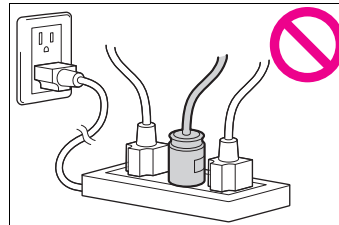

- Use of a block heater for charging is prohibited.

Opening/closing the charging port lids**■ Open**

Slightly open the charging port lid by pressing the rear edge of it. (the position shown in the illustration)

Fully open the charging port lid by hand.

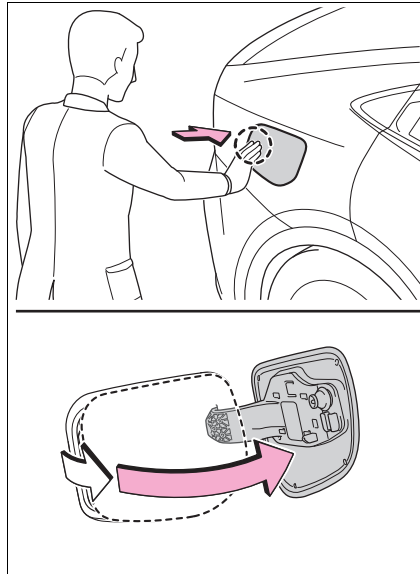

2

Charging operation

■ Close

Move the charging port lid to the slightly open position and then press the rear edge (the position shown in the illustration) to close it.

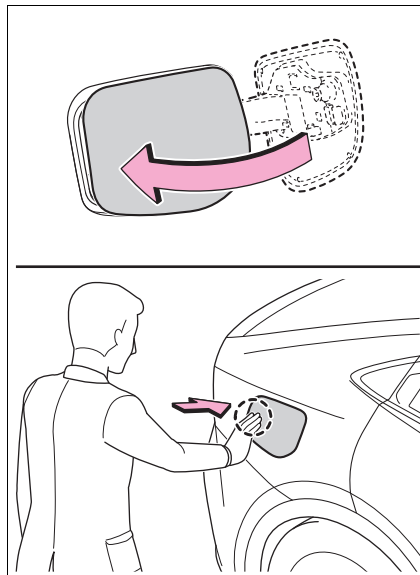

Charging indicator

The illumination/flashing pattern changes to inform the user of the charging status.

For details about charging indicator, refer to "OWNER'S MANUAL".

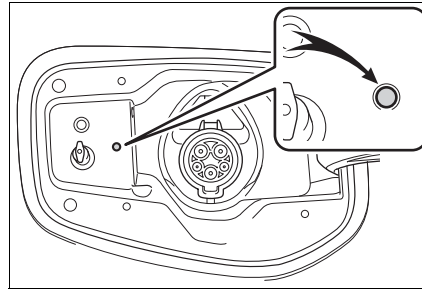

How to use AC charging



WARNING

■ Charging precautions

This vehicle has been designed to allow charging from an external power source using an AC charging cable for exclusive use with standard household AC sockets. However, the vehicle differs greatly from standard household electrical goods in the following ways, and incorrect usage could cause fire or electric shock, possibly leading to death or serious injury.

- When charging, a large amount of current will flow for a long time.
- Depending on the charging environment, perform charging outdoors.



NOTICE

■ Charging precautions

To charge properly, follow the procedure after reading the explanation below. Charging is intended to be carried out by licensed drivers only who properly understand the charging procedure.

- Do not allow people who is not used to charging, such as children, to perform charging without supervision.

Vehicles with AC charging cable: Also, keep the AC charging cable out of reach of infants.

- When charging with an AC charger, follow the procedures for using each charger.

Confirm the following before charging

Before charging, always check the following items.

- The parking brake is applied.
- The power switch is turned to OFF.
- Lights such as the headlights, emergency flashers and interior lights etc. are turned off.

If these light switches are turned on, then these features will consume electricity, and charging time will increase.

■ During charging

- The charging starting time may differ depending on the state of the vehicle, but this does not indicate a malfunction.
- Cooling fan sounds may be heard from near the luggage compartment.
- During charging, sounds may be heard from near the hybrid battery (traction battery) in accordance with the operation of the air conditioning system or "Battery Cooler".
- During and after charging, the luggage compartment and its surrounding area in which the onboard traction battery charger is installed may get warm.
- Vehicles with AC charging cable: The surface of the CCID (Charging Circuit Interrupting Device) may become hot, but this does not indicate a malfunction.
- Depending on radio wave conditions, interference may be heard on the radio.

■ When charging using a public charging facility, check the setting of the charging schedule function.

- When the charging schedule is registered, temporarily turn off the function or turn "Charge Now" on.
- When the charging schedule is set to on, charging will not start even if the AC charging cable is connected. Also, charging fee may occur due to connection of the AC charging cable.

When charging

- 1 Prepare the AC charging cable.
- 2 Insert the plug of the AC charging cable into the electrical socket of the external power source.

Make sure to hold the body of the plug and insert it firmly into the socket.

When the remote switch is equipped, turn it on.

Vehicles with AC charging cable: Check that the power indicator on the CCID (Charging Circuit Interrupting Device) is illuminated.

Vehicles with AC charging cable: In order to reduce the load on the socket and plug, when inserting the plug, use a string, etc. to hang the CCID (Charging Circuit Interrupting Device) on a hook or equivalent.

- 3 Open the charging port lid.

The charging inlet light **A** will illuminate.

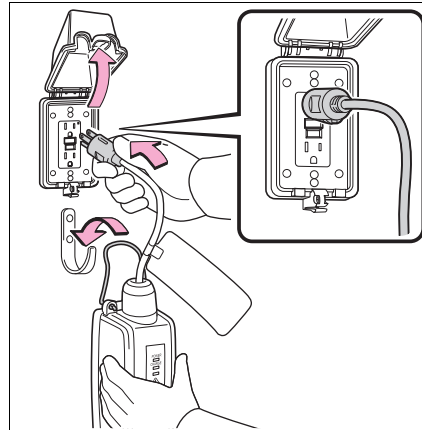

2

Charging operation

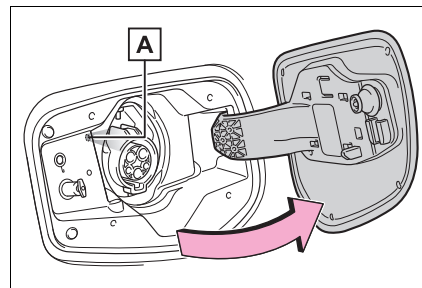

- 4 Vehicles with AC charging cable: Remove the charging connector cap and secure it to the cable.

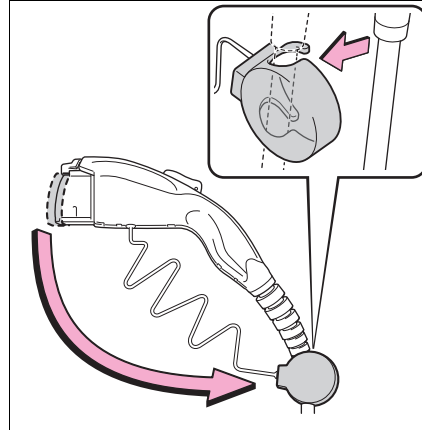

- 5 Insert the charging connector into the AC charging inlet.

Align the guide position on the bottom of the charging connector, and push the charging connector straight into the AC charging inlet as far as possible.

Once a click sound is heard, check that the charging connector is securely locked.

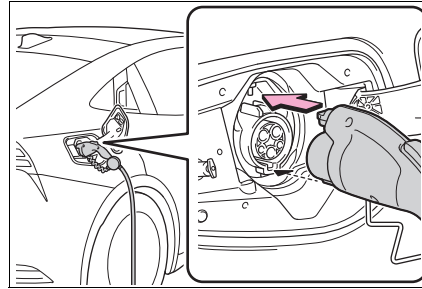

If the doors are locked, the AC charging connector is locked.

If the AC charging connector is inserted with the doors locked, it is automatically locked.

- 6 Confirm that the charging indicator of the charging port is illuminated.

Charging will not start if the charging indicator does not illuminate when the charging connector is inserted.

If the charging indicator is flashing, the charging schedule is registered. (→P. 24)

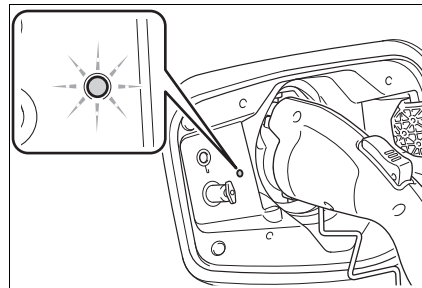

Vehicles with AC charging cable: If the error warning indicator on the CCID (Charging Circuit Interrupting Device) flashes during charging, refer to "OWNER'S MANUAL" and follow the correction procedure.

The charging indicator will turn off when charging is completed.

The charging indicator will also turn off when charging is stopped for some reason before completion. In this case, refer to "OWNER'S MANUAL".

■ Safety function

If the latch release button is pressed, charging will not begin even if the AC charging cable is connected.

Also, charging will be stopped if the latch release button is pressed and held for several seconds during charging. When restarting charging, reinsert the charging connector after pulling it out, and check that the charging indicator of the charging port illuminates.

2

Charging operation

After charging

- 1 Unlock the doors to unlock the charging connector.

The charging inlet light will illuminate when the doors are unlocked.

- 2 Pull the charging connector towards you while pressing the latch release button.

If the latch release button is pressed during charging (while the charging indicator is illuminated), charging will be interrupted.

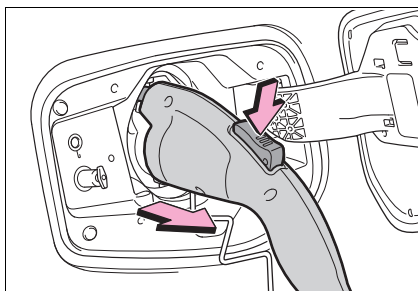

- 3 Vehicles with AC charging cable: Attach the charging connector cap.

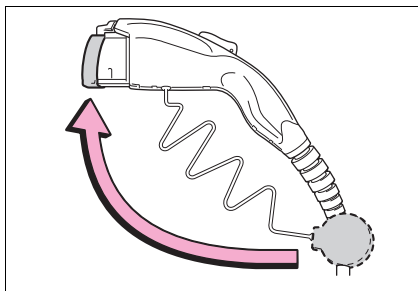

- 4 Close the charging port lid.

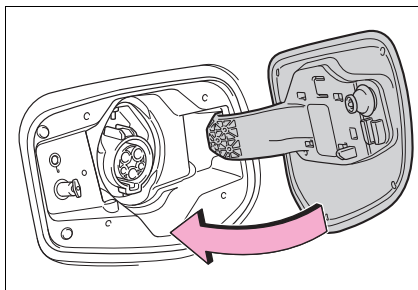

- 5 Vehicles with AC charging cable: Remove the plug from the socket when the charging equipment will not be used for a prolonged period of time.

Hold the body of the plug when removing.

Make sure to put the cable away immediately after disconnecting.

When leaving the plug inserted, inspect the plug and connector once a month to check if dirt or dust has accumulated.

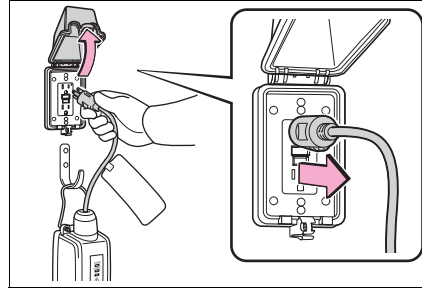

2

Charging operation

**WARNING****■ When charging**

Observe the following precautions.

Failure to do so may cause an unexpected accident, resulting in death or serious injury.

- Vehicles with AC charging cable: Connect to a power source suitable for charging.
- Vehicles with AC charging cable: Check that the AC charging cable, plug and socket are free of foreign matter.
- Before charging, check that the AC charging inlet is not deformed, damaged or corroded, and check that the inlet is free of foreign matter such as dirt, snow and ice.
If there is dirt or dust in these areas, remove completely before inserting the charging connector.
- Vehicles with AC charging cable: Only use sockets where the plug can be securely inserted.
- Vehicles with AC charging cable: Do not bundle or wind the AC charging cable while charging, as doing so may result in overheating.
- Do not touch the terminals of the charging connector and AC charging inlet with a sharp metal objects (needles etc.) or hands, or short them with foreign objects.
- Vehicles with AC charging cable: When charging outdoors, make sure to connect to a rain-tight socket for outdoor use. Ensure the rain-tight cover closes completely. If the rain-tight cover cannot be closed, install a rain-tight cover that will close.
- In order to stop charging at the charging station, follow the instructions of the AC charger.
- If any heat, smoke, odors, noise or other abnormalities are noticed during charging, stop charging immediately.
- Vehicles with AC charging cable: Do not insert the plug if the socket is submerged in water or snow.
- Vehicles with AC charging cable: When charging while it is raining or snowing, do not connect or disconnect the plug if your hands are wet. Also, do not get the plug or socket wet.
- Do not charge the vehicle during a lightning storm.
- Prevent the AC charging cable from being caught in the door or back door.
- Vehicles with AC charging cable: Do not let the wheels on the AC charging cable, plug, charging connector and CCID (Charging Circuit Interrupting Device).
- Vehicles with AC charging cable: Firmly insert the plug into the socket.
- Do not connect conversion adapters between the AC charging connector and AC charging inlet.

**WARNING**

■ **When charging**

- Make sure to connect the AC charging cable to a socket within reach and do not use an extension cord.
- Close the hood before using the charging system. The cooling fan may start operating suddenly. Touching or getting close to rotating parts such as the fan may cause your hands or clothes (especially a necktie or scarf) to become caught and result in a serious injury.
- Vehicles with AC charging cable: After connecting the AC charging cable, confirm that it is not wound around anything.
- Vehicles with AC charging cable: If the power indicator on the CCID (Charging Circuit Interrupting Device) does not illuminate after plugging the AC charging cable into the socket, unplug it immediately.

■ **After charging (vehicles with AC charging cable)**

Remove the plug if it will not be used for a long time.
Dirt and dust may accumulate on the plug or socket, which could cause a malfunction or fire, possibly leading to death or serious injury.

■ **Onboard traction battery charger**

The onboard traction battery charger is located under the luggage compartment. Make sure to observe the following precautions regarding the onboard traction battery charger. Failure to observe these precautions may result in death or serious injury such as burns and electric shocks.

- The onboard traction battery charger is hot during charging. Do not touch the onboard traction battery charger, as doing so may result in burns.
- Do not disassemble, repair or modify the onboard traction battery charger. When the onboard traction battery charger needs to be repaired, consult your Toyota dealer.

**NOTICE****■ When using the AC charging related parts**

To prevent damage to the AC charging related parts, observe the following precautions.

- Vehicles with AC charging cable: When interrupting or canceling charging, remove the charging connector before removing the plug.
- When removing the AC charging cable, check that the charging connector is unlocked.
- Vehicles with AC charging cable: Do not forcefully pull the AC charging connector cap.
- Do not apply a vibration to the charging connector while charging. Charging may be stopped.
- Do not insert anything but the charging connector into the AC charging inlet.
- Vehicles with AC charging cable: When inserting the plug into or removing the plug from the socket, make sure to hold the body of the plug.
- Vehicles with AC charging cable: Do not forcefully pull the AC charging cable that is caught or entangled.
If the cable is entangled, disentangle it before using.
- Do not disassemble, repair or modify the AC charging inlet.
When the AC charging inlet needs to be repaired, consult your Toyota dealer.

■ When charging

Do not insert the plug into the AC charging inlet.
The AC charging inlet may be damaged.

■ After charging

- Vehicles with AC charging cable: Store the AC charging cable out of reach from infants and children.
- Vehicles with AC charging cable: After removing the plug from the socket, keep it in a safe place free from moisture and dust.

The AC charging cable or plug may be damaged if the cable is stepped on or ridden over by the vehicle.

- After removing the AC charging connector from the AC charging inlet, make sure to close the charging port lid.

If the charging port lid is left open, water or foreign objects may enter the AC charging inlet, which could lead to vehicle damage.

**NOTICE****■ Using private power generator**

Do not use private power generators as a power source for charging. Doing so may make charging unstable, the voltage may be insufficient, and the charging operation may stop.

Noise may be heard from around the luggage compartment, even if charging can be continued.

■ Charging station

Due to the environment in which the power equipment is located, charging may be unstable due to noise, the voltage may be insufficient, and the charging operation may stop.

Using the charging schedule function

Charging schedule function

AC charging can be carried out at the desired time by registering the charging schedule.

When registering the charging schedule, the following settings can be changed.

- Select the charging mode (“Start” or “Start at set time”/“Start-Stop” or “Start and stop at set times”)
- Repeated setting
- Turning “Charge Now” on and off
- “Next Event”

For details of each settings, refer to “OWNER’S MANUAL”.

The charging schedule can be registered on the multi-information display or Multimedia Display.



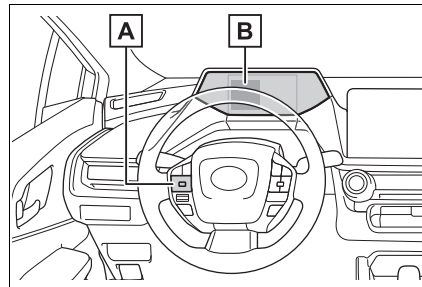

Setting operations on multi-information display

When operating charging schedule, use the meter control switches.

- A** Meter control switches
- B** Multi-information display



■ Display the “Charging Schedule” screen

- 1 Select .
- 2 Select  “Vehicle Settings” and then press and hold .
- 3 Select “Charging Settings” and then press .

The “Charging Settings” display will be displayed.

- 4 Select “Charging Schedule” and then press .

The “Charging Schedule” display will be displayed.

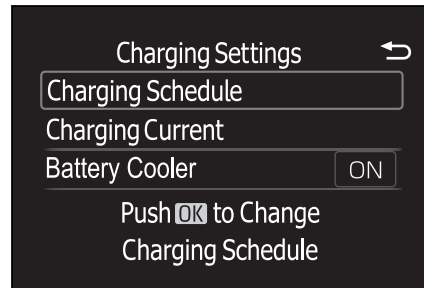

2

Charging operation

■ Registering the charging schedule

- 1 Display the “Charging Schedule” screen.
- 2 Select “Scheduled Events” and then press .

The “Scheduled Events” display will be displayed.

For information about setting of the items other than “Scheduled Events”, refer to “OWNER’S MANUAL”.

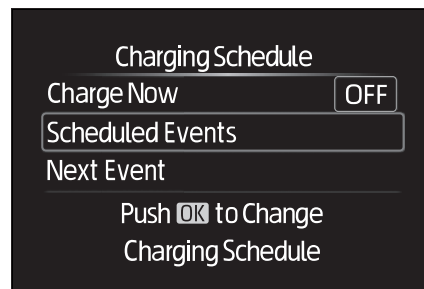

- 3 Select "add" and then press



The "Charging Mode" display will be displayed.

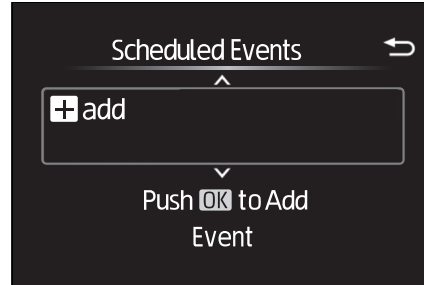

- 4 Operate the meter control switches to select the item and change the setting.

For details about the item, refer to "OWNER'S MANUAL".

After setting operations are complete, when the AC charging connector is connected to the vehicle, charging will be carried out according to the charging schedule settings.

■ Changing the registered charging schedules

The registered charging schedules can be modified or deleted.

- 1 Display the "Charging Schedule" screen. (→P. 25)

- 2 Select "Scheduled Events" and then press

A list of the registered charging schedule will be displayed.

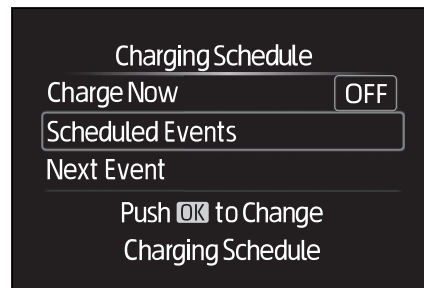

- 3 Select the item and change the setting.

For details about the item, refer to "OWNER'S MANUAL".

Setting operations on the Multimedia Display

Setting operations related to the charging schedule are performed on the “Charging schedule” screen.

■ Displaying the “Charging schedule” screen

- 1 Turn the power switch to ON.

It is not possible to control the Charging Schedule settings in Accessory Mode.

- 2 Touch  on the main menu, then touch “Charging schedule” on the sub menu.

The “Charging schedule” screen will be displayed.

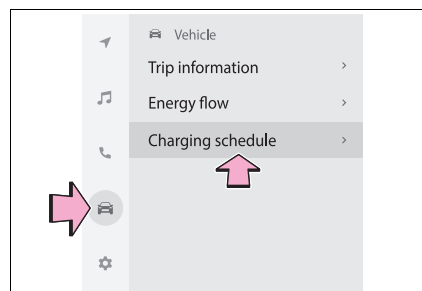

2

Charging operation

For details of “Charging schedule” screen, refer to “OWNER’S MANUAL”.

■ Registering the charging schedule

- 1 Display the “Charging schedule” screen.
- 2 Touch “Add”.

The “Add event” screen will be displayed on the screen.

- 3 Select the charging mode.

Touch the button in the row of the “Start at set time” or “Start and stop at set times”.

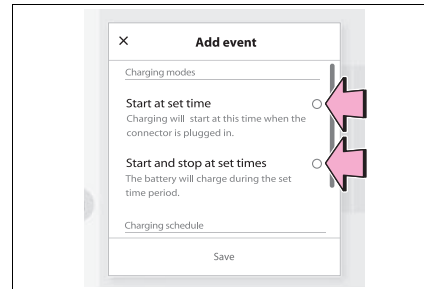

- 4 Touch buttons on the screen, operate the screen and select desired time, and then touch “OK”.

When the charging mode is “Start at set time”, set the charging start time.

When the charging mode is “Start and stop at set times”, also set the charging stop time.

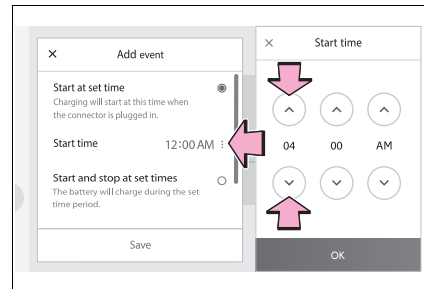

- 5 Touch “Repeat”, and touch the desired day to activate the repeated setting, and then touch “OK”.

Each time the day is touched, the repeated setting for the selected day switches between on and off.

When turned on, the check box is highlighted and the charging schedule is repeated on that day. It is possible to turn more than one day on.

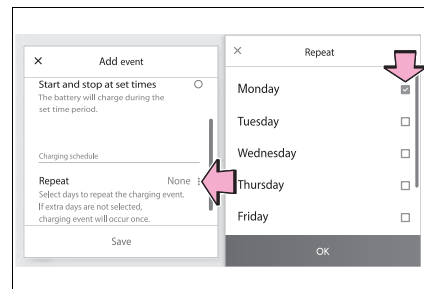

- 6 After setting operations are complete, touch “Save”.

The charging schedule is added to the list and an icon is added to the “Charging schedule” screen.

■ Changing the registered charging schedules

- 1 Display the “Charging schedule” screen.
- 2 Touch “Edit”.

The “Events” screen will be displayed on the screen.

- 3 Touch “Edit” on the “Events” screen.

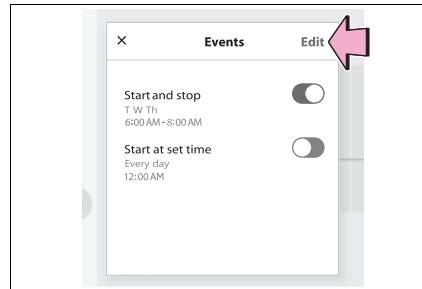

- 4 From the items displayed on the screen, touch the charging schedule you wish to change.

2

Charging operation

Charging tips

Checking information related to charging

Information related to charging is displayed and can be checked on the multi-information display.

■ While charging

When any door is opened during charging with the power switch off, the current charging condition and approximate time remaining until charging is complete are displayed for a certain period of time.

The actual charging time may differ depending on conditions such as the remaining capacity of the traction battery, outside temperature, and specifications of the AC charger.

The time until charging completed may not be displayed if the charging current to the traction battery becomes smaller and the charging time becomes longer.

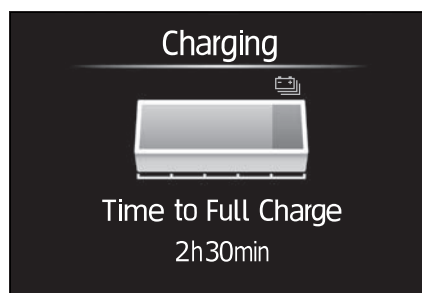

■ After charging is complete

When any door is opened with the power switch off after charging is complete, a message detailing the results of the charging is displayed for a while. Also, a message is displayed if an operation that stops charging is performed or a situation where charging cannot be performed occurs.

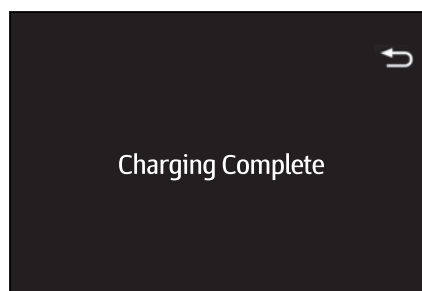

Inspecting and maintaining the AC charging cable

For safety, inspect the AC charging cable on a routine basis.



WARNING

■ Routine inspection

Check the following points regularly.

Failure to do so may cause an unexpected accident, resulting in death or serious injury.

- The AC charging cable, plug, charging connector, CCID (Charging Circuit Interrupting Device) etc. have not been damaged.
- The socket has not been damaged.
- The plug can be securely inserted into the socket.
- The plug does not get extremely hot during use.
- The tip of the plug has not been deformed.
- The plug is not dirtied by dust etc.

Remove the plug from the socket before inspecting it. If any abnormalities are found in the AC charging cable as a result of the inspection, immediately stop use and consult your Toyota dealer.

■ Maintaining the AC charging cable

When the AC charging cable is dirty, first remove the dirt with a hard, wringed cloth, and then wipe the cable with a dry cloth.

However, never wash it with water. If the AC charging cable is washed with water, fire or electric shock may occur during charging, possibly resulting in death or serious injury.

■ When not using the AC charging cable for a long time



Remove the plug from the socket. Dust could accumulate on the plug or in the socket, possibly causing overheating which could lead to a fire.

Also, keep the cable in a place free from moisture.

Using the "My Room Mode"

When the AC charging cable is connected to the vehicle, electrical components such as the air conditioning system or audio system can be used using the external power source.

Starting "My Room Mode"

- 1 Connect the AC charging cable to the vehicle and start charging
- 2 Turn the power switch on during charging
The setting screen of "My Room Mode" is displayed automatically on the multi-information display.
- 3 Select "YES" and then press .
"My Room Mode" starts and systems such as the air conditioning system and audio system can be used inside the vehicle.
When not using "My Room Mode", select "NO", and then press .
To stop "My Room Mode", turn the power switch off.

■ While using “My Room Mode”

Any of the following may occur.

- When the remaining charge of the hybrid battery (traction battery) reaches the lower limit, the air conditioning system automatically turns off.
In this situation, the air conditioning system cannot be used until the remaining charge of the hybrid battery (traction battery) increases. Turn the power switch off and use “My Room Mode” after the remaining charge of the hybrid battery (traction battery) is restored.
- When the outside temperature is low, the heater output may be limited due to the air conditioning system operation being restricted.
- Warning lights and indicators such as electric power steering system warning light (yellow) and malfunction indicator lamp may turn on, but this is not a malfunction.
Also, when the headlight switch is in the AUTO position (if equipped) and the surrounding area is dark, the headlights are turned on.

Things you must know

■ Regenerative braking

- In the following situations, kinetic energy is converted to electric energy and deceleration force can be obtained in conjunction with the recharging of the hybrid battery (traction battery).
 - The accelerator pedal is released while driving with the shift position in D or B.
 - The brake pedal is depressed while driving with the shift position in D or B.

■ Gasoline engine operation in EV mode or AUTO EV/HV mode

Even if there is a sufficient amount of electricity remaining in the hybrid battery (traction battery) and EV driving range is being displayed on the meter, EV driving (driving using only the electric motor) may be canceled and both gasoline engine and electric motor are used depending on the situation (EV driving will be returned to automatically after EV driving becomes possible again).

EV driving may be canceled automatically in the following circumstances^{*1}:

- When vehicle speed is more than approximately 84 mph (135 km/h).
- When power is needed temporarily, for example when the accelerator pedal is depressed firmly or when accelerating suddenly.^{*2}
- When the temperature of the hybrid system is high.
The vehicle has been left in the sun, driven on a hill, driven at high speeds, etc.
- When the temperature of the hybrid system is low.
- When the heater is switched on when the outside temperature is below about 14°F (-10°C).
- When the windshield defogger switch is pressed.
- When the system determines that the gasoline engine needs to be started.

^{*1}: The gasoline engine may also operate in circumstances other than those listed above, depending on conditions.

^{*2}: When driving in AUTO EV/HV mode. Even in EV mode, the gasoline engine may start, depending on the condition of the hybrid battery (traction battery).

■ Conditions in which the gasoline engine may not stop

The gasoline engine starts and stops automatically. However, it may not stop automatically in the following conditions*:

- During gasoline engine warm-up
- During hybrid battery (traction battery) charging
- When the temperature of the hybrid battery (traction battery) is high or low
- When the windshield defogger switch is pressed.

*: Depending on the circumstances, the gasoline engine may also not stop automatically in situations other than those above.

 **WARNING****■ While driving**

The driver should pay extra attention to pedestrians when the vehicle is powered only by the electric motor (traction motor). As there is no engine noise, the pedestrians may misjudge the vehicle's movement. Even if the Acoustic Vehicle Alerting System is operating, drive with care as pedestrians in the vicinity may still not notice the vehicle if the surrounding area is noisy.

 **NOTICE****■ Notice about fuel**

- For Plug-in Hybrid Electric Vehicles, fuel may remain in the tank for a long time and undergo changes in quality depending on how the vehicle is used. Refuel at least 5.3 gal. (20 L, 4.4 Imp.gal.) of fuel every 12 months (refuel a total of at least 5.3 gal. [20 L, 4.4 Imp.gal.] over a 12-month period), as this may affect components of the fuel system or the gasoline engine.
- If the vehicle has not been refueled for a certain amount of time and it is possible that the quality of the fuel remaining in the tank has changed, "No New Fuel has been Added Recently Please refuel" is displayed on the multi-information display when the power switch is turned to ON. If the message is displayed, refuel the vehicle immediately.

