

# Introduction

## CONFIRMING DISPLAY AUDIO MODEL

This manual is made up of 2 sections.

The first describing available functions for models without navigation capabilities (WITHOUT NAVIGATION) such as audio and hands-free.

The second describing available functions for models with navigation capabilities (WITH NAVIGATION) such as navigation, audio, and hands-free.

For models that do not have navigation capabilities, refer to the “WITHOUT NAVIGATION” section. For models that have navigation capabilities, refer to the “WITH NAVIGATION” section.

Navigation capabilities	Reference
Not installed	WITHOUT NAVIGATION (1ST SECTION only)
Installed	WITH NAVIGATION (2ND SECTION only)

## EXISTENCE OF NAVIGATION CAPABILITIES

Existence of navigation capabilities can be confirmed by performing the following:

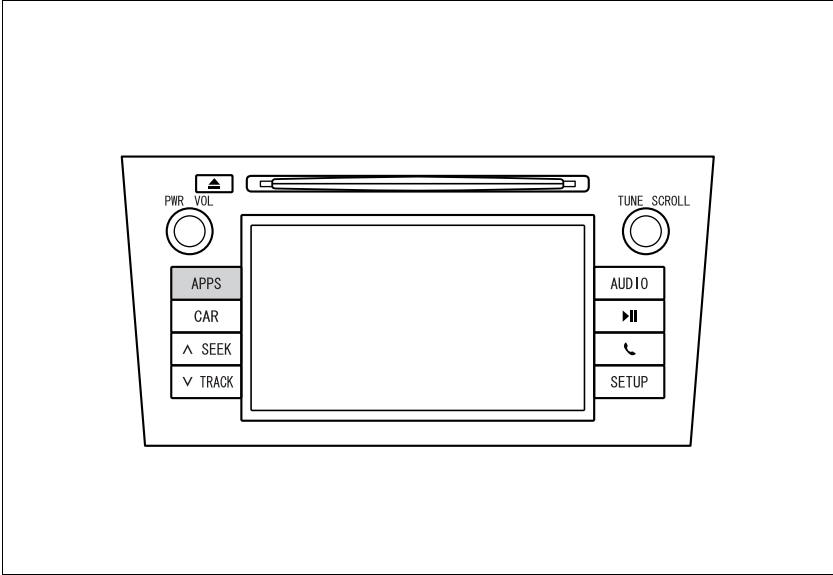

- 1 When the ignition switch is turned to the “ACC” or “ON” position, the initial screen will be displayed and the system will begin operating.
- 2 Press the “APPS” button.
  - Either of the following screens will be displayed.
  - If your system does not have the “APPS” button, the Display Audio system does not have navigation capabilities, refer to the “WITHOUT NAVIGATION” section.

► Screen A

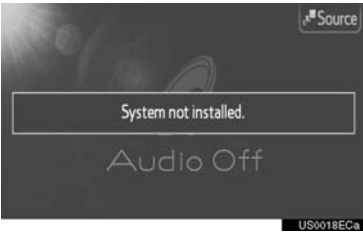

► Screen B



If screen A is displayed, the Display Audio system does not have navigation capabilities.

If screen B is displayed, the Display Audio system has navigation capabilities.

**COMMON ILLUSTRATIONS FOR ALL VEHICLE MODELS**

In this manual, illustrations showing the typical Display Audio system layout, USB port and rear view camera location, etc. has been used. The actual design and button position may differ depending on the vehicles. For the correct location of these items, please refer to Section 3 and the pictorial index of the “Owner’s Manual”.

**ENGINE SWITCH NAMES AND MODES**

This manual has been written using a vehicle with a gasoline engine vehicle (without a smart entry and start system) as an example. For vehicles with a smart entry and start system and hybrid vehicles, please refer to the following table to confirm the engine switch name and mode.

Vehicle system	Switch name and mode			
Vehicles without a smart key system	Engine switch	ACC	ON	OFF (LOCK)
Vehicles with a smart key system	“ENGINE START STOP” switch	ACCESSORY	IGNITION ON	OFF
Hybrid vehicles	“POWER” switch	ACCESSORY	ON	OFF

## SYMBOLS USED IN ILLUSTRATIONS



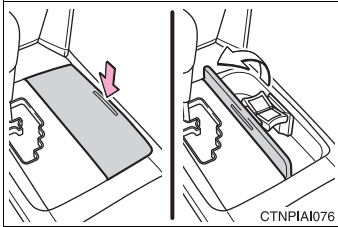

### Safety symbol

The symbol of a circle with a slash through it means “Do not”, “Do not do this”, or “Do not let this happen”.



### Arrows indicating operations

-  Indicates the action (pushing, turning, etc.) used to operate switches and other devices.
-  Indicates the outcome of an operation (e.g. a lid opens).

## HOW TO READ THIS MANUAL

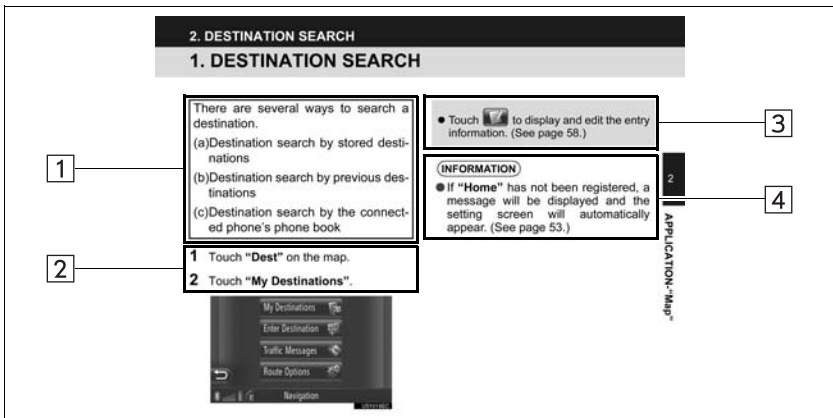

No.	Name	Description
1	Operational Outlines	An outline of the operation is explained.
2	Main Operations	The steps of an operation are explained.
3	Related Operations	A main operation's supplementary operations are described.
4	Information	Useful information for the user is described.

